

180001858

RECORD MERIDIAN
INST #070033149

PARCEL 3
N/F
PEBBLE BEACH PROPERTIES
INST. #130010563
PARCEL ID: 1240300003

PLAT OF
JACOB'S INDUSTRIAL CENTER PARCEL 1
A CONDOMINIUM
BEING LOCATED IN THE STONEHOUSE DISTRICT
OF JAMES CITY COUNTY, VIRGINIA

DATE: 12-06-2017 SHEET: 2 OF 5 JOB #14-102



3925 Midlands Road Williamsburg, VA 23188
Ph: (757) 565-1677 Fax: (757) 565-0782
web: landtechresources.com

I HEREBY CERTIFY THAT THIS PLAT IS ACCURATE AND THAT IT
COMPLIES WITH THE CODE OF VIRGINIA OF 1950, AS AMENDED,
§55-79.58, AND I FURTHER CERTIFY THAT ALL IMPROVEMENTS OR
PORTIONS THEREOF DEPICTED HEREON, PURSUANT TO THE CODE OF
VIRGINIA, §55-79.58(A), ARE SUBSTANTIALLY COMPLETE.

William S. Felts
WILLIAM S. FELTS LIC. #3149

12/06/2017
DATE

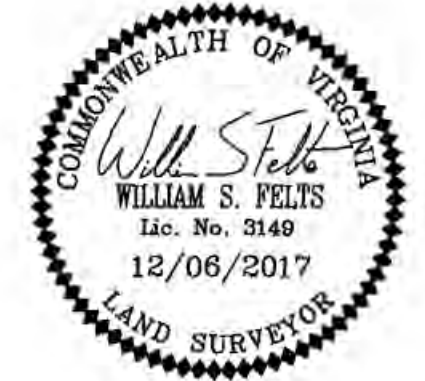

JCC Subdivision Agent *E66*
Approval Not Required

5 Large/Small Plat(s) Recorded
herewith as # 180001858

City of Williamsburg & County of James City
Circuit Court: This PLAT was recorded on
Jan 23 2018

at 12:49 AM/PM, PB PG
Document # 180001858
MONA A. FOLEY, CLERK
Mona A. Foley, Clerk

PARCELS A & B
N/F
OWENS-BROCKWAY GLASS CONTAINER, INC.
D.B. 492, PG. 352
PARCEL ID: 1240100015

