

180001768

BUILDING 23 (DUPLIX)

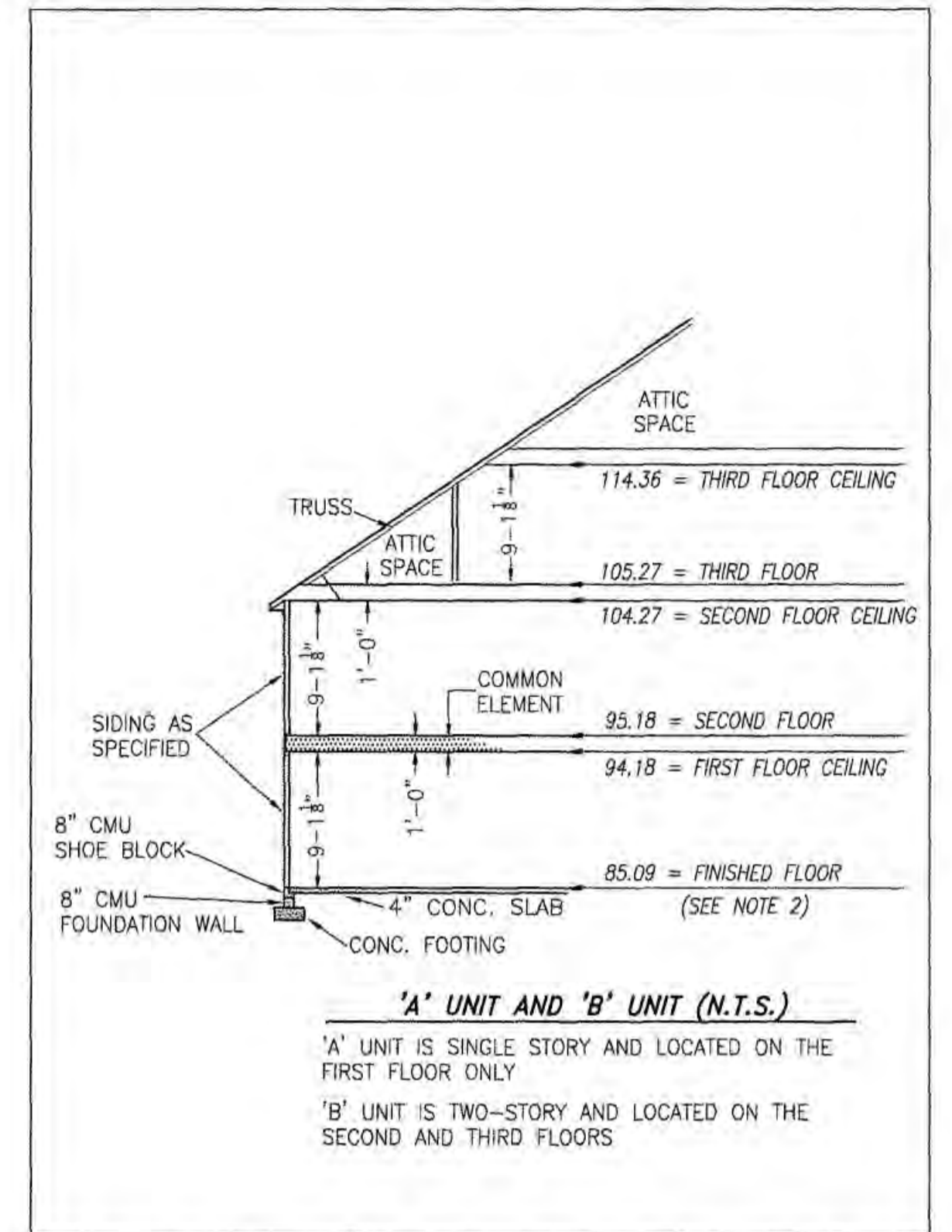
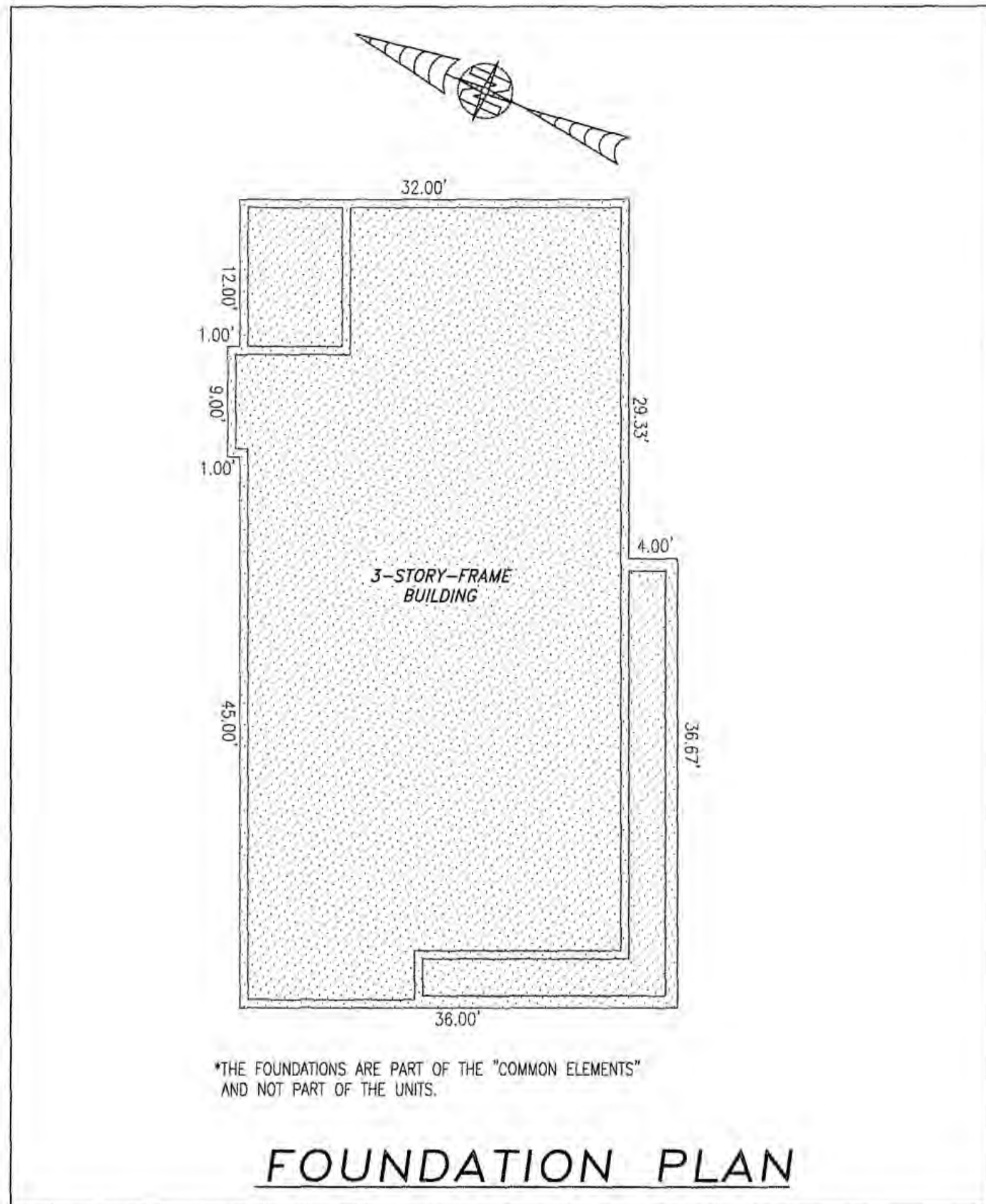

**TYPICAL BUILDING SECTION**  
NOT TO SCALE (N.T.S.)

- NOTES:
1. VERTICAL DATUM REFERENCE: NATIONAL GEODETIC VERTICAL DATUM OF 1929 (NGVD29).
  2. FINISHED FLOOR ELEVATION SHOWN WAS TAKEN FROM AS-BUILT SURVEY OF BUILDING #23 (DUPLIX) THE PROMENADE AT JOHN TYLER BY HAYDEN FRYE AND ASSOCIATES DATED: 12/18/2017.

I HEREBY CERTIFY THAT THIS PLAN IS ACCURATE AND THAT IT COMPLIES WITH THE PROVISIONS OF THE CODE OF VIRGINIA OF 1950 AS AMENDED, § 55-79.58 AND I FURTHER CERTIFY THAT ALL UNITS THEREOF DEPICTED HEREON, PURSUANT TO THE CODE OF VIRGINIA § 55-79.58B, ARE SUBSTANTIALLY COMPLETE.

5 Large/Small Plat(s) Recorded  
herewith as # 180001768

City of Williamsburg & County of James City  
Circuit Court: This PLAT was recorded on  
23 Jan 2018  
at 9:13 AM/PM; PB PG  
Document # 180001768  
MONA A. FOLEY, CLERK

*Mona A. Foley* Clerk  
*Jeanne Swafford* D.C.



JCC Subdivision Agent Approval Not Required *EGC*

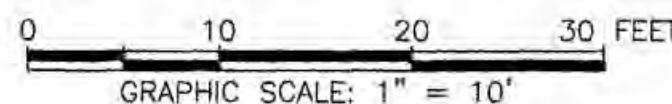

-INDICATES COMMON ELEMENT

THIS SHEET: FOUNDATION PLAN AND SECTION

**PHASE 23**  
**CONDOMINIUM PLAT AND PLAN**  
OF  
**THE PROMENADE**  
AT  
**JOHN TYLER**  
A CONDOMINIUM  
JAMES CITY COUNTY, VIRGINIA

Job# 160921



Hayden Frye and Associates, Inc.

**Land Surveyors**

333 KELLAM ROAD, SUITE 200  
VIRGINIA BEACH, VA, 23462  
PH: (757) 491-7228 FX:(757) 491-7229

DATE: JANUARY 9, 2018

SCALE: 1"=10'

SHEET 4 OF 5 THIS PHASE