

JOLLY POND ROAD  
STATE ROUTE #633  
(30' R/W)

0.7± OF A MILE  
TO THE CENTERLINE  
OF CENTERVILLE ROAD  
(STATE ROUTE #614)

CENTERLINE OF  
JOLLY POND ROAD

N80°58'59"E  
43.04'  
(N87°51'00"E  
43.04)

S89°14'01"E 166.70'  
(S82°22'00"E 166.70)

S89°14'01"E 209.74'  
(S82°22'00"E 209.74)

IRS IRS IRF

N/F  
ROBERT CANADAY AND  
MAVIS ELAINE CANADAY  
TAX PARCEL ID  
3030100013  
#3023 JOLLY POND RD.  
ZONED A1

JEROLENE BROWN  
TAX PARCEL  
ID 3030100015  
#3041 JOLLY POND RD.  
ZONED A1  
D.B. 77, PG. 316  
CASE # 05519-27A  
(REAL ESTATE  
AFFIDAVIT)

N/F  
TRACY PIERCE AND  
LISA VALENTINE PIERCE  
TAX PARCEL ID  
3030100016  
#3049 JOLLY POND RD.  
ZONED A1  
DOC# 040020506

PARCEL AREA  
96,606 S.F.  
2.22 AC.  
(2.13 AC.)

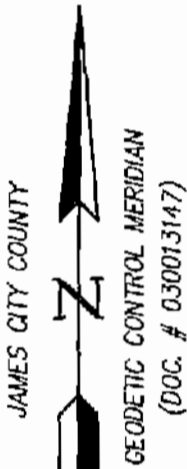

REFERENCES:

D.B.-97, PG. 332 (1957 SURVEY)  
DOC. # 030013147

GRAPHIC SCALE



SCALE: 1" = 100'

JCC Subdivision Agent  
Approval Not Required

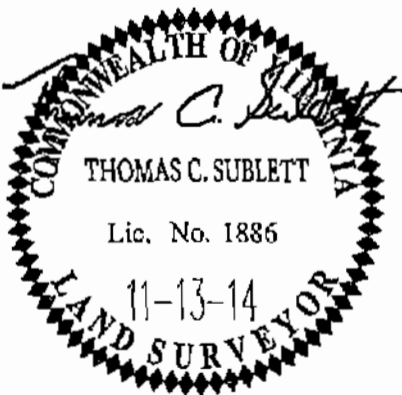

GENERAL NOTES:

- (1.) THIS PLAT IS BASED ON A CURRENT FIELD SURVEY, FOUND GROUND EVIDENCE AND OTHER AVAILABLE INFORMATION. THIS PLAT WAS PREPARED WITHOUT THE BENEFIT OF A CURRENT TITLE REPORT AND MAY BE SUBJECT TO EASEMENTS, RESTRICTIONS AND COVENANTS OF RECORD.
- (2.) IMPROVEMENTS TO THE PROPERTY ARE NOT SHOWN.
- (3.) RECORD INFORMATION IS SHOWN IN PARENTHESIS.

PLAT OF SURVEY  
PARCEL CONTAINING A  
TOTAL OF 2.22 ACRES±  
OWNED BY  
JEROLENE BROWN

Project Contacts: JFS/TCS      Scale: 1"=100'  
Project Number: 26118      Date: 11-13-14



5248 Olds Towne Road, Suite 1  
Williamsburg, Virginia 23168  
Phone: (757) 253-0040  
Fax: (757) 220-8994  
www.aesva.com