

THIS DRAWING IS THE PROPERTY OF BAY DESIGN GROUP, P.C. AND IS NOT TO BE REPRODUCED OR USED FOR ANY PROJECT IN WHOLE OR IN PART WITHOUT EXPRESS WRITTEN PERMISSION.

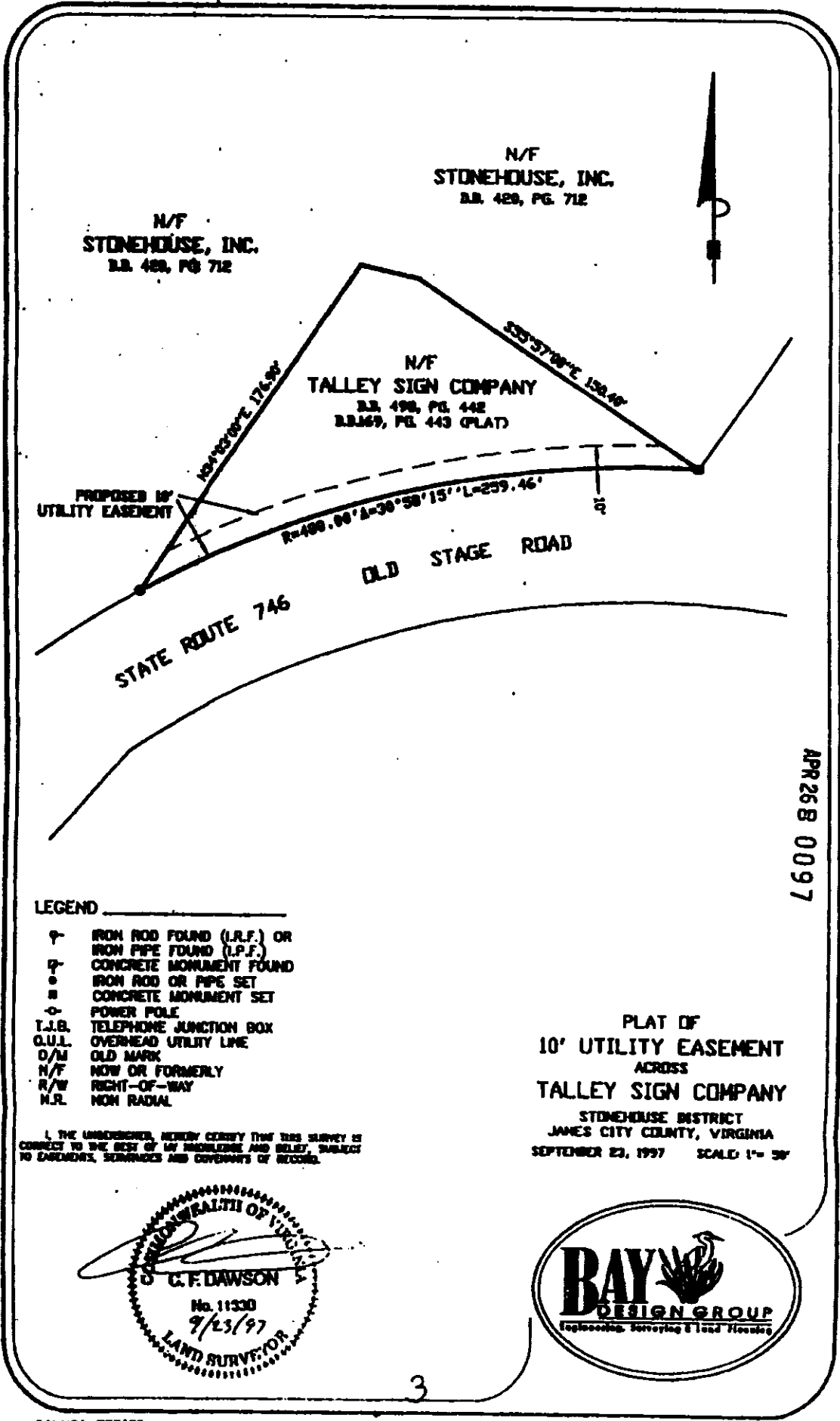

APR 26 8 00 97

LEGEND

- ⊕ IRON ROD FOUND (I.R.F.) OR IRON PIPE FOUND (I.P.F.)
- ⊙ CONCRETE MONUMENT FOUND
- ⊙ IRON ROD OR PIPE SET
- ⊙ CONCRETE MONUMENT SET
- ⊙ POWER POLE
- T.J.B. TELEPHONE JUNCTION BOX
- O.U.L. OVERHEAD UTILITY LINE
- O/M OLD MARK
- N/F NOW OR FORMERLY
- R/W RIGHT-OF-WAY
- N.R. NON RADIAL

PLAT OF
10' UTILITY EASEMENT
ACROSS
TALLEY SIGN COMPANY
 STONEHOUSE DISTRICT
 JAMES CITY COUNTY, VIRGINIA
 SEPTEMBER 23, 1997 SCALE: 1" = 30'

I, THE UNDERSIGNED, HEREBY CERTIFY THAT THIS SURVEY IS CORRECT TO THE BEST OF MY KNOWLEDGE AND BELIEF, SUBJECT TO EASEMENTS, SURVIVANCES AND CONVEYANCE OF RECORD.

