

NOT TO SCALE

N/E
COLONIAL HERITAGE LLC
499 JOLLY POND ROAD
WMSBURG, VA 23188-7326
Map # 2240100007

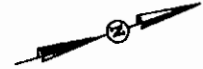

+/-500'

+/-2700'

15'

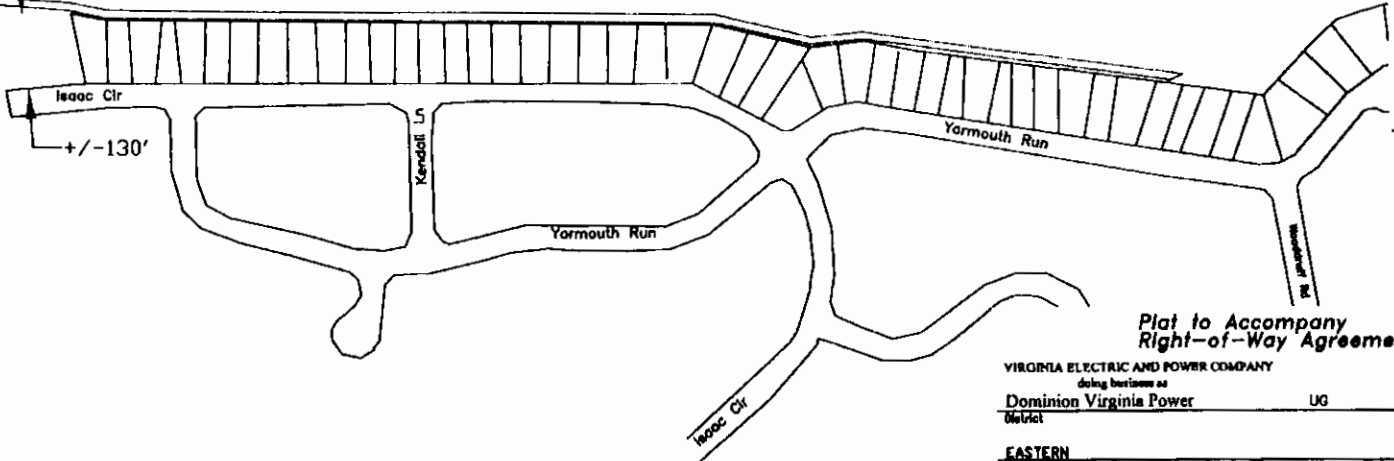

6

Note:
The location of the facilities
as installed determine the centerline
of the Right of Way herein granted
on the property of the owner.

OWNER INITIALS _____

**Plat to Accompany
Right-of-Way Agreement**

VIRGINIA ELECTRIC AND POWER COMPANY
doing business as
Dominion Virginia Power UG
District

EASTERN
District-Township-Borough County-City State

STONEHOUSE **JAMES CITY** **VIRGINIA**
Office Plot Number

WILLIAMSBURG **28-16-000E**
Estimate Number O&D Number

10020914 **M1740**
Date: 1/2016 By D WRIGHT

Legend
----- Location of Boundary Lines of Right of Way
15' in Width

NOT TO SCALE

N/F
COLONIAL HERITAGE LLC
499 JOLLY POND ROAD
WMSBURG, VA 23188-7326
Map # 2240100007

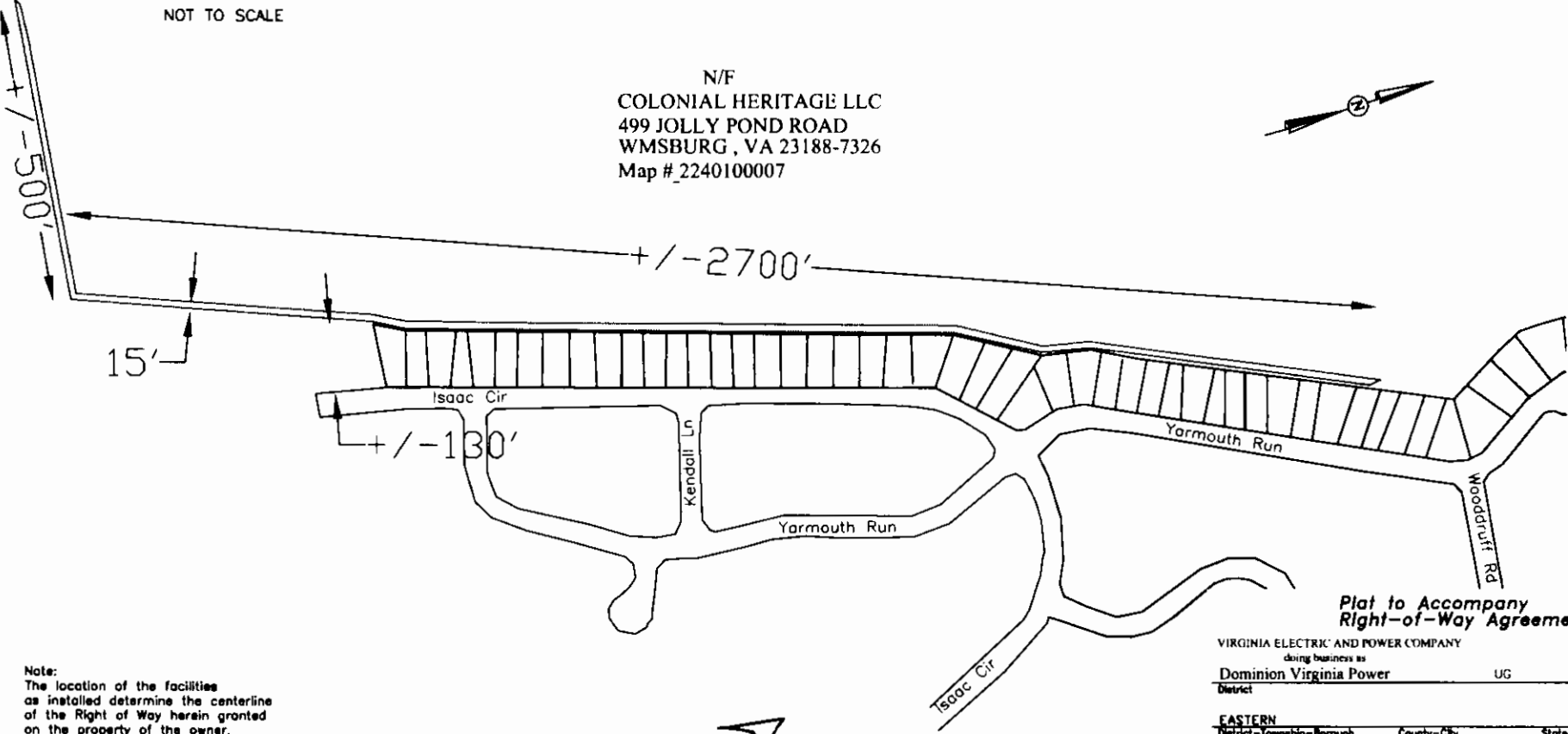

Note:
The location of the facilities
as installed determine the centerline
of the Right of Way herein granted
on the property of the owner.

OWNER INITIALS JB

**Plat to Accompany
Right-of-Way Agreement**

VIRGINIA ELECTRIC AND POWER COMPANY		
doing business as		
Dominion Virginia Power		UG
District		
EASTERN		
District-Township-Borough	County-City	State
STONEHOUSE	JAMES CITY	VIRGINIA
Office	Plot Number	
WILLIAMSBURG	28-16-0002	
Estimate Number	Grid Number	
10020914	M1740	
Date: 1/2018	By: D. WRIGHT	

Legend
----- Location of Boundary Lines of Right of Way
15' in Width

7

7