

# Colonial Heritage Phase V1 Sections 1&2

NOT TO SCALE

N/F  
 COLONIAL HERITAGE LLC  
 499 JOLLY POND ROAD  
 WILMINGTON, VA 23188-7326  
 Map J 2240100007

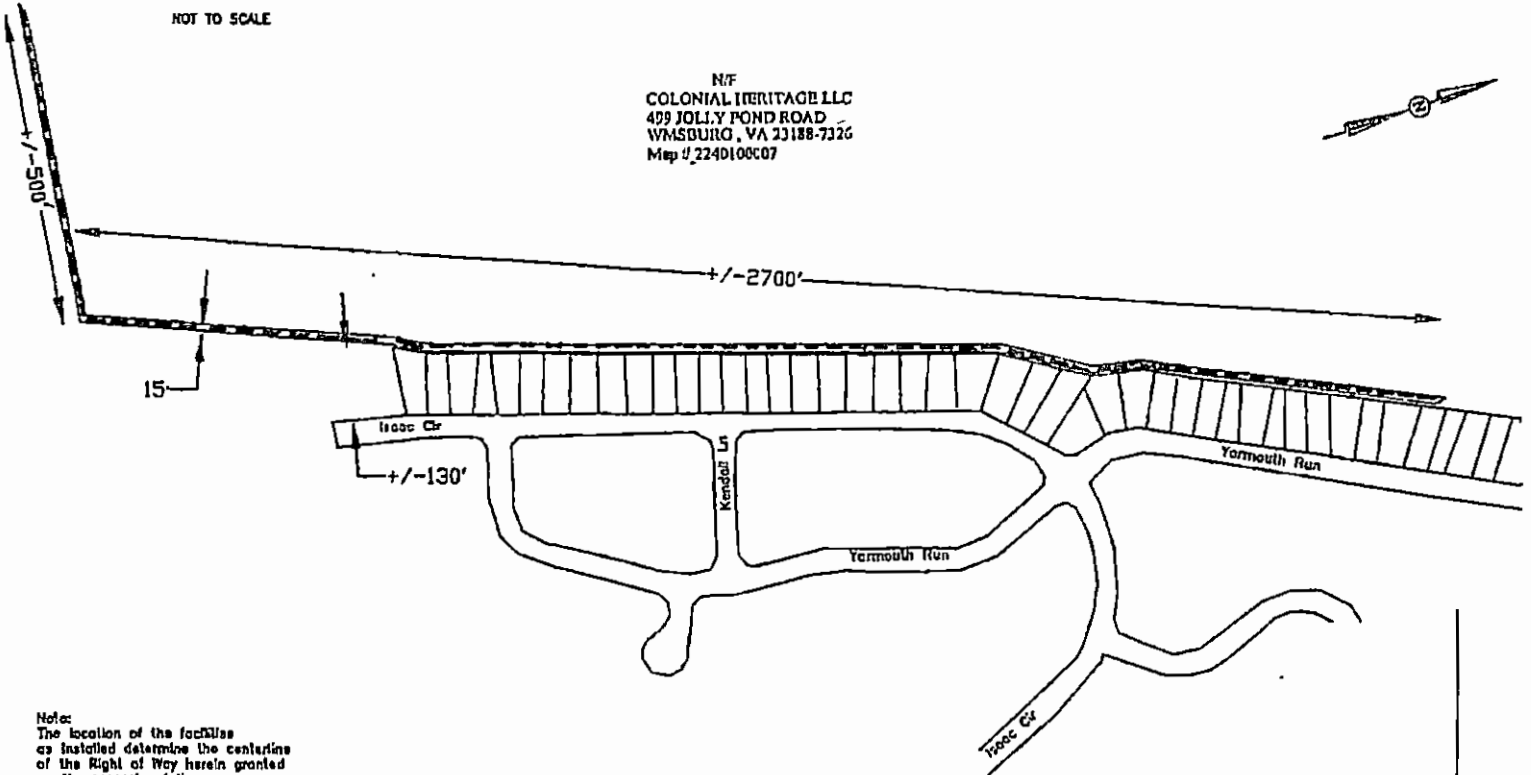
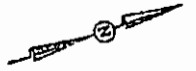

OWNER INITIALS \_\_\_\_\_

rd  
 ----- Location of Boundary Lines of Right of Way  
 15' in Width

VERIZON VIRGINIA INC. RIGHT-OF-WAY PLAT	OWNER: <b>Colonial Heritage LLC</b> 499 Jolly Pond Rd Williamsburg Va. 23188	CITY/COUNTY: <b>James City Co.</b>									
----- <sup>r</sup> 15' VERIZON EASEMENT WHICH OVERLAYS THE 15' DOMINION POWER EASEMENT	CONTACT TEL. NO.: <b>757-748-3969</b>	TAX MAP&PARCEL ID:2240100007									
ENGINEERING ASSISTANT : <b>FRED PLEASANTS</b>	GRANTOR'S NAME:	MAGISTERIAL DISTRICT: STONEHOUSE									
PHONE NO.: (757) 875-2506	2 <sup>ND</sup> GRANTOR:	GRID	<table border="1" style="width: 100%; border-collapse: collapse;"> <tr> <td style="width: 15%;">SH</td> <td style="width: 15%;">E-W</td> <td style="width: 15%;">N-S</td> <td style="width: 55%;">SH. <u>4</u></td> </tr> <tr> <td>8452</td> <td>D</td> <td>7</td> <td>OF <u>4</u></td> </tr> </table>	SH	E-W	N-S	SH. <u>4</u>	8452	D	7	OF <u>4</u>
SH	E-W	N-S	SH. <u>4</u>								
8452	D	7	OF <u>4</u>								
CENTRAL OFFICE : Williamsburg BC-339772-R RWO# 4A0CH8A	PLAT NO. <b>F3548</b>										