

CURVE TABLE						
CURVE #	DELTA	RADIUS	LENGTH	TANGENT	CHORD	CHORD BEARING
C2	17°33'31"	175.00'	53.63'	27.03'	53.42'	S60°20'37"W
C3	7°20'24"	225.00'	28.82'	14.43'	28.80'	S65°27'10"W
C4	20°59'47"	229.50'	84.10'	42.53'	83.63'	S42°59'47"W
C5	27°20'16"	120.50'	57.49'	29.31'	56.95'	S65°01'32"W
C6	5°05'49"	179.50'	15.97'	7.99'	15.96'	S76°08'45"W
C7	22°01'59"	179.50'	69.03'	34.95'	68.60'	S62°34'51"W
C8	15°24'27"	279.50'	75.16'	37.81'	74.93'	S43°51'38"W
C9	17°36'15"	170.50'	52.39'	26.40'	52.18'	S44°57'32"W
C10	20°53'16"	229.40'	83.63'	42.28'	83.17'	S43°19'01"W
C11	29°23'15"	170.50'	87.45'	44.71'	86.50'	S47°34'01"W
C12	74°27'55"	120.50'	156.61'	91.57'	145.82'	N80°30'24"W
C13	21°35'28"	170.50'	64.25'	32.51'	63.87'	S52°34'35"E
C14	78°20'19"	17.50'	23.93'	14.26'	22.11'	S24°12'10"E
C15	76°59'58"	17.50'	23.52'	13.92'	21.79'	N54°48'40"E
C16	31°03'00"	170.50'	92.40'	47.36'	91.27'	N77°47'09"E
C17	29°23'15"	220.50'	113.10'	57.82'	111.86'	N47°34'01"E
C18	20°53'16"	179.40'	65.40'	33.07'	65.04'	N43°19'01"E
C19	17°36'15"	220.50'	67.75'	34.14'	67.48'	N44°57'32"E
C20	15°24'27"	229.50'	61.72'	31.05'	61.53'	N43°51'38"E
C21	6°29'16"	279.50'	31.65'	15.84'	31.63'	S48°19'14"W
C22	8°55'11"	279.50'	43.51'	21.80'	43.47'	S40°37'00"W
C23	9°22'41"	170.50'	27.91'	13.98'	27.88'	S40°50'45"W
C24	8°13'34"	170.50'	24.48'	12.26'	24.46'	S49°38'53"W
C25	10°29'26"	229.40'	42.00'	21.06'	41.94'	S48°30'57"W
C26	10°23'50"	229.40'	41.63'	20.87'	41.57'	S38°04'18"W

CURVE TABLE						
CURVE #	DELTA	RADIUS	LENGTH	TANGENT	CHORD	CHORD BEARING
C27	10°16'00"	170.50'	30.55'	15.32'	30.51'	S38°00'23"W
C28	19°07'16"	170.50'	56.90'	28.72'	56.64'	S52°42'01"W
C29	6°32'48"	120.50'	13.77'	6.89'	13.76'	S65°32'02"W
C30	67°55'07"	120.50'	142.84'	81.15'	134.62'	N77°14'00"W
C31	8°34'57"	170.50'	25.54'	12.79'	25.52'	N89°01'10"E
C32	20°59'01"	170.50'	62.44'	31.57'	62.09'	N74°14'11"E
C33	1°29'02"	170.50'	4.42'	2.21'	4.42'	N63°00'10"E
C34	17°08'10"	220.50'	65.95'	33.22'	65.70'	N53°41'34"E
C35	12°15'06"	220.50'	47.15'	23.67'	47.06'	N38°59'56"E
C36	7°58'50"	179.40'	24.99'	12.51'	24.97'	N36°51'48"E
C37	12°54'27"	179.40'	40.41'	20.29'	40.33'	N47°18'26"E
C38	6°47'26"	220.50'	26.13'	13.08'	26.12'	N50°21'56"E
C39	10°48'49"	220.50'	41.62'	20.87'	41.55'	N41°33'49"E
C40	7°26'07"	229.50'	29.78'	14.91'	29.76'	N39°52'28"E
C41	36°13'05"	185.50'	117.26'	60.66'	115.32'	S31°17'01"E
C42	7°58'20"	229.50'	31.93'	15.99'	31.91'	N47°34'41"E

LINE TABLE		
LINE	BEARING	LENGTH
L2	N14°58'00"E	7.54'
L3	S75°02'00"E	27.89'
L4	S75°02'00"E	12.91'
L5	S75°02'00"E	40.80'
L6	S16°18'41"W	7.95'

City of Williamsburg & County of James City
 Circuit Court: This PLAT was recorded on
 2-19-2016
 at 1:47 AM/PM, PB PG
 Document # 160003088
 MONA A. FOLEY, CLERK
 _____, Clerk

10 Large/Small Plat(s) Recorded
 herewith as # 160003088

Rev.	Date	Description	Revised By
2	5/07/15	REVISED PER COUNTY COMMENTS	JFS
1	1/14/15	REVISED PER COUNTY COMMENTS	JFS

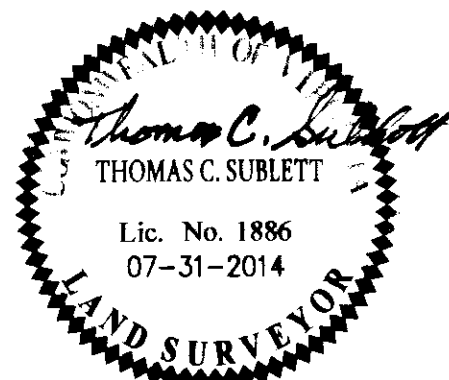

PLAT OF BOUNDARY LINE EXTINGUISHMENT, ADJUSTMENT AND
 SUBDIVISION OF LOTS 10 - 19, 21 - 33, 6015 RICHMOND ROAD
 AND RIGHT-OF-WAY DEDICATION
 PHASE 2 OF
FOREST HEIGHTS NEIGHBORHOOD
 PREPARED FOR:
 JAMES CITY COUNTY HOUSING & COMMUNITY DEVELOPMENT
 POWHATAN DISTRICT JAMES CITY COUNTY VIRGINIA

Project Contacts:	TCS/JFS
Project Number:	W10119-E-03
Scale:	NOTED
Date:	07-31-2014
Sheet Number	9 of 10