

150022789

**NOTE:**  
BUILDING DIMENSIONS AND ELEVATIONS SHOWN ARE BASED  
ARCHITECTURAL PLANS PREPARED BY TOANO DESIGN, INC.  
DIMENSIONS SHOWN ARE TO THE BUILDING FRAMING LINE.

**SURVEYORS CERTIFICATE**

I HEREBY CERTIFY THAT TO THE BEST OF MY KNOWLEDGE OR BELIEF,  
THIS PLAN IS ACCURATE AND COMPLIES WITH THE PROVISIONS OF  
SECTION 55-79.58 (B) OF THE CODE OF VIRGINIA 1950 AS  
AMENDED AND THAT ALL UNITS DEPICTED HEREON HAVE BEEN  
SUBSTANTIALLY COMPLETED.

*Will Steltz*  
STATE CERTIFIED LAND SURVEYOR

09/03/2015  
DATE

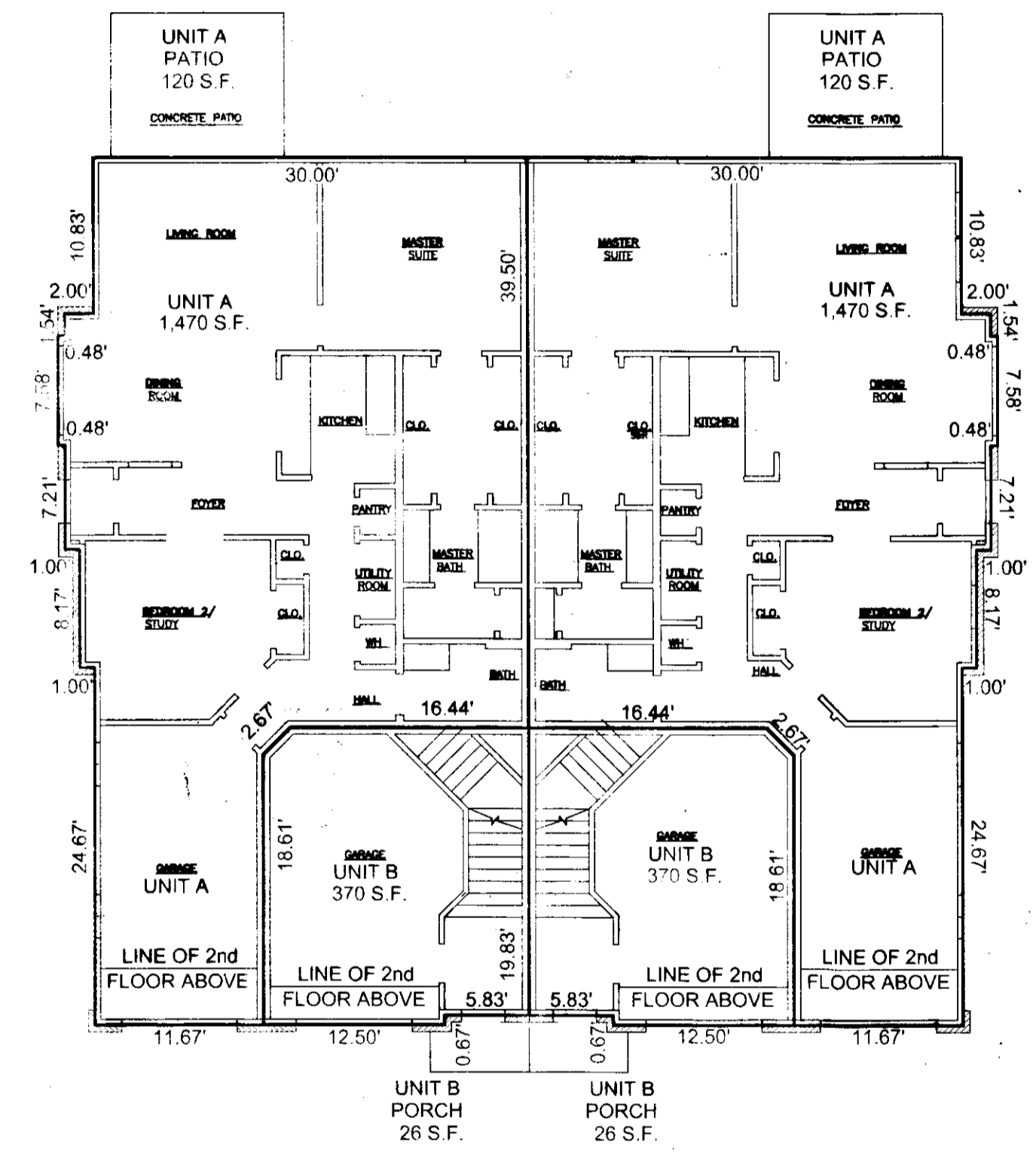
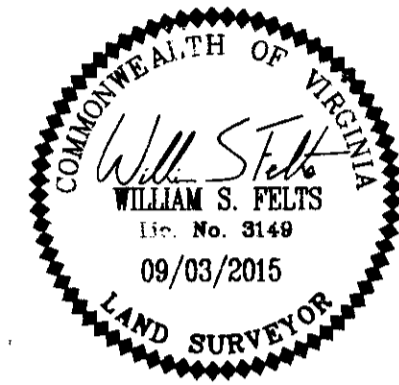

FIRST FLOOR LAYOUT

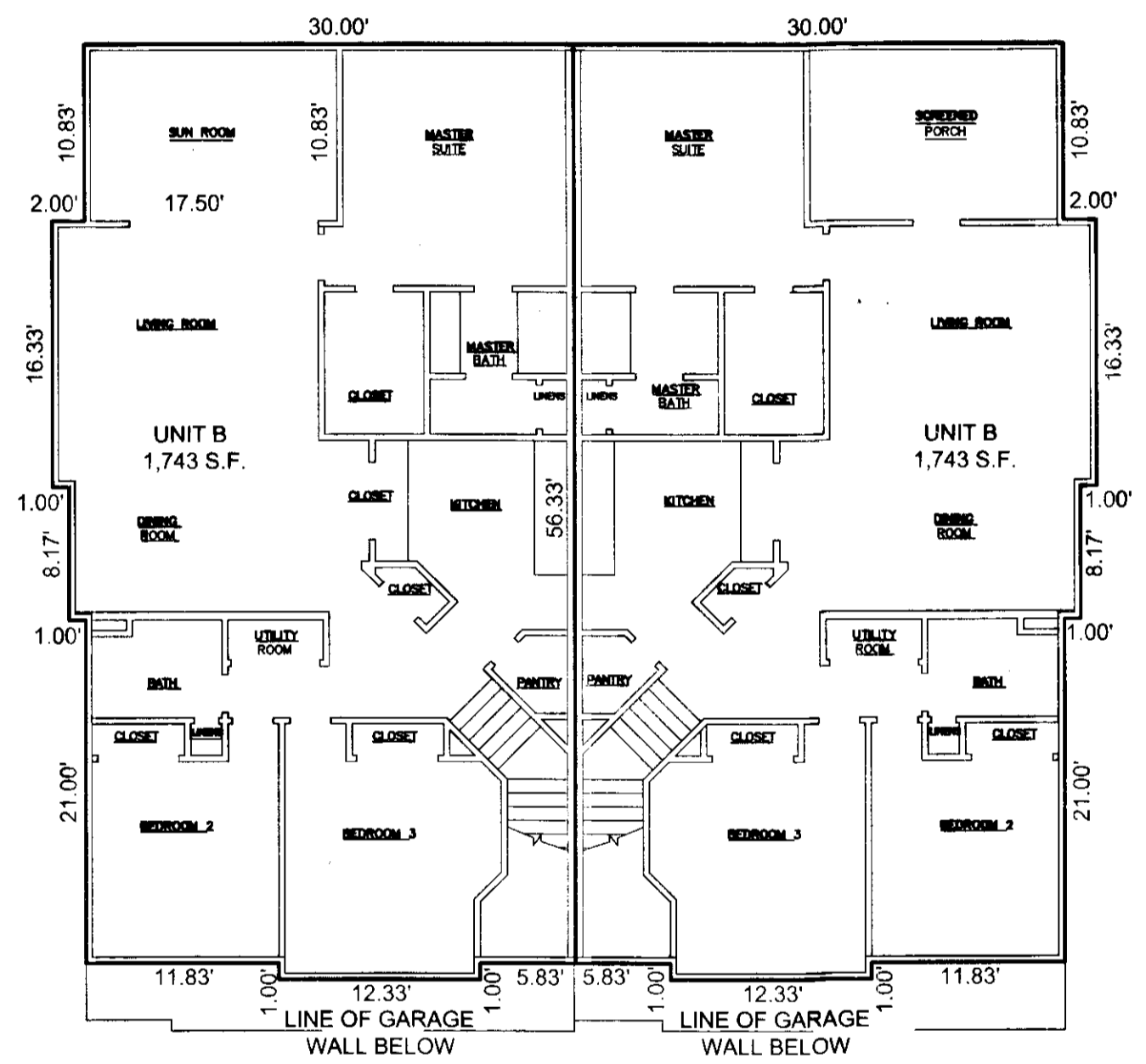

SECOND FLOOR LAYOUT

**PLAN OF  
4 UNIT BUILDING  
BRAEMAR CREEK  
AT GREENSPRINGS PLANTATION  
A CONDOMINIUM**  
LOCATED IN THE BERKELEY DISTRICT  
JAMES CITY COUNTY, VIRGINIA

DATE: 09/03/15 SCALE: 1" = 10' JOB# 05-548-10  
SHEET: 3 OF 4

**LandTech**  
Resources, Inc.  
Surveying - Engineering - GPS  
3925 Midlands Road, Williamsburg, VA 23188  
Phone: (757) 565-1677 Fax: (757) 565-0782  
web: landtechresources.com

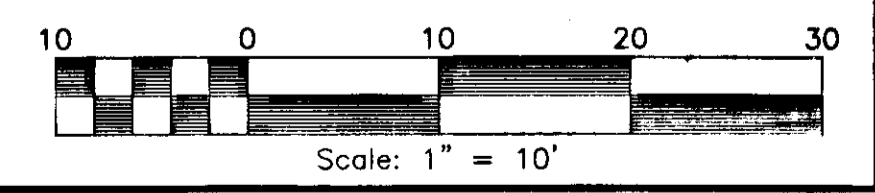

4 Large/Small Plat(s) Recorded  
herewith as # 150022789

City of Williamsburg & County of James City  
Circuit Court: This PLAT was recorded on  
12-1-2015  
at 8:43 AM/PM; PG - PG -  
Document # 150022789  
BETSY B. WOOLRIDGE, CLERK  
*Rebecca Coleman*, Dep. Clerk