

1. THIS IS TO CERTIFY THAT I, ON OCTOBER 3, 2014, SURVEYED THE PROPERTY SHOWN ON THIS PLAT. THIS SURVEY WAS PERFORMED WITHOUT THE BENEFIT OF A TITLE REPORT. THE ONLY EASEMENTS APPEARING ON THIS SURVEY ARE THOSE WHICH WERE SHOWN ON THE RECORDED SUBDIVISION PLAT UNLESS OTHERWISE NOTED.
2. THIS PROPERTY APPEARS TO FALL IN FLOOD ZONE(S) X AS SHOWN ON THE N.F.I.P. MAP FOR THE JAMES CITY COUNTY, MAP/PANEL 51095C-0120C, DATED 9-28-07. BASE FLOOD ELEV = N/A FINISHED FLOOR ELEV = N/A

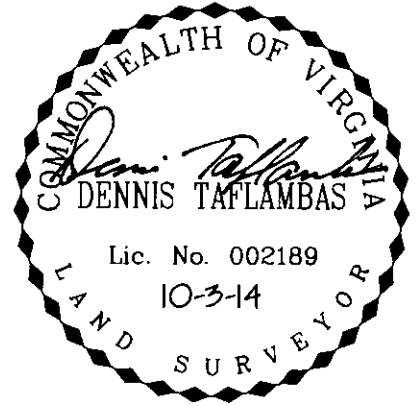

**WESTRAY DOWNS
SECTION 1**
(M.B. 43, P. 33)

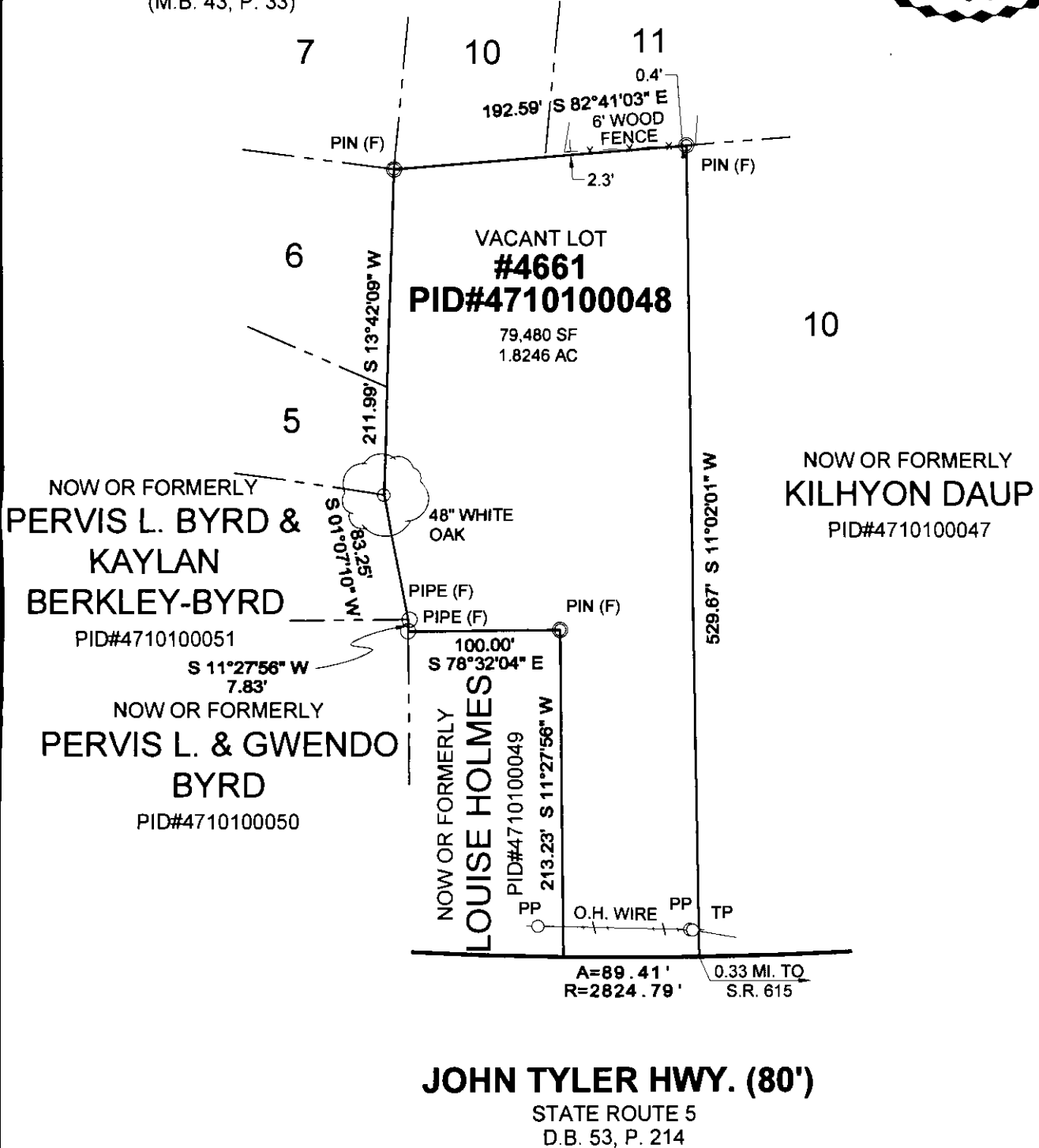

DKT Associates
LAND SURVEYORS

1100 GRANBY STREET
SUITE 100
NORFOLK, VIRGINIA 23510
(757) 588-5888 FAX: (757) 588-5880

PHYSICAL SURVEY OF			
A 1.8246 ACRE PARCEL OF LAND LOCATED AT 4661 JOHN TYLER HWY.			
WILLIAMSBURG, VIRGINIA D.B. 283, P. 238			
FOR: SHERMAN PRESSEY			
DRAWN	MJB	SCALE	1" = 100'
CHECK	JSO	JOB	8396
DATE	10-03-14	REVISED	-
FIELD BOOK	123	SHEET	1 OF 1