

City of Williamsburg & County of James City
 Circuit Court: This PLAT was recorded on
 11-20-2014
 at 4:12 AM/PM: PB PG
 Document # 14009166
 BETSY B. WOOLRIDGE, CLERK
 Dep. Clerk

6 Large Small Plat(s) Recorded
 herewith as # 14009166

Rev.	Date	Description	Revised By

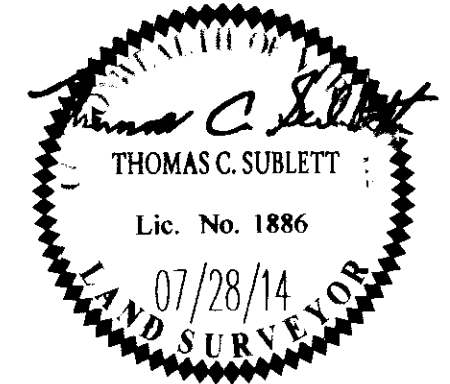

AES
 CONSULTING ENGINEERS

5248 Old Towne Road, Suite 1
 Williamsburg, Virginia 23188
 Phone: (757) 253-0040
 Fax: (757) 220-8994
 www.aesva.com

Hampton Roads | Central Virginia | Middle Peninsula

PLAT OF SUBDIVISION
THE SETTLEMENT AT POWHATAN CREEK
 PHASE III-A
 LOTS 196-206, 232-236, 249-264, 272-278
 AND COMMON AREA 6A & 7

BERKELEY DISTRICT JAMES CITY COUNTY VIRGINIA

Project Contacts: TCB
 Project Number: 0254-11A
 Scale: 1"=60'
 Date: 07/02/14
 Sheet Number
2 of 6