

LOT CURVE TABLE						
CURVE #	DELTA	RADIUS	LENGTH	TANGENT	CHORD	CHORD BEARING
C1	57°01'15"	35.00'	34.83'	19.01'	33.41'	S55°21'07"W
C2	29°04'03"	35.00'	17.76'	9.07'	17.57'	S12°18'28"W
C3	6°32'00"	300.15'	34.23'	17.13'	34.21'	N1°02'27"E
C4	12°47'08"	300.15'	66.98'	33.63'	66.84'	N10°42'01"E
C5	1°52'27"	300.15'	9.82'	4.91'	9.82'	N18°01'49"E
C6	9°28'51"	165.00'	27.30'	13.68'	27.27'	N23°42'28"E
C7	12°43'27"	165.00'	36.64'	18.40'	36.57'	N34°48'37"E
C8	12°41'53"	165.00'	36.57'	18.36'	36.49'	N47°31'17"E
C9	12°41'53"	165.00'	36.57'	18.36'	36.49'	N60°13'09"E
C10	13°47'14"	165.00'	39.70'	19.95'	39.61'	N73°27'42"E
C11	4°20'24"	165.00'	12.50'	6.25'	12.50'	N82°31'31"E
C12	0°20'02"	470.00'	2.74'	1.37'	2.74'	N5°28'17"W
C13	10°06'46"	470.00'	82.96'	41.59'	82.85'	N10°41'41"W
C14	9°59'55"	470.00'	82.02'	41.11'	81.91'	N20°45'02"W
C15	4°52'48"	470.00'	40.03'	20.03'	40.02'	N28°11'23"W
C16	27°02'11"	35.00'	16.52'	8.41'	16.36'	S40°30'47"E

LOT CURVE TABLE						
CURVE #	DELTA	RADIUS	LENGTH	TANGENT	CHORD	CHORD BEARING
C17	51°58'57"	35.00'	31.75'	17.06'	30.68'	S80°01'21"E
C18	17°10'17"	245.00'	73.43'	36.99'	73.15'	N76°06'35"E
C19	46°42'25"	35.00'	28.53'	15.11'	27.75'	S54°43'02"W
C20	44°50'05"	35.00'	27.39'	14.44'	26.69'	S8°56'47"W
C21	19°02'22"	115.00'	38.21'	19.29'	38.04'	N75°10'32"E
C22	46°41'19"	115.00'	93.71'	49.63'	91.14'	N42°18'42"E
C23	58°07'04"	35.00'	35.50'	19.45'	34.00'	S24°34'58"E
C24	1°55'39"	885.00'	29.77'	14.89'	29.77'	N72°10'19"E
C25	2°41'50"	885.00'	41.66'	20.84'	41.66'	N74°29'04"E
C26	2°40'40"	885.00'	41.36'	20.68'	41.36'	N77°10'19"E
C27	2°39'51"	885.00'	41.15'	20.58'	41.15'	N79°50'34"E
C28	2°39'24"	885.00'	41.03'	20.52'	41.03'	N82°30'11"E
C29	0°51'50"	885.00'	13.34'	6.67'	13.34'	N84°15'48"E
C30	13°29'14"	885.00'	208.32'	104.65'	207.84'	N77°57'07"E
C31	55°09'00"	35.00'	33.69'	18.28'	32.40'	S81°13'00"E
C32	15°37'28"	455.00'	124.08'	62.43'	123.69'	N87°58'29"E

LOT CURVE TABLE						
CURVE #	DELTA	RADIUS	LENGTH	TANGENT	CHORD	CHORD BEARING
RW33	12°34'15"	470.00'	103.12'	51.77'	102.91'	N89°51'08"W
RW34	86°05'18"	35.00'	52.59'	32.69'	47.78'	S40°49'06"W
RW35	14°39'35"	300.15'	76.80'	38.61'	76.59'	N11°38'15"E
RW36	65°43'41"	165.00'	189.28'	106.60'	179.07'	N51°49'53"E
RW37	90°00'00"	35.00'	54.98'	35.00'	49.50'	S39°41'43"W
RW38	11°34'58"	520.00'	105.12'	52.74'	104.94'	N0°29'12"E
RW39	11°34'58"	470.00'	95.01'	47.67'	94.85'	N0°29'12"E
RW40	25°19'30"	470.00'	207.74'	105.60'	206.06'	N17°58'02"W
RW41	3°38'05"	520.00'	32.99'	16.50'	32.98'	N28°48'44"W
RW42	79°01'08"	35.00'	48.27'	28.86'	44.53'	S66°30'16"E
RW43	10°42'33"	230.00'	42.99'	21.56'	42.93'	S79°20'27"W
RW44	6°37'29"	170.00'	19.66'	9.84'	19.64'	S81°22'59"W
RW45	91°32'30"	35.00'	55.92'	35.95'	50.16'	S32°17'59"W
RW46	6°07'42"	520.00'	55.62'	27.84'	55.59'	N10°24'25"W
RW47	87°57'43"	35.00'	53.73'	33.78'	48.61'	S51°19'25"E
RW48	65°43'41"	115.00'	131.92'	74.29'	124.81'	N51°49'53"E
RW49	14°29'29"	250.15'	63.27'	31.80'	63.10'	N11°43'18"E
RW50	113°16'04"	35.00'	69.19'	53.15'	58.46'	S52°09'28"E
RW51	13°29'14"	870.00'	204.79'	102.87'	204.32'	N77°57'07"E

7 Large/Small Plat(s) Recorded
herewith as # 140013168

City of Williamsburg & County of James City Circuit Court: This PLAT was recorded on		
at <u>1:50 PM</u> <u>8-19-2014</u> PG		
Document # <u>140013168</u>		
BETSY B. WOOLRIDGE, CLERK		
<u>Robin Lane</u> , Dep. Clerk		
1	08/17/14	RMS
Rev	Date	Revised By

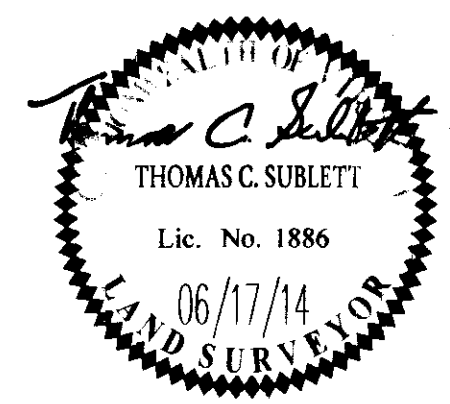

NES
CONSULTING ENGINEERS
Hampton Roads | Central Virginia | Middle Peninsula

614 Moorefield Park Drive
Richmond, Virginia 23236-3655
Phone: (804) 330-8040
Fax: (804) 330-9840
www.aesva.com

PLAT OF SUBDIVISION
LOTS 107 - 162
**COLONIAL HERITAGE
PHASE V - SECTION 1C**
OWNER / DEVELOPER: COLONIAL HERITAGE, L.L.C.
STONEHOUSE DISTRICT | JAMES CITY COUNTY | VIRGINIA

Project Contacts:	TRS/TCS
Project Number:	8881-51C
Scale:	Date:
1"=50'	05/01/14
Sheet Number	
7 OF 7	