

7 Large (Small) Plats Recorded herewith as # 140013168

City of Williamsburg & County of James City Circuit Court: This PLAT was recorded on 0-19-2014 at 1:50 AM/PM, PB PG - Document # 140013168 BETSY B. WOOLRIDGE, CLERK Dep. Clerk		RMS Revised By
1	06/17/14	
Rev.	Date	

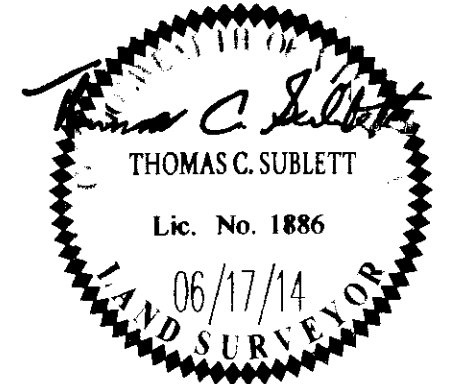

NES
CONSULTING ENGINEERS
614 Moorefield Park Drive
Richmond, Virginia 23236-3655
Phone: (804) 330-8040
Fax: (804) 330-9840
www.aesva.com
Hampton Roads | Central Virginia | Middle Peninsula

PLAT OF SUBDIVISION
LOTS 107 - 162
**COLONIAL HERITAGE
PHASE V - SECTION 1C**
OWNER / DEVELOPER: COLONIAL HERITAGE, L.L.C.
STONEHOUSE DISTRICT JAMES CITY COUNTY VIRGINIA

Project Contacts:	TRS/TCB
Project Number:	8881-51C
Scale:	Date:
1"=100'	05/01/14
Sheet Number	
3 OF 7	