

NOTE: INDIVIDUAL LOTS MARKED (TA) ARE "TRANSITIONAL AREA" LOTS AND ARE SUBJECT TO ADDITIONAL COVENANTS, CONDITIONS, AND RESTRICTIONS AS DEFINED IN THE "DECLARATION OF COVENANTS, CONDITIONS, AND RESTRICTIONS OF WINDSOR RIDGE."

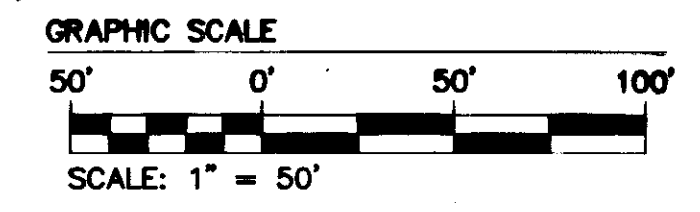
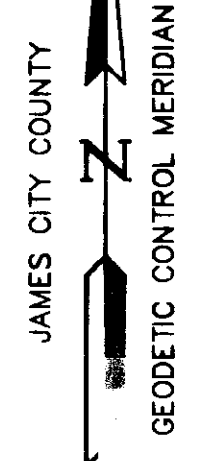

LEGEND:

- DENOTES 25% OR GREATER SLOPES ON SLOPE BUFFER LOTS (REFER TO DEED OF BUFFER EASEMENTS DOC. #120005628)
- AREA OF NATURAL OPEN SPACE DEDICATED TO JAMES CITY COUNTY (191,075 SF ± OR 4.39 AC ±)

SEE SHEET 5 FOR CURVE DATA

THIS SHEET ADDRESSES LOTS 8-14 & 30-34

2	2/10/14			
1	6/11/13	REVISED PER ENGINEERING RESOURCE PROFESSIONAL COMMENTS	JFS	
Rev.	Date	Description	Revised By	

City of Williamsburg & County of James City
Circuit Court: This PLAT was recorded on
2-27-2014
at 1:54 PM, PG
Document # **140003171**
BETSY B. WOOLRIDGE, CLERK
Betsy Woolridge, Dep. Clerk

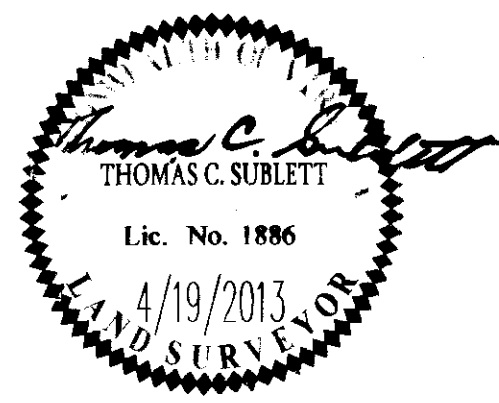

NEES
CONSULTING ENGINEERS
Hampton Roads | Central Virginia | Middle Peninsula

5 Large Small Plat(s) Recorded
herewith as # **140003171**

5248 Old Towne Road, Suite 1
Williamsburg, Virginia 23188
Phone: (757) 263-0040
Fax: (757) 220-8994
www.neesa.com

PLAT OF SUBDIVISION
WINDSOR RIDGE SECTION 2A
LOTS 1-37 (37 LOTS)
BEING THE PROPERTY OF
BOCA LAND INVESTORS, L.L.C.

STONEHOUSE DISTRICT JAMES CITY COUNTY VIRGINIA

Project Contacts: TCS
Project Number: 8223-13
Scale: 1" = 50' Date: 4/19/13
Sheet Number
3 OF 5