

City of Williamsburg & County of James City Circuit Court: This PLAT was recorded on 2 October, 2013			
at 12:53 PM , PG. —			
Document # 130022751			
BETSY B. WOOLRIDGE, CLERK			
<i>Robert D. Mann</i> , Dep. Clerk			
2	9/3/13	REVISED AS PER COMMENT LETTERS	JCA
1	7/11/13	REVISED AS PER COMMENT LETTERS	JCA
Rev	Date	Description	Revised

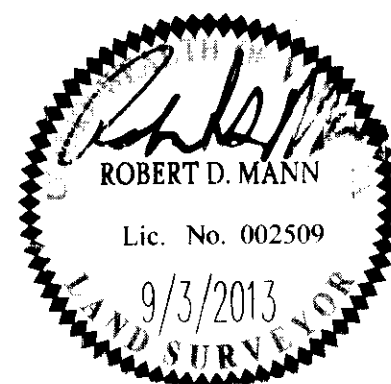

10 Large/Small Plat(s) Recorded
herewith as # **130022751**

MAES
CONSULTING ENGINEERS

1317 Executive Blvd, Suite 150
Chesapeake, Virginia 23320
Phone: (757) 410-7436

www.aesva.com

Hampton Roads | Central Virginia | Middle Peninsula

COMPOSITE PLAT OF SUBDIVISION
PARCEL R-2
KINGSMILL RESORT
PROPERTY OF
XANTERRA KINGSMILL, LLC

ROBERTS DISTRICT COUNTY OF JAMES CITY VIRGINIA

Project Contacts	RDM
Project Number	775346
Scale	Date
1"=100'	01/29/13
Sheet Number	
3	