

City of Williamsburg & County of James City Circuit Court. This PLAT was recorded on 2 October, 2013 at 12:53 AM/PM, PG. --- Document # 130022751 BETSY B. WOOLRIDGE, CLERK <i>Patricia Morales</i> , Dep. Clerk		
2	9/3/13 REVISED AS PER COMMENT LETTERS	
1	7/11/13 REVISED AS PER COMMENT LETTERS	
Rev	Date	Revised
		JCA

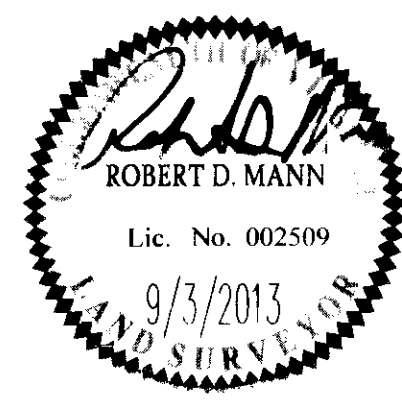

10 Large (Small) Plat(s) Recorded
herewith as # **130022751**

AES
CONSULTING ENGINEERS

1317 Executive Blvd Suite 150
Chesapeake, Virginia 23320
Phone: (757) 410-7436
www.aesva.com

Hampton Roads | Central Virginia | Middle Peninsula

COMPOSITE PLAT OF SUBDIVISION
PARCEL R-2
KINGSMILL RESORT
PROPERTY OF
XANTERRA KINGSMILL, LLC

ROBERTS DISTRICT COUNTY OF JAMES CITY VIRGINIA

Project Contacts:	RJM
Project Number:	775341
Scale:	1"=100'
Date:	01/29/13
Sheet Number:	2