

City of Williamsburg & County of James City Circuit Court: This PLAT was recorded on <u>June 13, 2013</u> at <u>11:09</u> AM/PM, PB <u>PG</u> Document # <u>130014475</u> BETSY B. WOOLRIDGE, CLERK <u>Betsy Woolridge</u> , Dep. Clerk			
Rev	Date	Description	Revised

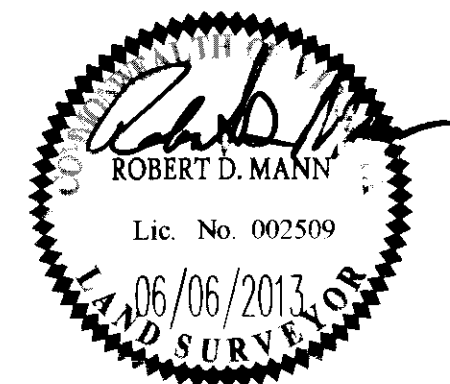

RES
 CONSULTING ENGINEERS
 1317 Executive Blvd, Suite 150
 Chesapeake, Virginia 23320
 Phone: (757) 410-7436
 www.aesva.com
 Hampton Roads | Central Virginia | Middle Peninsula
 3
 Date Received
 130014475

BOUNDARY SURVEY
 COUNTRY ROAD EAST PARCEL
 PROPERTY OF
BUSCH PROPERTIES, INC.
 ROBERTS DISTRICT COUNTY OF JAMES CITY VIRGINIA

Project Contacts:	RDM
Project Number:	H10047
Scale:	1"=100'
Date:	06/06/2013
Sheet Number:	8