

13001475

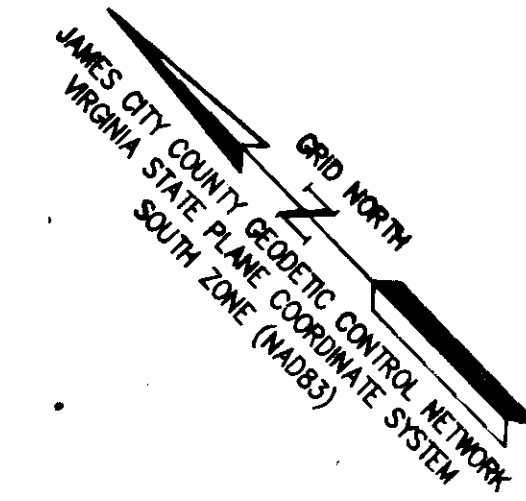

CURVE TABLE						
CURVE #	DELTA	RADIUS	LENGTH	TANGENT	CHORD	CHORD BEARING
C1	72°17'54"	750.00'	946.38'	547.90'	884.83'	S36°08'43"E
C2	50°44'30"	1000.00'	885.61'	474.21'	856.95'	S25°22'01"E
C3	15°54'04"	2647.96'	734.87'	369.81'	732.52'	S58°41'18"E
C19	19°09'12"	1430.00'	478.03'	241.27'	475.81'	N17°47'10"W
C20	63°04'42"	600.00'	660.56'	368.25'	627.70'	N4°10'35"E

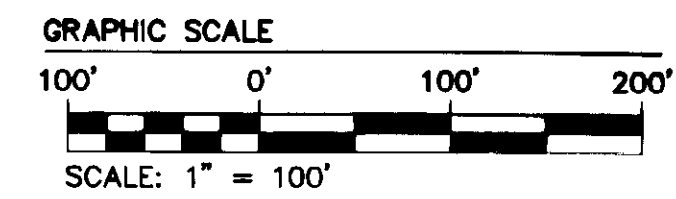

PARCEL D-1  
XANTERRA KINGSMILL, LLC  
INSTR. # 100017762  
BUSCH CORPORATE CENTER  
P.B. 60, PG. 50  
INSTR. # 090013121  
PARCEL ID # 5020100078  
ZONED M1

N OR F  
ANHEUSER BUSCH, INC.  
"PARCEL D-2,  
BUSCH CORPORATE CENTER"  
PARCEL ID # 5130100003  
D.B. 715, PG. 598

POINT OF BEGINNING  
N: 3616443.5982  
E: 12018274.6106

50' COLONIAL PIPELINE EASEMENT  
(CORR. P.B. 28, PG. 19-20)  
(D.B. 129, PG. 696)

100' RPA BUFFER LINE (TYP.)  
(SEE GENERAL NOTES #9 & 10)

30' HRSD EASEMENT  
(D.B. 132, PG. 125)

SOUTHALL ROAD PARCEL  
XANTERRA KINGSMILL, LLC  
PARCEL ID # 5040100005

SOUTHALL ROAD  
(50' PRIVATE R/W)  
P.B. 32, PG. 28  
P.B. 31, PG. 58

LPZ TRACT A1  
WHITTAKER'S MILL

LPZ TRACT A2  
WHITTAKER'S MILL

KINGSMILL ROAD  
(PRIVATE R/W)  
PARCEL R-15  
INSTRUMENT # 100014988

LPZ TRACT 9-2  
BRAY WOOD  
PARCEL 1  
BRAY WOOD

LPZ TRACT 9-3  
BRAY WOOD  
PARCEL 34  
BRAY WOOD

COUNTRY ROAD EAST PARCEL  
PARCEL 5-B  
"CARTER'S GROVE COUNTRY ROAD"  
INSTRUMENT # 060029609  
INSTRUMENT # 100014376  
INSTRUMENT # 120010877  
PARCEL ID # 5130100002  
6,214,614 S.F.  
142.668 AC.

PARCEL R-9A  
72,533 S.F.  
1.665 ACRES

Rev	Date	Description	Revised

City of Williamsburg & County of James City  
Circuit Court: This PLAT was recorded on  
June 13, 2013  
at 11:09 AM/PM, PB    PG     
Document # 13001475  
BETSY B. WOOLRIDGE, CLERK  
Robert D. Mann, Dep. Clerk

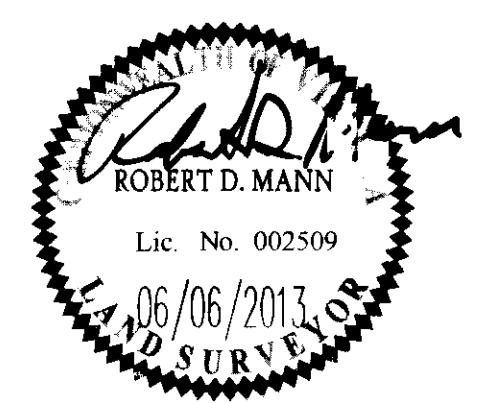

**NES**  
CONSULTING ENGINEERS  
Hampton Roads | Central Virginia | Middle Peninsula  
1317 Executive Blvd, Suite 150  
Chesapeake, Virginia 23320  
Phone: (757) 410-7436  
www.aesva.com  
Plat # 13001475

BOUNDARY SURVEY  
COUNTRY ROAD EAST PARCEL  
PROPERTY OF  
**BUSCH PROPERTIES, INC.**  
ROBERTS DISTRICT    COUNTY OF JAMES CITY    VIRGINIA

Project Contacts: RDM  
Project Number: H10047  
Scale: 1"=100'    Date: 06/06/2013  
Sheet Number  
**3**