

130012312

PROPERTY DESCRIPTION PHASE 16
SUBMITTED LAND

ALL THAT CERTAIN LOT, PIECE OR PARCEL OF LAND SITUATE, LYING AND BEING IN THE STONEHOUSE DISTRICT OF JAMES CITY COUNTY, VIRGINIA BEING A PORTION OF TAX PARCEL (12-2)(1-21) AND BEING MORE PARTICULARLY DESCRIBED AS: COMMENCING AT A POINT, SAID POINT BEING A CORNER TO EXISTING PHASE 1 WEATHERLY AT WHITEHALL AND ADDITIONAL LAND 2 WEATHERLY AT WHITEHALL AND LYING ON THE SOUTHWESTERLY RIGHT OF WAY OF OLD STAGE ROAD (STATE ROUTE #746) (P.O.C. #1); THENCE LEAVING THE RIGHT OF WAY OF OLD STAGE ROAD AND ALONG THE LINE OF PHASE 1 S33°02'40"W, A DISTANCE OF 388.47' TO A POINT; THENCE S29°01'18"W, A DISTANCE OF 80.00' TO A POINT; THENCE N60°58'42"W, A DISTANCE OF 21.56' TO A POINT BEING THE POINT OF CURVE OF A NON TANGENT CURVE TO THE RIGHT HAVING A RADIUS OF 76.39', A DELTA ANGLE OF 106°11'52", A LENGTH OF 141.59', A CHORD DISTANCE OF 122.18' AND A CHORD BEARING OF S29°01'18"W TO A POINT BEING A CORNER OF PHASE 1 WEATHERLY AT WHITEHALL AND PHASE 12 WEATHERLY AT WHITEHALL; THENCE LEAVING PHASE 1 WEATHERLY AT WHITEHALL AND ALONG THE LINE OF PHASE 12 WEATHERLY AT WHITEHALL S60°58'42"E, A DISTANCE OF 30.94' TO A POINT BEING A CORNER TO PHASE 15 WEATHERLY AT WHITEHALL LYING ON THE LINE OF PHASE 12 WEATHERLY AT WHITEHALL AND BEING THE POINT OF BEGINNING FOR THIS PARCEL; THENCE LEAVING PHASE 15 WEATHERLY AT WHITEHALL AND ALONG THE LINE OF PHASE 12 WEATHERLY AT WHITEHALL S60°58'42"E, A DISTANCE OF 99.00' TO A POINT BEING A CORNER TO THIS PARCEL, ADDITIONAL LAND 2 WEATHERLY AT WHITEHALL AND LYING ON THE LINE OF PHASE 12 WEATHERLY AT WHITEHALL; THENCE LEAVING PHASE 12 WEATHERLY AT WHITEHALL AND ALONG THE LINE OF ADDITIONAL LAND 2 WEATHERLY AT WHITEHALL S29°01'18"W, A DISTANCE OF 80.00' TO A POINT; THENCE N60°58'42"W, A DISTANCE OF 99.00' TO A POINT BEING A CORNER TO THIS PARCEL, ADDITIONAL LAND 2 WEATHERLY AT WHITEHALL AND PHASE 15 WEATHERLY AT WHITEHALL; THENCE LEAVING ADDITIONAL LAND 2 WEATHERLY AT WHITEHALL AND ALONG THE LINE OF PHASE 15 WEATHERLY AT WHITEHALL N29°01'18"E, A DISTANCE OF 80.00' TO A POINT BEING THE POINT OF BEGINNING CONTAINING 7,920 SQUARE FEET OR 0.182 ACRES, MORE OR LESS.

PROPERTY DESCRIPTION ADDITIONAL LAND #2

ALL THAT CERTAIN LOT, PIECE OR PARCEL OF LAND SITUATE, LYING AND BEING IN THE STONEHOUSE DISTRICT OF JAMES CITY COUNTY, VIRGINIA BEING A PORTION OF TAX PARCEL (12-2)(1-21) AND BEING MORE PARTICULARLY DESCRIBED AS: BEGINNING AT A POINT (P.O.B. #2), SAID POINT BEING A CORNER TO THIS PARCEL ON THE SOUTHERLY RIGHT OF WAY OF OLD STAGE ROAD (STATE ROUTE #746) AND BEING A CORNER TO PROPERTY NOW OR FORMERLY STANDING IN THE NAME OF BERTRAND E. GEDDY, JR.; THENCE ALONG A SURVEY TIE LINE (PROPERTY LINE MEANDERS ALONG THE CENTERLINE OF A STREAM) S16°43'03"W, A DISTANCE OF 267.15' TO AN IRON ROD FOUND; THENCE S40°16'34"W, A DISTANCE OF 227.79' TO AN IRON ROD FOUND; THENCE S10°05'24"W, A DISTANCE OF 133.04' TO A POINT IN THE CENTERLINE OF THE STREAM; THENCE LEAVING THE SURVEY TIE LINE AND CENTERLINE STREAM, S65°59'11"W, A DISTANCE OF 215.10' TO A 17" POPLAR TREE FOUND; THENCE N89°19'03"W, A DISTANCE OF 252.61' TO AN IRON ROD SET; THENCE S58°08'47"W, A DISTANCE OF 237.23' TO AN IRON ROD SET BEING A CORNER TO THIS PARCEL, BERTRAND E. GEDDY, JR. AND PROPERTY NOW OR FORMERLY STANDING IN THE NAME OF MARTHA W. WARE, TRUSTEE OF THE MARTHA W. WARE, TRUST; THENCE LEAVING BERTRAND E. GEDDY, JR. AND ALONG THE LINE OF MARTHA W. WARE, N42°55'26"W, A DISTANCE OF 460.78' TO A CONCRETE MONUMENT FOUND; THENCE LEAVING MARTHA W. WARE, N65°39'32"E, A DISTANCE OF 113.28' TO A POINT; THENCE S65°11'14"E, A DISTANCE OF 10.36' TO A POINT; THENCE S20°11'13"E, A DISTANCE OF 82.50' TO A POINT; THENCE N69°48'47"E, A DISTANCE OF 393.65' TO A POINT; THENCE S60°58'42"E, A DISTANCE OF 107.89' TO A POINT; THENCE N29°01'18"E, A DISTANCE OF 80.00' TO A POINT; THENCE S60°58'42"E, A DISTANCE OF 205.39' TO A POINT; THENCE N29°01'18"E, A DISTANCE OF 122.18' TO A POINT; THENCE N60°58'42"W, A DISTANCE OF 102.58' TO A POINT; THENCE N29°01'18"E, A DISTANCE OF 80.00' TO A POINT; THENCE N60°58'42"W, A DISTANCE OF 211.20' TO A POINT; THENCE N33°02'40"E, A DISTANCE OF 368.47' TO A POINT ON THE SOUTHERLY RIGHT OF WAY OF OLD STAGE ROAD; THENCE ALONG SAID RIGHT OF WAY S56°57'06"E, A DISTANCE OF 336.43' TO A POINT; THENCE S51°14'27"E, A DISTANCE OF 90.98' TO A POINT, BEING THE POINT OF BEGINNING AND CONTAINING 444,343 SQUARE FEET OR 10.201 ACRES (AREA CALCULATED TO CENTER OF STREAM), MORE OR LESS.

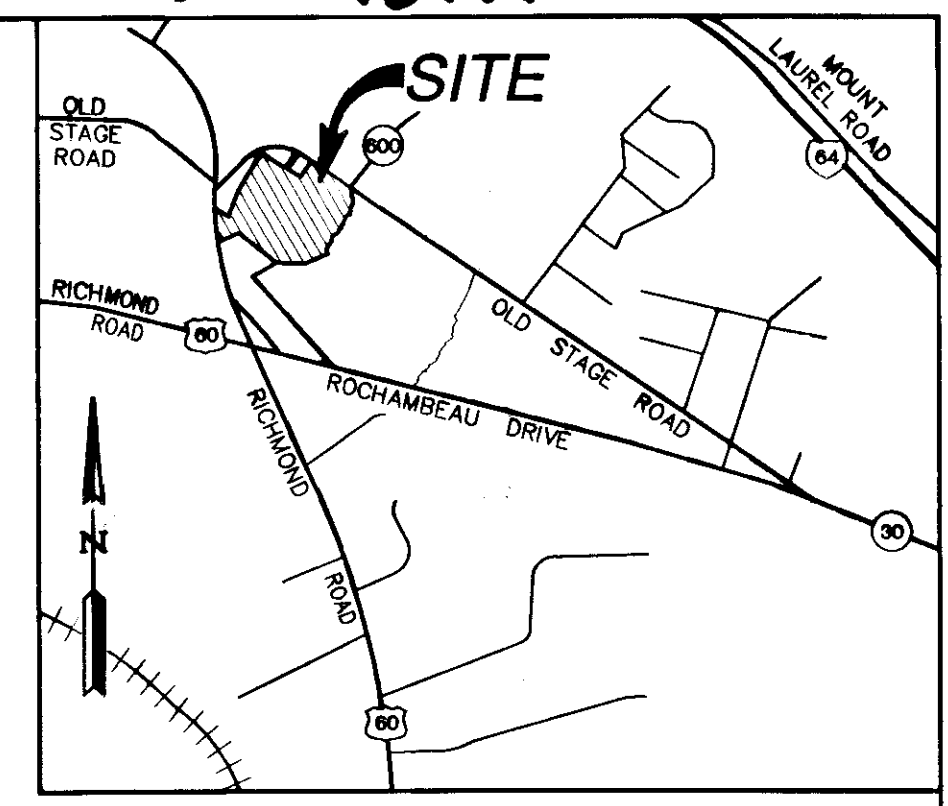

VICINITY MAP
SCALE 1"=2,000'

GENERAL NOTES

1. SITE IS ZONED R-2 CLUSTER (GENERAL RESIDENTIAL WITH PROFFERS)
2. SITE CURRENTLY SERVED BY PUBLIC WATER & SEWER OWNED BY THE JAMES CITY COUNTY SERVICE AUTHORITY, J.C.S.A.
3. THE PROPERTY AS SHOWN IS ALL OF TAX PARCEL (12-2)(1-21). PROPERTY ADDRESS: 3225 OLDE STAGE ROAD
OWNER: RAUCH DEVELOPMENT CO., LLC.
4. THE SUBJECT PARCEL LIES IN AN AREA DESIGNATED AS FLOOD INSURANCE RATE MAP (FIRM) ZONE "X", AREA DETERMINED TO BE OUTSIDE THE 0.2% ANNUAL CHANCE FLOOD PLAIN, ACCORDING TO JAMES CITY COUNTY, VA COMMUNITY PANEL NUMBER 510201-0045-C, DATED SEPTEMBER 28, 2007
5. PROPERTY REF.: INSTRUMENT #070019486 AND #090010659

3 Large/Small Plat(s) Recorded
herewith as # 130012312

SURVEYOR'S CERTIFICATE

THE UNDERSIGNED SURVEYOR HEREBY CERTIFIES THAT HE HAS READ SECTION 55-79.58(A) OF THE CODE OF VIRGINIA AND FINDS THESE PLATS TO BE ACCURATE AND IN COMPLIANCE WITH THE CODE. HE FURTHER CERTIFIES THAT ALL IMPROVEMENTS DEPICTED HEREON HAVE BEEN SUBSTANTIALLY COMPLETED.

Thomas C. Sublett 05/02/13
THOMAS C. SUBLETT LICENSE NO. 1886 DATE

STATE OF VIRGINIA
CITY OF WILLIAMSBURG & COUNTY OF JAMES CITY CIRCUIT COURT, THIS 11th DAY OF May, 2013,
THE PLAT SHOWN HEREON WAS PRESENTED AND ADMITTED TO THE RECORD AS THE LAW DIRECTS. @ 10:31 AM/PM
INSTRUMENT # 130012312

TESTE: BETSY B. WOOLRIDGE, CLERK
By: Patrick W. Faulkner, Deputy Clerk

Rev	Date	Description	Revised By

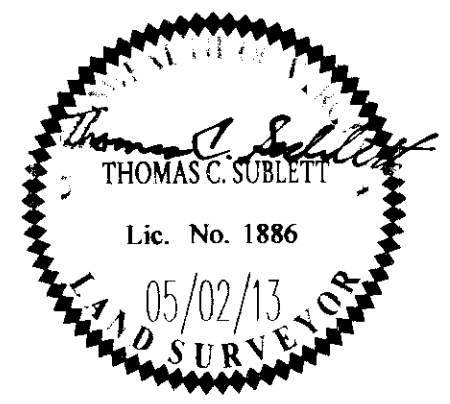

AES
CONSULTING ENGINEERS
5248 Olde Towne Road, Suite 1
Williamsburg, Virginia 23188
Phone: (757) 253-0040
Fax: (757) 220-8994
www.aesva.com
Hampton Roads | Central Virginia | Middle Peninsula

PLAT OF CONDOMINIUM
WEATHERLY AT WHITEHALL
PHASE 16
STONEHOUSE DISTRICT JAMES CITY COUNTY VIRGINIA

Project Contacts: JFS
Project Number: 9048-09
Scale: AS SHOWN Date: 05/02/13
Sheet Number
1 OF 3