

130009630

PROPERTY DESCRIPTION PHASE 15  
SUBMITTED LAND

ALL THAT CERTAIN LOT, PIECE OR PARCEL OF LAND SITUATE, LYING AND BEING IN THE STONEHOUSE DISTRICT OF JAMES CITY COUNTY, VIRGINIA BEING A PORTION OF TAX PARCEL (12-2)(1-21) AND BEING MORE PARTICULARLY DESCRIBED AS: COMMENCING AT A POINT, SAID POINT BEING A CORNER TO EXISTING PHASE 1 WEATHERLY AT WHITEHALL AND ADDITIONAL LAND 2 WEATHERLY AT WHITEHALL AND LYING ON THE SOUTHWESTERLY RIGHT OF WAY OF OLD STAGE ROAD (STATE ROUTE #746) (P.O.C. #1); THENCE LEAVING THE RIGHT OF WAY OF OLD STAGE ROAD AND ALONG THE LINE OF PHASE 1 S33°02'40"W, A DISTANCE OF 388.47' TO A POINT; THENCE S29°01'18"W, A DISTANCE OF 80.00' TO A POINT; THENCE N60°58'42"W, A DISTANCE OF 21.56' TO A POINT BEING THE POINT OF CURVE OF A NON TANGENT CURVE TO THE RIGHT HAVING A RADIUS OF 76.39', A DELTA ANGLE OF 106°11'52", A LENGTH OF 141.59', A CHORD DISTANCE OF 122.18' AND A CHORD BEARING OF S29°01'18"W TO A POINT BEING THE POINT OF BEGINNING FOR THIS PARCEL AND A CORNER OF PHASE 1 WEATHERLY AT WHITEHALL AND PHASE 12 WEATHERLY AT WHITEHALL; THENCE LEAVING PHASE 1 WEATHERLY AT WHITEHALL AND ALONG THE LINE OF PHASE 12 WEATHERLY AT WHITEHALL S60°58'42"E, A DISTANCE OF 30.94' TO A POINT LYING ON THE LINE OF PHASE 12 WEATHERLY AT WHITEHALL AND BEING A CORNER TO THIS PARCEL AND ADDITIONAL LAND 2 WEATHERLY AT WHITEHALL; THENCE LEAVING PHASE 12 WEATHERLY AT WHITEHALL AND ALONG THE LINE OF PHASE 14 WEATHERLY AT WHITEHALL N20°11'13"W, A DISTANCE OF 82.50' TO A POINT LYING ON THE LINE OF PHASE 1 WEATHERLY AT WHITEHALL AND BEING A CORNER TO THIS PARCEL AND PHASE 14 WEATHERLY AT WHITEHALL; THENCE LEAVING PHASE 14 WEATHERLY AT WHITEHALL AND ALONG THE LINE OF PHASE 1 WEATHERLY AT WHITEHALL N69°48'47"E, A DISTANCE OF 98.85' TO A POINT; THENCE S20°11'13"E, A DISTANCE OF 9.22' TO A POINT BEING THE POINT OF CURVE OF A NON TANGENT CURVE TO THE LEFT HAVING A RADIUS OF 76.39', A DELTA ANGLE OF 10°43'08", A LENGTH OF 14.29', A CHORD DISTANCE OF 14.27' AND A CHORD BEARING OF N87°28'48"E TO A POINT BEING THE POINT OF BEGINNING CONTAINING 9,121 SQUARE FEET OR 0.209 ACRES, MORE OR LESS.

PROPERTY DESCRIPTION ADDITIONAL LAND #2

ALL THAT CERTAIN LOT, PIECE OR PARCEL OF LAND SITUATE, LYING AND BEING IN THE STONEHOUSE DISTRICT OF JAMES CITY COUNTY, VIRGINIA BEING A PORTION OF TAX PARCEL (12-2)(1-21) AND BEING MORE PARTICULARLY DESCRIBED AS: BEGINNING AT A POINT (P.O.B. #2), SAID POINT BEING A CORNER TO THIS PARCEL ON THE SOUTHERLY RIGHT OF WAY OF OLD STAGE ROAD (STATE ROUTE #746) AND BEING A CORNER TO PROPERTY NOW OR FORMERLY STANDING IN THE NAME OF BERTRAND E. GEDDY, JR.; THENCE ALONG A SURVEY TIE LINE (PROPERTY LINE MEANDERS ALONG THE CENTERLINE OF A STREAM) S16°43'03"W, A DISTANCE OF 267.15' TO AN IRON ROD FOUND; THENCE S40°16'34"W, A DISTANCE OF 227.79' TO AN IRON ROD FOUND; THENCE S10°05'24"W, A DISTANCE OF 133.04' TO A POINT IN THE CENTERLINE OF THE STREAM; THENCE LEAVING THE SURVEY TIE LINE AND CENTERLINE STREAM, S65°59'11"W, A DISTANCE OF 215.10' TO A 17" POPLAR TREE FOUND; THENCE N89°19'03"W, A DISTANCE OF 252.61' TO AN IRON ROD SET; THENCE S58°08'47"W, A DISTANCE OF 237.23' TO AN IRON ROD SET BEING A CORNER TO THIS PARCEL, BERTRAND E. GEDDY, JR. AND PROPERTY NOW OR FORMERLY STANDING IN THE NAME OF MARTHA W. WARE, TRUSTEE OF THE MARTHA W. WARE, TRUST; THENCE LEAVING BERTRAND E. GEDDY, JR., AND ALONG THE LINE OF MARTHA W. WARE, N42°55'26"W, A DISTANCE OF 460.78' TO A CONCRETE MONUMENT FOUND; THENCE LEAVING MARTHA W. WARE, N65°39'32"E, A DISTANCE OF 113.28' TO A POINT; THENCE S65°11'14"E, A DISTANCE OF 10.36' TO A POINT; THENCE S20°11'13"E, A DISTANCE OF 82.50' TO A POINT; THENCE N69°48'47"E, A DISTANCE OF 393.65' TO A POINT; THENCE S60°58'42"E, A DISTANCE OF 8.89' TO A POINT; THENCE N29°01'18"E, A DISTANCE OF 80.00' TO A POINT; THENCE S60°58'42"E, A DISTANCE OF 304.39' TO A POINT; THENCE N29°01'18"E, A DISTANCE OF 122.18' TO A POINT; THENCE N60°58'42"W, A DISTANCE OF 102.58' TO A POINT; THENCE N29°01'18"E, A DISTANCE OF 80.00' TO A POINT; THENCE N60°58'42"W, A DISTANCE OF 211.20' TO A POINT; THENCE N33°02'40"E, A DISTANCE OF 388.47' TO A POINT ON THE SOUTHERLY RIGHT OF WAY OF OLD STAGE ROAD; THENCE ALONG SAID RIGHT OF WAY S56°57'06"E, A DISTANCE OF 336.43' TO A POINT; THENCE S51°14'27"E, A DISTANCE OF 90.98' TO A POINT, BEING THE POINT OF BEGINNING AND CONTAINING 452,263 SQUARE FEET OR 10.383 ACRES (AREA CALCULATED TO CENTER OF STREAM), MORE OR LESS.

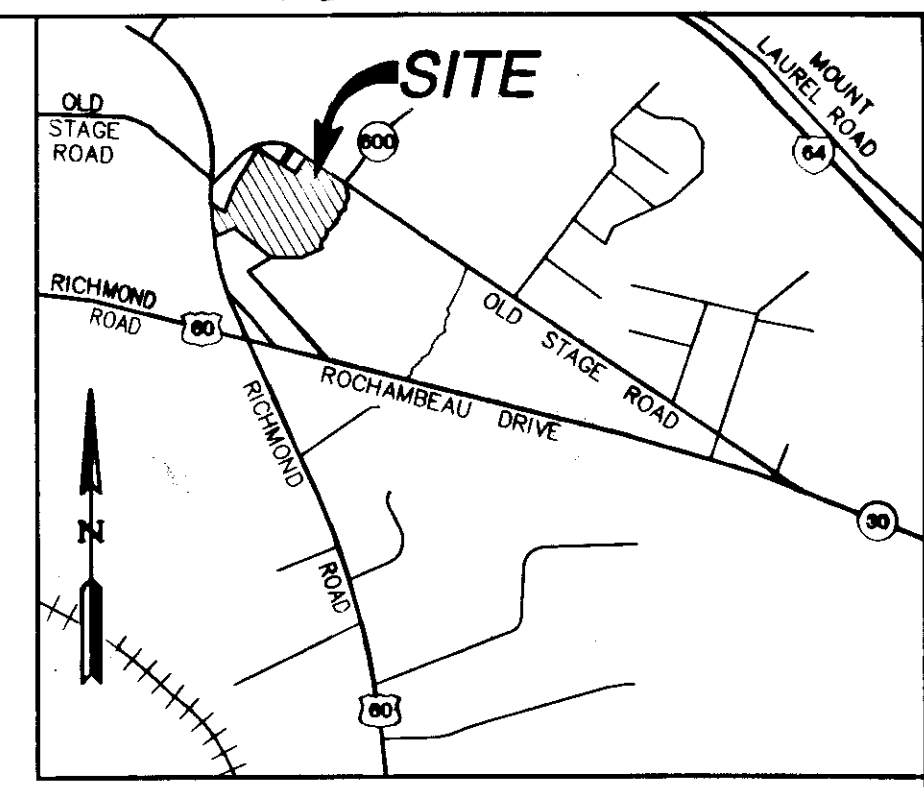

VICINITY MAP  
SCALE 1"=2,000'

GENERAL NOTES

1. SITE IS ZONED R-2 CLUSTER (GENERAL RESIDENTIAL WITH PROFFERS)
2. SITE CURRENTLY SERVED BY PUBLIC WATER & SEWER OWNED BY THE JAMES CITY COUNTY SERVICE AUTHORITY, J.C.S.A.
3. THE PROPERTY AS SHOWN IS ALL OF TAX PARCEL (12-2)(1-21). PROPERTY ADDRESS: 3225 OLDE STAGE ROAD  
OWNER: RAUCH DEVELOPMENT CO., LLC.
4. THE SUBJECT PARCEL LIES IN AN AREA DESIGNATED AS FLOOD INSURANCE RATE MAP (FIRM) ZONE "X", AREA DETERMINED TO BE OUTSIDE THE 0.2% ANNUAL CHANCE FLOOD PLAIN, ACCORDING TO JAMES CITY COUNTY, VA COMMUNITY PANEL NUMBER 510201-0045-C, DATED SEPTEMBER 28, 2007
5. PROPERTY REF.: INSTRUMENT #070019486

SURVEYOR'S CERTIFICATE

THE UNDERSIGNED SURVEYOR HEREBY CERTIFIES THAT HE HAS READ SECTION 55-79.58(A) OF THE CODE OF VIRGINIA AND FINDS THESE PLATS TO BE ACCURATE AND IN COMPLIANCE WITH THE CODE. HE FURTHER CERTIFIES THAT ALL IMPROVEMENTS DEPICTED HEREON HAVE BEEN SUBSTANTIALLY COMPLETED.

*Thomas C. Sublett* 03/21/13  
THOMAS C. SUBLETT LICENSE NO. 1886 DATE

3 Large/Small Plat(s) Recorded  
herewith as # 130009630

STATE OF VIRGINIA  
CITY OF WILLIAMSBURG & COUNTY OF JAMES CITY CIRCUIT COURT, THIS 10<sup>th</sup> DAY OF April, 2013,  
THE PLAT SHOWN HEREON WAS PRESENTED AND ADMITTED TO THE RECORD AS THE LAW DIRECTS. @ 12:30 AM/PM  
INSTRUMENT # 130009630

TESTE: *Betsy B. Woolridge, Clerk*  
BETSY B. WOOLRIDGE, CLERK

By *Claudia Stinkhelf, Dep Clerk*

Rev	Date	Description	Revised By

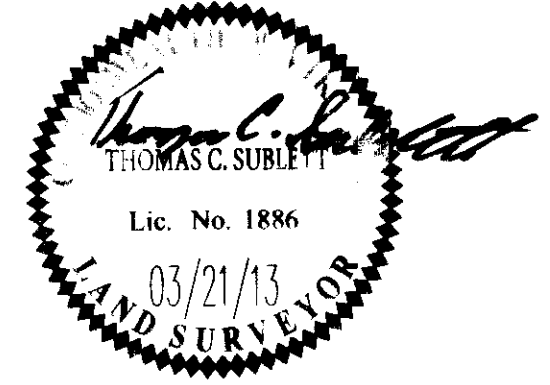

**AES**  
CONSULTING ENGINEERS  
Hampton Roads | Central Virginia | Middle Peninsula  
5246 Olde Towne Road, Suite 1  
Williamsburg, Virginia 23198  
Phone: (757) 253-0040  
Fax: (757) 220-8994  
www.aesva.com

PLAT OF CONDOMINIUM  
WEATHERLY AT WHITEHALL  
PHASE 15  
STONEHOUSE DISTRICT JAMES CITY COUNTY VIRGINIA

Project Contacts: JFS  
Project Number: 9048-08  
Scale: AS SHOWN Date: 03/21/13  
Sheet Number  
**1 OF 3**