



LEFT ELEVATION



FRONT ELEVATION



RIGHT ELEVATION



REAR ELEVATION

ELEVATIONS SHOWN ARE PER THE APPROVED SITE PLAN FOR THIS DEVELOPMENT

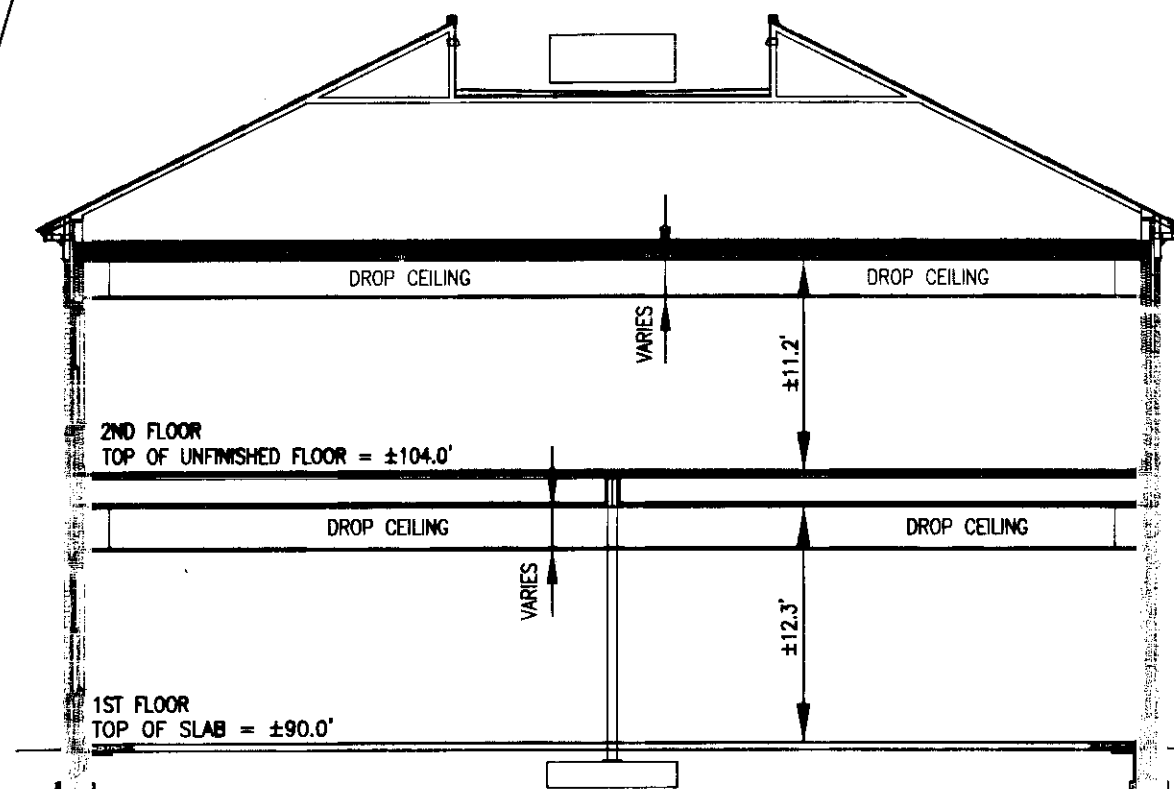

BUILDING SECTION



SURVEYORS CERTIFICATE

I HEREBY CERTIFY THAT TO THE BEST OF MY KNOWLEDGE OR BELIEF, THIS PLAT IS ACCURATE AND COMPLIES WITH THE PROVISIONS OF SECTION 55-79.58 (B) OF THE CODE OF VIRGINIA 1950 AS AMENDED AND THAT ALL UNITS DEPICTED HEREON HAVE BEEN SUBSTANTIALLY COMPLETED.

William S. Felts
STATE CERTIFIED LAND SURVEYOR

11-19-2012
DATE

NOTE:

A. Unit Boundaries. A Unit consists of a portion of the Condominium designed and intended for individual ownership and use. The boundary of the individual units are as set out in the Declaration of Condominium recorded as Instrument No. 10028271 in the Circuit Court of the County of James City.

B. Air Conditioning/Heating/Mechanical. The air conditioning, refrigerating, ventilation and heating equipment and water, sewer utility and electrical lines within the Unit, and the air conditioning, refrigerating, ventilation and heating equipment, water, sewer, utility and electrical lines, and other apparatus in connection therewith, which serve one Unit, wherever located, shall be owned by the Unit Owner as part of the Unit and are not part of Common Elements.

C. The horizontal plane of the exterior surface of the ceiling of a Unit, and all materials constituting all or any part of the ceiling shall be considered a part of the Unit.

3 Large/Small Plat(s) Recorded herewith as # 130000867

City of Williamsburg & County of James City
Circuit Court: This PLAT was recorded on
9 January 2013
at 3:20 AM/PM, PBO - PG
Document # 130000867
BETSY B. WOOLRIDGE, CLERK
by *Claudia H. Berkley*, Dep. Clerk

PLANS OF 432 McLAWS
McLAWS PROFESSIONAL CENTER, A CONDOMINIUM
ROBERTS DISTRICT, JAMES CITY COUNTY, VIRGINIA
DATE: 11-19-2012 SCALE: 1" = 10' JOB# 07-340
SHEET 3 OF 3

LandTech Resources, Inc.
Surveying • Engineering • GPS
205-E-Bulifants Blvd., Williamsburg, VA 23188
Phone: (757) 565-1677 Fax: (757) 565-0782
web: landtechresources.com