

Rev.	Date	Description	Revised By
1	11/1/12	REVISED PER COUNTY COMMENTS	TCS/JFS

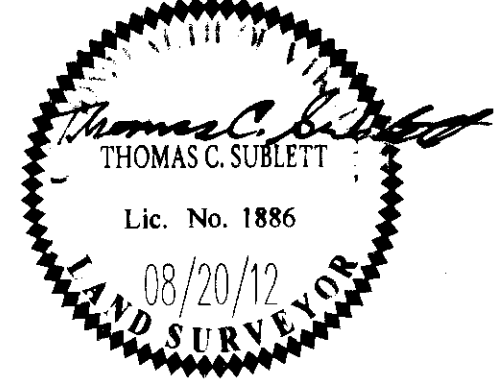

**AES**  
CONSULTING ENGINEERS  
Hampton Roads | Central Virginia | Middle Peninsula  
5248 Old Towne Road, Suite 1  
Williamsburg, Virginia 23188  
Phone: (757) 253-0040  
Fax: (757) 220-8994  
www.aesva.com

**PLAT OF SUBDIVISION  
AND BOUNDARY LINE EXTINGUISHMENT  
3 PARCELS OF LAND CONTAINING 125.820 ACRES±  
ON FORGE ROAD  
OWNED BY: THE MEADOWS FAMILY LIMITED PARTNERSHIP**  
STONEHOUSE DISTRICT JAMES CITY COUNTY VIRGINIA

Project Contacts:	TCS
Project Number:	9780-01
Scale:	NONE
Date:	08/20/12
Sheet Number	2 of 3

**NOTE:**  
PROPERTY IS ZONED A-1 GENERAL AGRICULTURE DISTRICT.  
BUILDING SETBACKS  
FRONT: 75' FROM THE STREET R/W FOR LOTS GREATER THAN 3 ACRES  
SIDE: 15'  
REAR: 35'

3 Large/Small Plat(s) Recorded  
herewith as # 120024981

City of Williamsburg & County of James City  
Circuit Court: This PLAT was recorded on  
at 12:37 AM/PM, PB PG  
Document # 120024981  
BETSY B. WOOLRIDGE, CLERK  
By *[Signature]*, Dep. Clerk