

120016580

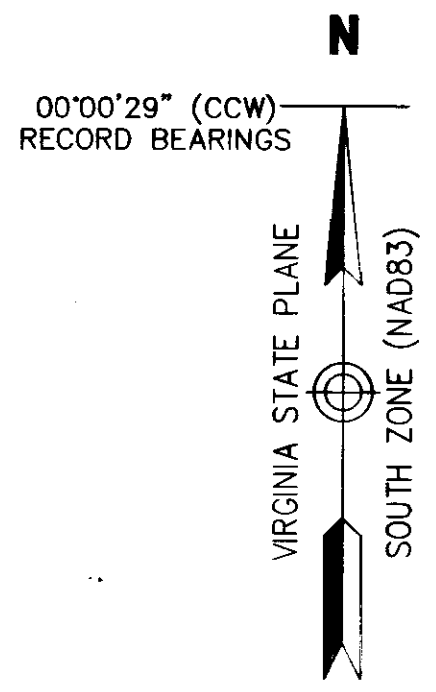

N/F
 XANTERRA KINGSMILL, LLC.
 PARCEL R-2
 PART OF TAX PARCEL
 5030100001 AND
 5040100001
 ZONED R-4
 REF. DOC. NO. 100015441 OF RECORD
 REF. INSTR. NO. 100014944 OF RECORD

N=3610107.6456
 E=12015430.4538

S89°47'10"W
 120.55' (TIE-LINE)
 S58°14'59"W
 29.74'
 S42°53'12"W
 21.07'
 S26°47'10"W
 40.10'
 S00°18'09"E
 34.29'

N=3610006.4713
 E=12015372.9161

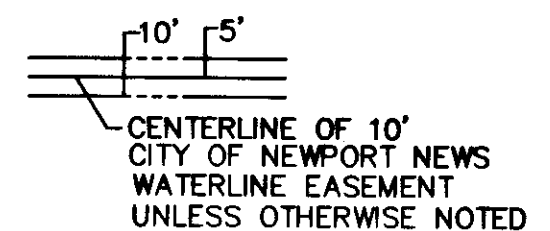

378.79' S87°58'05"W

1127.83'

1608.70'

SURVEY TIE LINE
 PROPERTY LINE IS
 MEAN LOW WATER

WATER MAIN EASEMENT LINE TABLE			WATER MAIN EASEMENT LINE TABLE		
LINE	LENGTH	BEARING	LINE	LENGTH	BEARING
E9	15.77'	S32°27'23"W	E34	9.45'	S81°16'18"W
E10	78.32'	S32°27'23"W	E35	9.11'	S81°16'18"W
E11	51.84'	S54°57'23"W	E36	10.93'	S81°16'18"W
E12	9.99'	S66°12'23"W	E37	41.53'	S81°43'51"W
E13	69.13'	S66°12'23"W	E38	55.69'	S81°43'51"W
E14	29.39'	S88°42'23"W	E39	33.61'	S81°43'51"W
E15	90.92'	N71°21'12"W	E40	13.07'	S81°43'51"W
E16	41.61'	N51°00'13"W	E43	18.68'	N57°33'19"W
E17	14.05'	N62°15'13"W	E44	18.43'	N57°32'37"W
E18	13.62'	N73°30'13"W	E45	23.27'	S23°47'37"E
E19	12.55'	N84°45'13"W	E46	25.85'	S01°54'24"E
E20	36.54'	S87°57'39"W	E48	13.03'	N02°02'21"W
E21	22.80'	S87°57'39"W	E49	26.85'	S09°12'39"W
E22	20.56'	S87°57'39"W	E50	30.27'	S09°12'39"W
E23	44.92'	S87°57'39"W	E51	5.00'	N65°46'39"E
E24	19.31'	N80°47'21"W	E52	15.32'	N09°12'39"E
E25	1.44'	N80°47'21"W	E53	5.00'	N65°46'39"E
E26	1.72'	N80°47'21"W	E54	19.83'	N09°12'39"E
E27	1.27'	N80°47'21"W	E55	33.59'	S09°09'54"E
E28	21.16'	N80°47'21"W	E56	15.54'	N09°09'54"W
E29	13.14'	S54°12'39"W	E57	13.05'	N08°16'09"W
E30	15.34'	S76°42'39"W	E58	17.38'	N08°16'09"W
E31	13.14'	N80°47'21"W	E59	20.94'	N19°31'25"E
E32	15.34'	N58°17'21"W			
E33	11.09'	N47°02'21"W			

City of Williamsburg & County of James City
 Circuit Court: This PLAT was recorded on
8 August 2012
 at 3:44 AM/PM, PG —
 Document # 120016580
 BETSY B. WOOLRIDGE, CLERK
 Dep. Clerk

METES AND BOUNDS PER RECORD AND
 BASED ON BEST FIT GRID FROM 2010 FIELD
 SURVEY. BEST FIT GRID DIFFERS FROM NAD
 83 VA SOUTH GRID BY 29" COUNTER
 CLOCK WISE.
 COORDINATES SHOWN REFERENCED TO NAD
 83 SOUTH GRID.

THIS PLAT IS BASED UPON 2010 FIELD
 SURVEY BY LANDMARK DESIGN GROUP, NOW
 VANASSE HANGEN BRUSTLIN, INC. AND TO
 THE BEST OF MY KNOWLEDGE AND BELIEF
 COMPLIES WITH THE APPLICABLE
 REGULATIONS ESTABLISHED BY THE
 COMMONWEALTH OF VIRGINIA BOARD FOR
 ARCHITECTS, ENGINEERS, LAND SURVEYORS,
 CERTIFIED INTERIOR DESIGNERS AND
 LANDSCAPE ARCHITECTS.

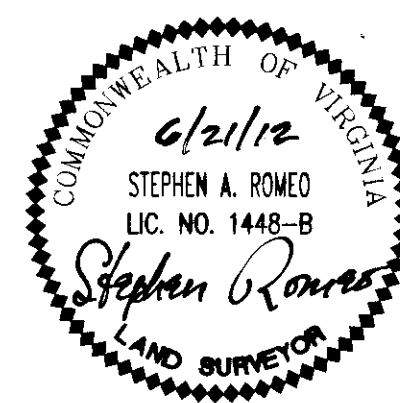

PLAT OF
 WATER MAIN EASEMENT
 PROJECTING (ON/ACROSS) LAND OF
 XANTERRA KINGSMILL, LLC.
 TO BE CONVEYED TO
 CITY OF NEWPORT NEWS
 BY
 CURRENT OWNER
 SHEET 2 OF 2

ROBERTS DISTRICT, JAMES CITY COUNTY, VIRGINIA
 DATE: 6/20/12 SCALE: 1"=50'



Vanasse Hangen Brustlin, Inc.
 Transportation Land Development Environmental Services
 351 McLaws Circle, Suite 3
 Williamsburg, Virginia 23185
 (757) 220-0500 • FAX (757) 220-8544