

120005900

EXHIBIT
A

James City County - Real Estate Assessment Division - Mapping/GIS Section

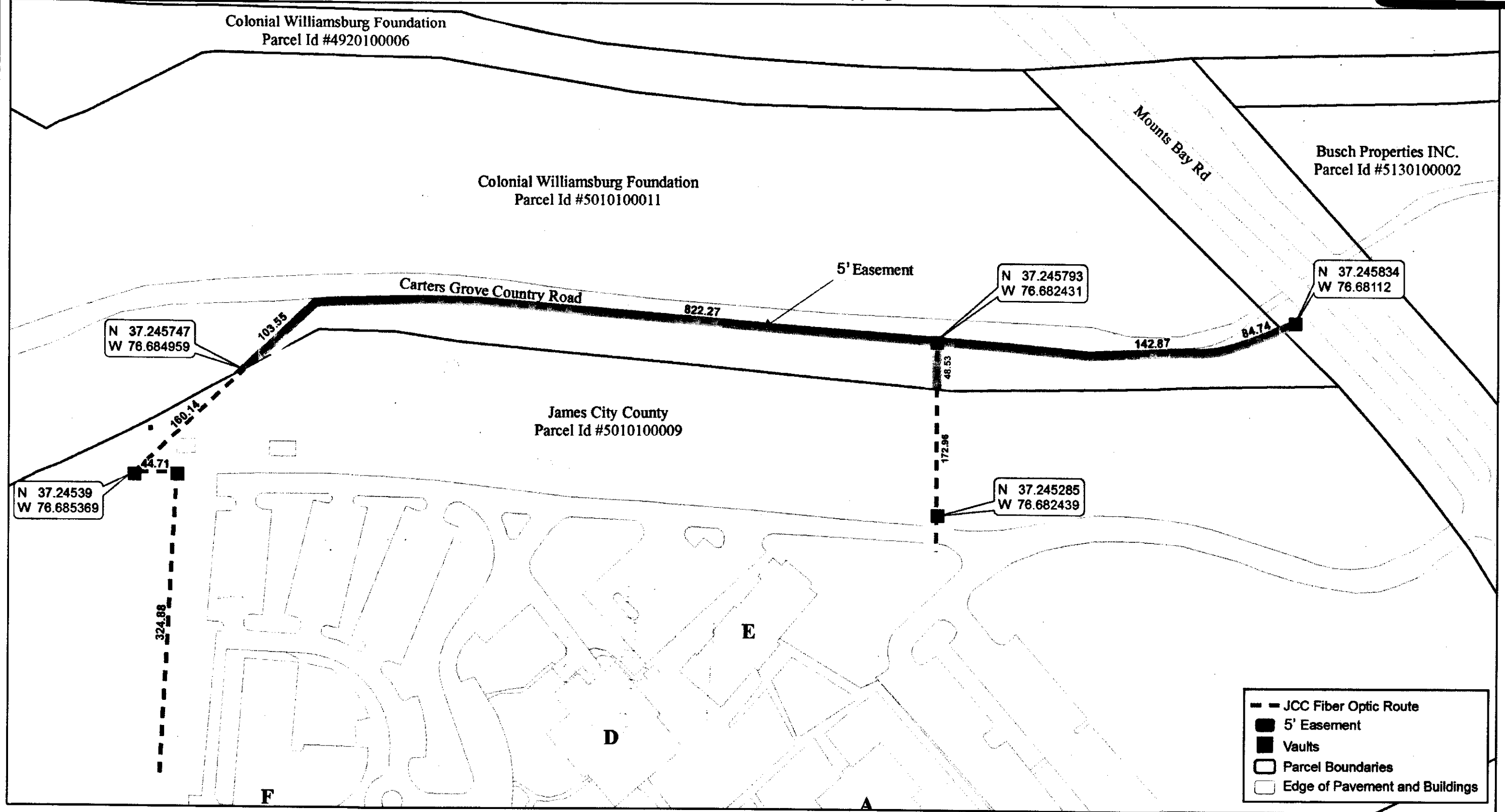

This drawing is neither a legally recorded map nor a survey and is not intended to be used as such. The information displayed is a compilation of records, information, and data obtained from various sources, and James City County is not responsible for its accuracy or how current it may be. If discrepancies are found, please contact the Real Estate Assessment Division of James City County, Mapping/GIS Section.



PLAT RECORDED IN
P.B. NO. _____ PAGE _____

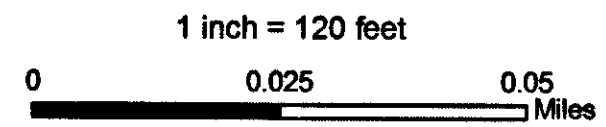

Instrument # 120005900
Recorded 3/19/12 @ 2:53 PM