

120000411

MATCH SHEET 3

NOTE:
 IN THE EVENT A FUTURE TRAFFIC SIGNAL IS NEEDED FOR THE INTERSECTION OF CENTERVILLE ROAD AND COLONIAL HERITAGE BOULEVARD (SEE COLONIAL HERITAGE AT WILLIAMSBURG AMENDED AND RESTATED PROFFERS NO. 050000448 DATED DECEMBER, 2004) ADDITIONAL RIGHT OF WAY AND/OR AN EASEMENT SHALL BE PROVIDED.

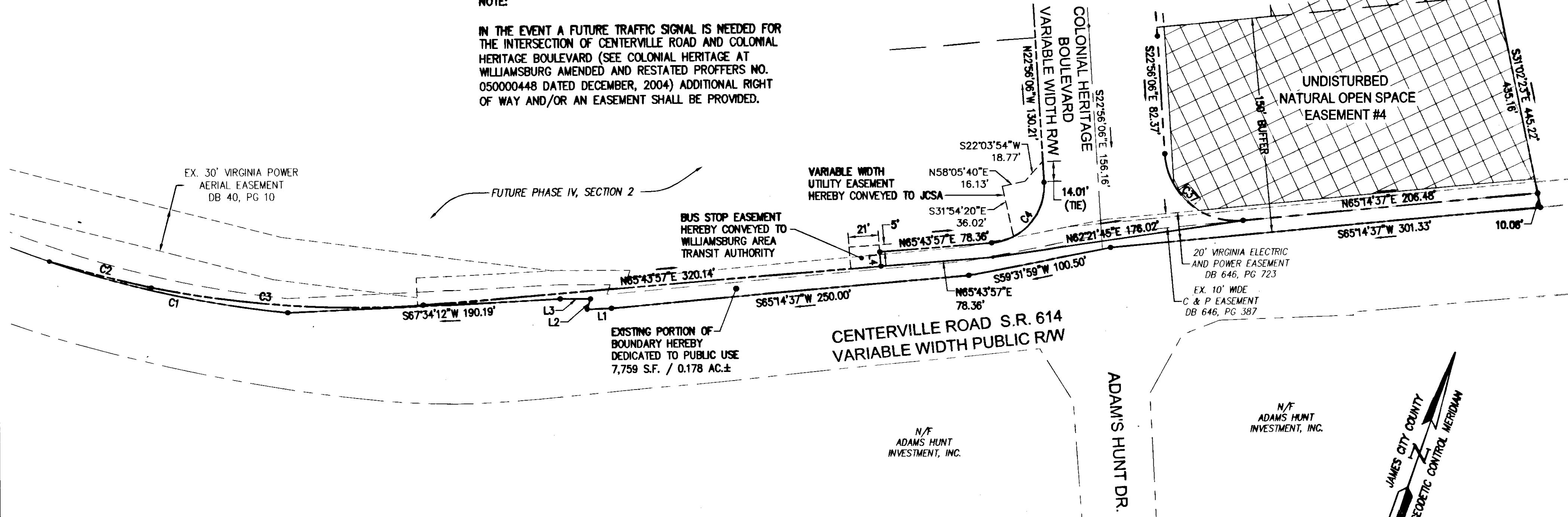

CURVE TABLE						
CURVE #	DELTA	RADIUS	LENGTH	TANGENT	CHORD	CHORD BEARING
C1	13°23'11"	728.94'	170.31'	85.54'	169.92'	S82°39'22"W
C2	4°03'01"	1038.76'	73.43'	36.73'	73.41'	N84°58'22"E
C3	15°19'05"	712.03'	190.36'	95.75'	189.79'	N74°06'15"E
C4	88°40'03"	40.00'	61.90'	39.08'	55.91'	N21°23'55"E
C5	7°25'14"	600.00'	77.71'	38.91'	77.65'	N26°38'43"W
C6	95°18'13"	25.00'	41.58'	27.43'	36.95'	N78°00'26"W
C7	90°00'00"	25.00'	39.27'	25.00'	35.36'	N9°20'27"E
C8	87°29'16"	25.00'	38.17'	23.93'	34.57'	N79°24'11"W
C9	7°01'27"	365.00'	44.75'	22.40'	44.72'	S60°21'54"W
C10	6°02'10"	305.00'	32.13'	16.08'	32.12'	N60°51'33"E
C11	93°30'00"	25.00'	40.80'	26.58'	36.42'	N11°05'27"E
C12	90°00'00"	25.00'	39.27'	25.00'	35.36'	S80°39'33"E
C13	64°34'29"	95.00'	107.07'	60.03'	101.49'	N22°03'13"E
C14	25°25'31"	95.00'	42.16'	21.43'	41.81'	N22°56'47"W
C15	43°08'34"	50.00'	37.65'	19.77'	36.77'	N14°05'28"W
C16	49°39'45"	50.00'	43.34'	23.14'	42.00'	N32°18'42"E
C17	157°43'48"	50.00'	137.65'	254.04'	98.12'	S43°59'31"E
C18	36°36'42"	25.00'	15.97'	8.27'	15.70'	S16°33'50"W
C19	33°55'02"	25.00'	14.80'	7.62'	14.58'	S18°42'02"E

CURVE TABLE						
CURVE #	DELTA	RADIUS	LENGTH	TANGENT	CHORD	CHORD BEARING
C20	90°00'00"	25.00'	39.27'	25.00'	35.36'	S80°39'33"E
C21	0°37'34"	175.00'	1.91'	0.96'	1.91'	N54°39'14"E
C22	16°17'15"	175.00'	49.75'	25.04'	49.58'	N63°06'38"E
C23	70°31'40"	25.00'	30.77'	17.68'	28.87'	N35°59'24"E
C24	33°35'19"	50.00'	29.31'	15.09'	28.89'	N17°31'11"E
C25	81°22'26"	50.00'	71.01'	42.99'	65.19'	N75°00'04"E
C26	100°18'19"	50.00'	87.53'	59.91'	76.78'	N14°09'34"W
C27	35°15'40"	50.00'	30.77'	15.89'	30.29'	N53°37'26"E
C28	16°54'48"	125.00'	36.90'	18.58'	36.77'	S62°47'51"W
C29	90°00'00"	25.00'	39.27'	25.00'	35.36'	S9°20'27"W
C30	35°31'54"	145.00'	89.92'	46.46'	88.49'	N17°53'35"W
C31	26°56'51"	145.00'	68.20'	34.74'	67.57'	N13°20'47"E
C32	21°11'08"	145.00'	53.61'	27.12'	53.31'	N37°24'47"E
C34	11°32'13"	25.00'	5.03'	2.53'	5.03'	S48°34'21"W
C35	78°27'47"	25.00'	34.24'	20.41'	31.62'	S3°34'21"W
C36	12°43'26"	374.00'	83.06'	41.70'	82.89'	N29°17'50"W
C37	91°49'17"	50.00'	80.13'	51.62'	71.83'	S68°50'45"E

CANDLEBERRY WAY R/W CURVE TABLE						
CURVE #	DELTA	RADIUS	LENGTH	TANGENT	CHORD	CHORD BEARING
C38	90°00'00"	95.00'	149.23'	95.00'	134.35'	N9°20'27"E
C39	250°32'08"	50.00'	218.64'	70.70'	81.65'	S89°36'19"W
C40	70°31'44"	25.00'	30.77'	17.68'	28.87'	S0°23'41"E
C41	16°54'48"	175.00'	51.66'	26.02'	51.47'	N62°47'51"E
C42	250°31'44"	50.00'	218.63'	70.71'	81.65'	S54°00'36"E
C43	90°00'00"	145.00'	227.77'	145.00'	205.06'	N9°20'27"E
C44	90°00'00"	25.00'	39.27'	25.00'	35.36'	S9°20'27"W

5 Large/Small Plat(s) Recorded herewith as # 120000411

LEGEND:

- UNDISTURBED NATURAL OPEN SPACE EASEMENT AND CONSERVATION AREA
- RPA MITIGATION AREA

NOTES: 1. SEE SHEET 1 FOR AREA TABULATIONS.
 2. SEE SHEET 5 FOR NATURAL OPEN SPACE & JCSA UTILITY EASEMENTS, MITIGATION AREA AND RELATED LINE TABLES.

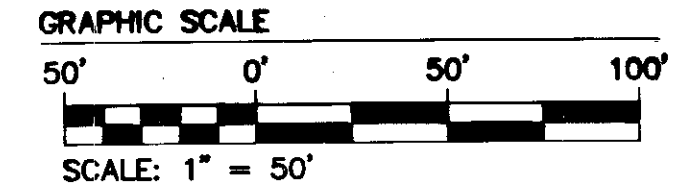

City of Williamsburg & County of James City Circuit Court: This PLAT was recorded on		
at 9:57 AM/PM, PG		
Document # 120000411		
BETSY B. WOOLRIDGE, CLERK		
By [Signature], Dep. Clerk		
1	9/20/2011	REVISED PLAT PER COUNTY COMMISSION
Rev.	Date	Description
		JFS Revised By

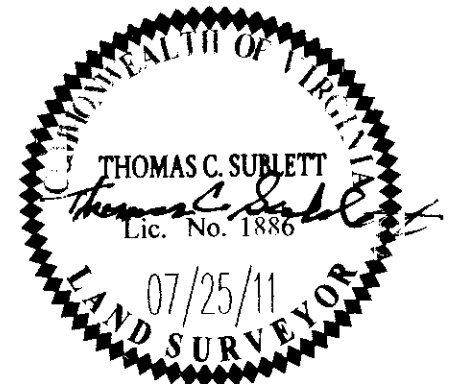

NES
 CONSULTING ENGINEERS
 5248 Old Towne Road, Suite 1
 Williamsburg, Virginia 23188
 Phone: (757) 253-0040
 Fax: (757) 220-8994
 www.nesva.com

PLAT OF SUBDIVISION COLONIAL HERITAGE
 PHASE IV, SECTION 1-B
 LOTS 54-78
 PREPARED FOR COLONIAL HERITAGE LLC
 STONEHOUSE DISTRICT JAMES CITY COUNTY VIRGINIA

Project Contacts: TCS
 Project Number: 8881-40-1B
 Scale: 1"=50'
 Date: 07/25/11
 Sheet Number: 4 of 5