

110005011

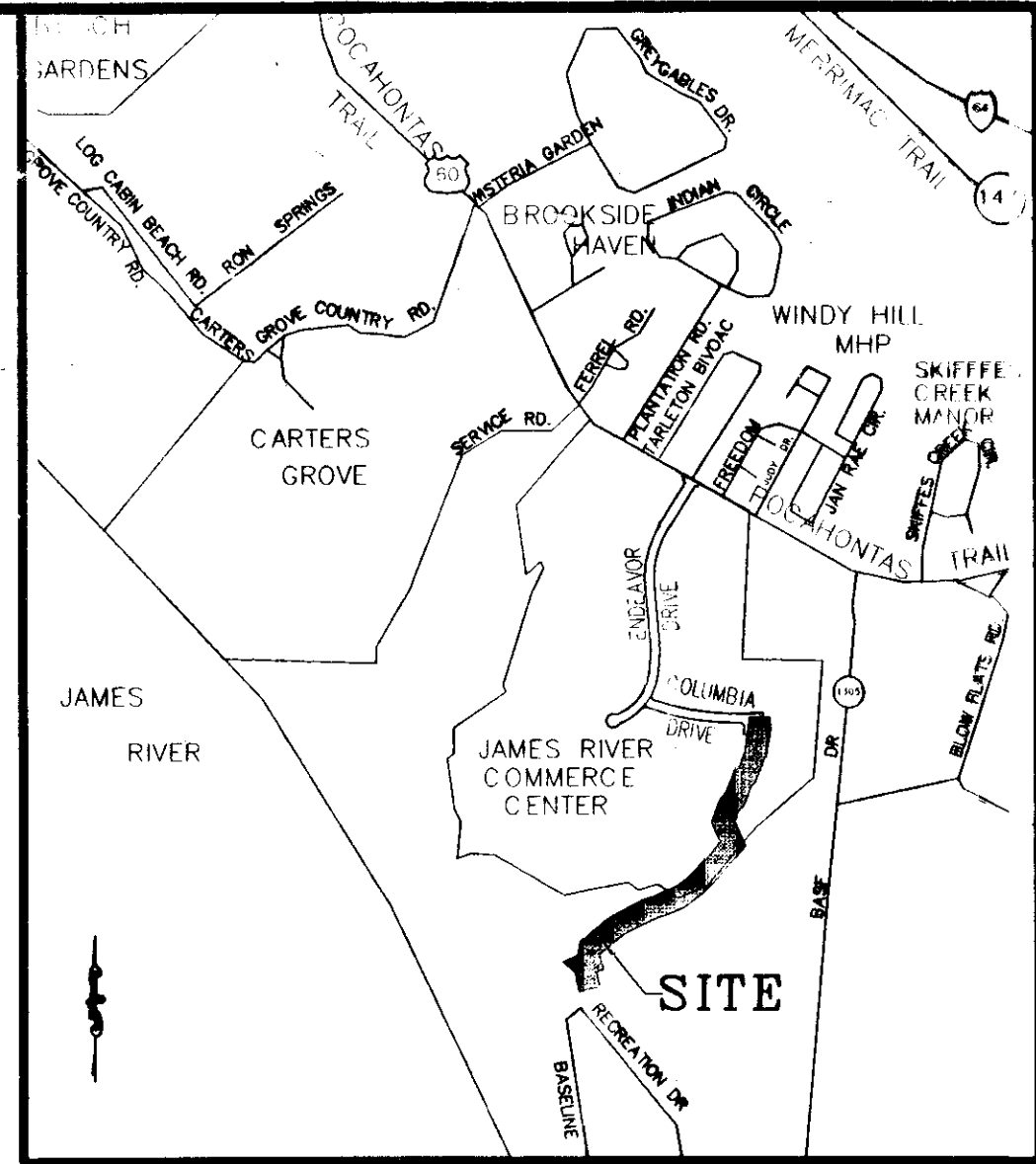

MATCHLINE SEE SHEET 2

VICINITY MAP: 1" = 2000'

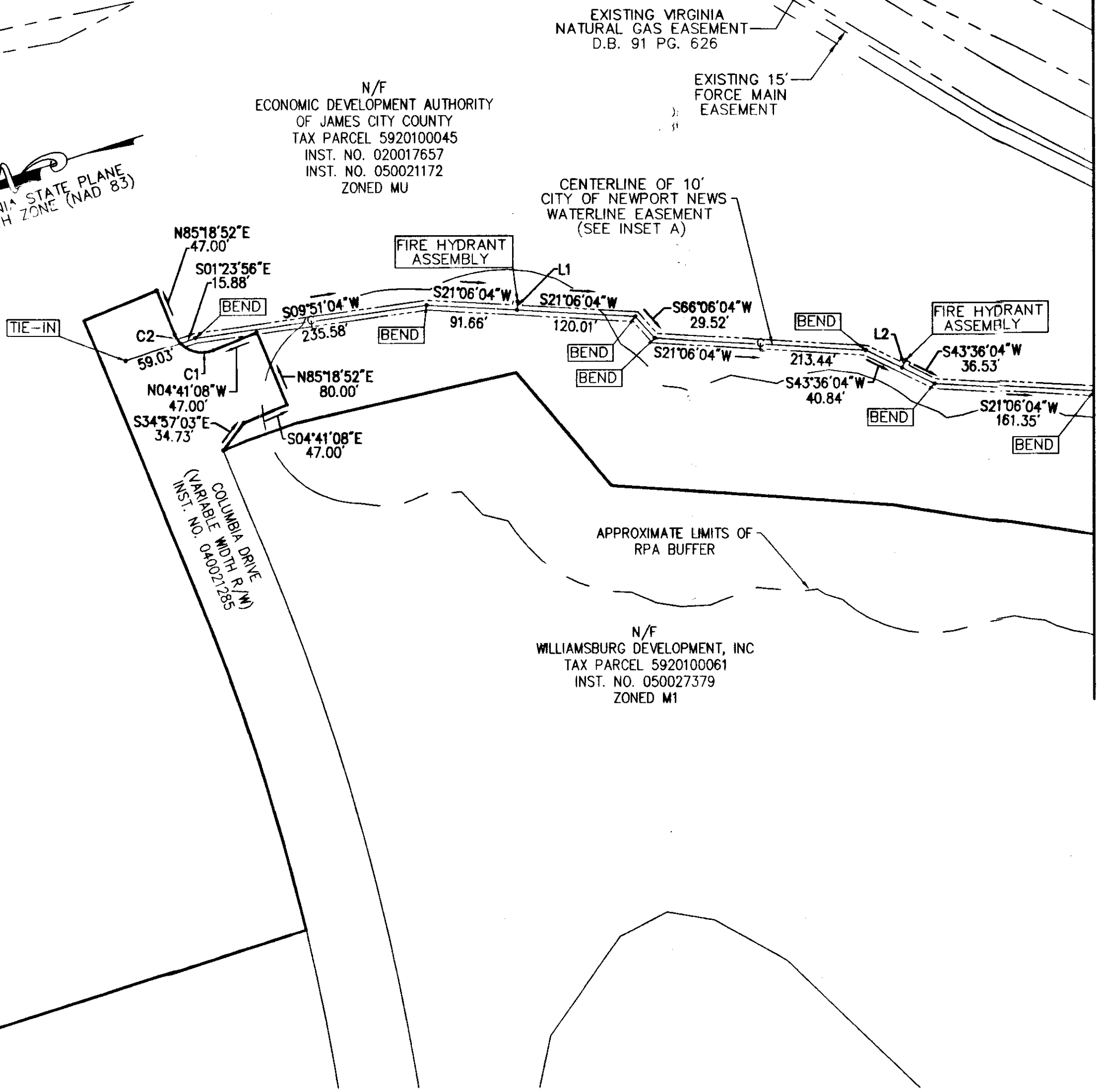
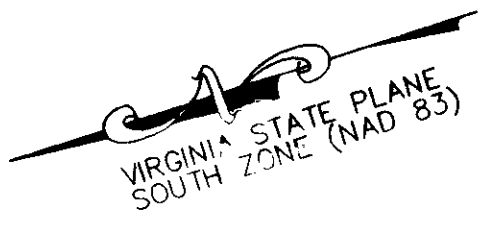
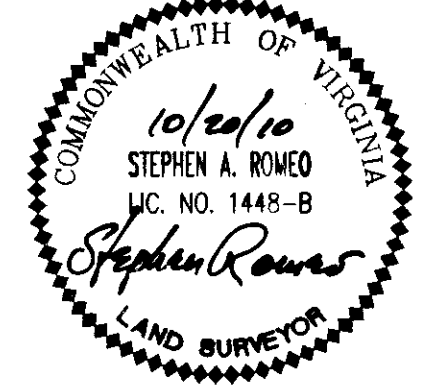
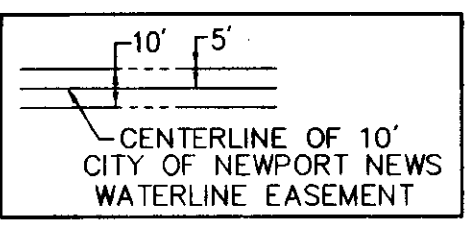

PLAT OF A
WATER MAIN EASEMENT
PROJECTING (ONTO/ACROSS)
LANDS OF
ECONOMIC DEVELOPMENT AUTHORITY
OF JAMES CITY COUNTY
TO BE CONVEYED TO
THE CITY OF NEWPORT NEWS, VIRGINIA
BY
CURRENT OWNER
JAMES CITY COUNTY, VIRGINIA
SHEET 1 OF 2
SCALE: 1"=100' DATE: 08/06/2010

General Notes

- NO TITLE REPORT WAS FURNISHED, THEREFORE ALL ENCUMBRANCES UPON THE PROPERTY MAY NOT BE SHOWN.
- THIS PROPERTY IS IN FLOOD ZONE "X" AS INDICATED ON THE FLOOD INSURANCE RATE MAP FOR THE JAMES CITY COUNTY, VIRGINIA HAVING COMMUNITY PANEL NUMBER 51095C0230C, EFFECTIVE DATE: SEPTEMBER 28, 2007.
- NO UNDERGROUND UTILITIES WERE LOCATED OR SHOWN ON THIS PLAN.
- THE EXISTING CONDITIONS SHOWN ON THIS PLAN ARE BASED ON APPROVED SITE PLAN PREPARED BY LANDMARK DESIGN GROUP, INC. TITLED AMENDMENT TO APPROVED PLAN SP-106-02, FORMERLY TRUSWOOD, 16" WATERLINE & DUAL FORCE MAIN EXTENSIONS, DATED AUGUST 16, 2007 AND REVISED FEBRUARY 20, 2008 SP-0083-2007.
- BOUNDARY SHOWN BASED ON PLATS OF RECORD AND DOES NOT REPRESENT A FIELD SURVEY.
D.B. 456 PG. 32 P.B. 56 PG. 32
INST. NO. 020017657 INST. NO. 040021285
INST. NO. 050021172 INST. NO. 050027379
INST. NO. 070011523
- HORIZONTAL DATUM IS BASED ON THE VIRGINIA STATE PLANE COORDINATE SYSTEM - SOUTH ZONE (NAD 83)
- THIS PLAT DOES NOT REFLECT WATERLINE AND APPURTENANCES AS ACTUALLY INSTALLED.

2 Large/Small Plat(s) Recorded
herewith as # 110005011
City of Williamsburg & County of James City
Circuit Court: This PLAT was recorded on
2-17-2011
at 2:12 AM/PM PG. 2
DOCUMENT # 110005011
BETSY B. WOOLRIDGE, CLERK
Betsy B. Woolridge Clerk

VHB Vanasse Hangen Brustlin, Inc.
Transportation Land Development Environmental Services
351 McLaws Circle, Suite 3
Williamsburg, Virginia 23185-6316
(757) 220 0500 FAX (757) 220 8544

110005011

LINE TABLE		
LINE	LENGTH	BEARING
L1	8.68'	N68°53'56"W
L2	8.59'	N46°23'56"W
L3	8.22'	S03°16'46"E
L4	6.74'	S0°16'46"E
L5	11.12'	N86°43'14"E
L6	90.47'	S42°25'47"W
L7	20.09'	S42°25'47"W
L8	5.97'	S50°19'33"W
L9	70.58'	S70°23'11"W
L10	8.58'	N46°32'44"W
L11	8.59'	N23°07'11"W

CURVE TABLE						
CURVE	LENGTH	RADIUS	DELTA	TANGENT	BEARING	CHORD
C1	47.12'	30.00'	90°00'00"	30.00'	N40°18'52"E	42.43'
C2	10.82'	30.00'	20°39'19"	5.47'	N74°59'13"E	10.76'
C3	119.20'	1312.20'	5°12'17"	59.64'	S38°58'17"W	119.16'
C4	167.29'	1581.48'	6°03'39"	83.72'	N39°23'58"E	167.21'
C5	96.47'	700.00'	7°53'47"	48.31'	N46°22'40"E	96.40'
C6	175.65'	1791.65'	5°37'02"	87.90'	N53°08'04"E	175.58'
C7	49.27'	400.00'	7°03'29"	24.67'	N59°28'20"E	49.24'
C8	54.90'	810.92'	3°52'45"	27.46'	N64°56'26"E	54.89'
C9	49.62'	810.92'	3°30'22"	24.82'	N68°38'00"E	49.62'
C10	29.52'	400.00'	4°13'41"	14.77'	N72°30'02"E	29.51'
C11	66.86'	493.31'	7°45'54"	33.48'	S70°43'55"W	66.80'

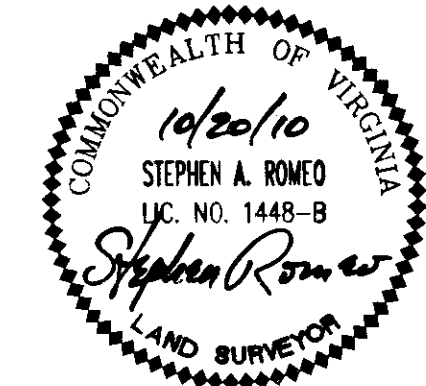
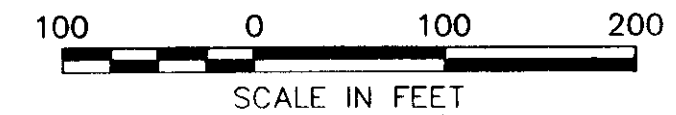
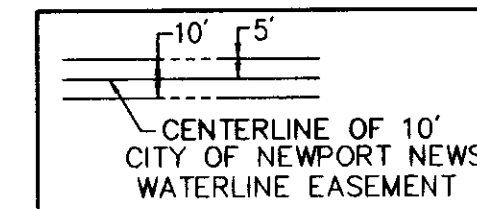
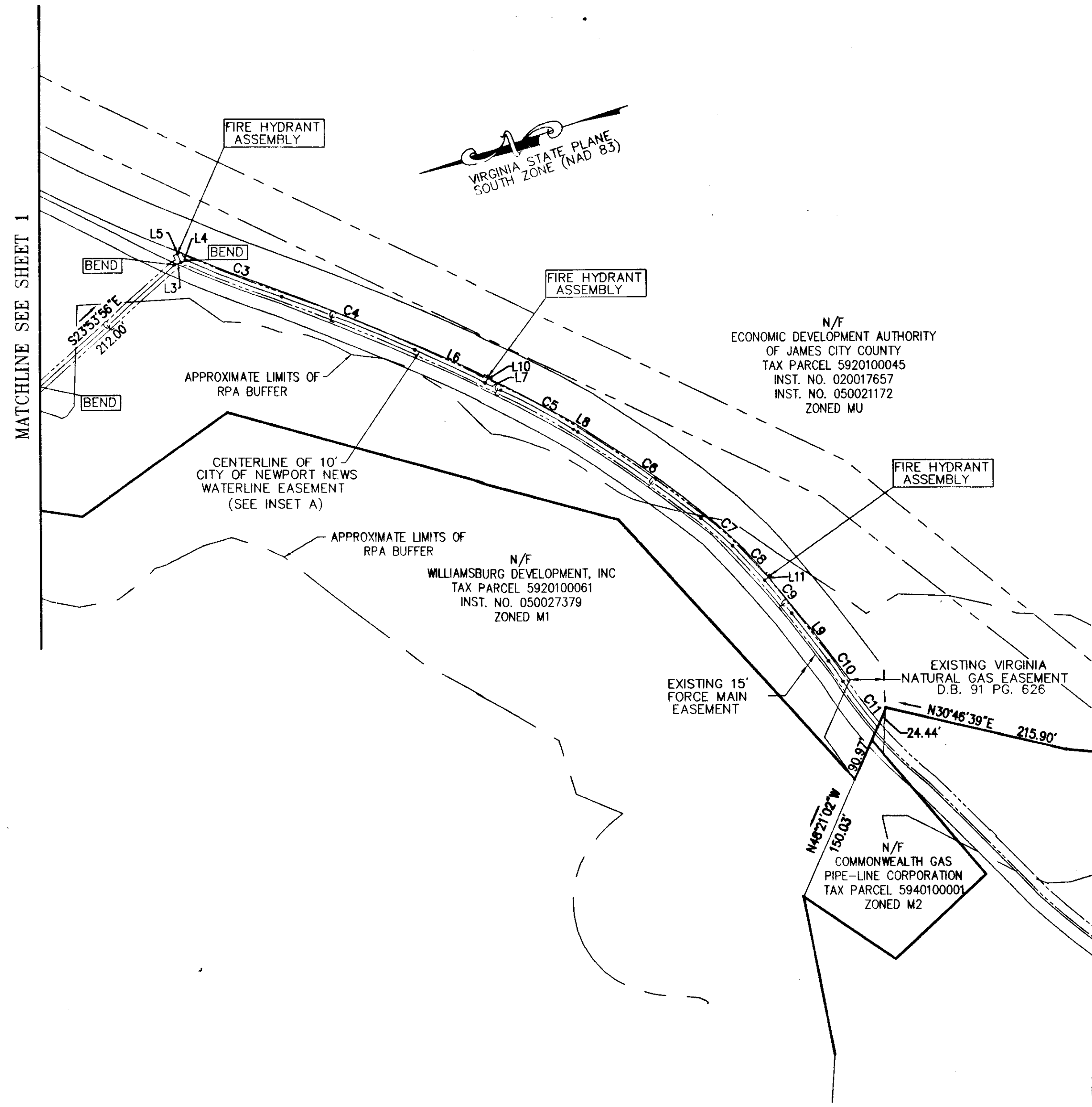

PLAT OF A
WATER MAIN EASEMENT
PROJECTING (ONTO/ACROSS)
LANDS OF
ECONOMIC DEVELOPMENT AUTHORITY
OF JAMES CITY COUNTY
TO BE CONVEYED TO
THE CITY OF NEWPORT NEWS, VIRGINIA
BY
CURRENT OWNER
JAMES CITY COUNTY, VIRGINIA
SHEET 2 OF 2
SCALE: 1"=100' DATE: 08/06/2010

2 Large/Small Plat(s) Recorded
herewith as # 110005011

City of Williamsburg & County of James City
Circuit Court: This PLAT was recorded on
2-17-2011
at 2:12 PM/PB PG
DOCUMENT # 110005011
BETSY B. WOOLRIDGE, CLERK
Betsy B. Woolridge Clerk

VHB Vanasse Hangen Brustlin, Inc.
Transportation Land Development Environmental Services
351 McLaws Circle, Suite 3
Williamsburg, Virginia 23185-6316
(757) 220 0500 FAX (757) 220 8544