

110005011

LINE TABLE		
LINE	LENGTH	BEARING
L1	8.68'	N68°53'56"W
L2	8.59'	N46°23'56"W
L3	8.22'	S03°16'46"E
L4	6.74'	S0°16'46"E
L5	11.12'	N86°43'14"E
L6	90.47'	S42°25'47"W
L7	20.09'	S42°25'47"W
L8	5.97'	S50°19'33"W
L9	70.58'	S70°23'11"W
L10	8.58'	N46°32'44"W
L11	8.59'	N23°07'11"W

CURVE TABLE						
CURVE	LENGTH	RADIUS	DELTA	TANGENT	BEARING	CHORD
C1	47.12'	30.00'	90°00'00"	30.00'	N40°18'52"E	42.43'
C2	10.82'	30.00'	20°39'19"	5.47'	N74°59'13"E	10.76'
C3	119.20'	1312.20'	5°12'17"	59.64'	S38°58'17"W	119.16'
C4	167.29'	1581.48'	6°03'39"	83.72'	N39°23'58"E	167.21'
C5	96.47'	700.00'	7°53'47"	48.31'	N46°22'40"E	96.40'
C6	175.65'	1791.65'	5°37'02"	87.90'	N53°08'04"E	175.58'
C7	49.27'	400.00'	7°03'29"	24.67'	N59°28'20"E	49.24'
C8	54.90'	810.92'	3°52'45"	27.46'	N64°56'26"E	54.89'
C9	49.62'	810.92'	3°30'22"	24.82'	N68°38'00"E	49.62'
C10	29.52'	400.00'	4°13'41"	14.77'	N72°30'02"E	29.51'
C11	66.86'	493.31'	7°45'54"	33.48'	S70°43'55"W	66.80'

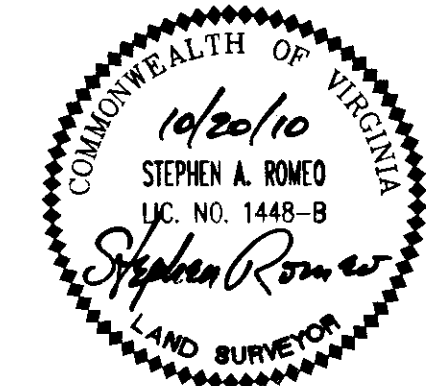
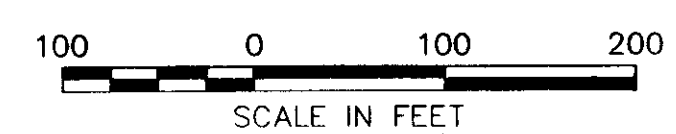
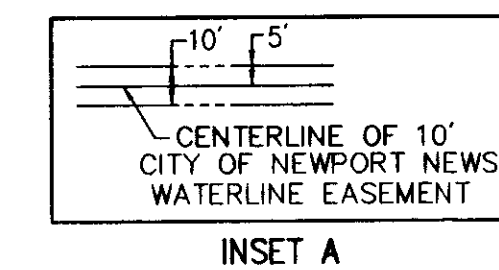
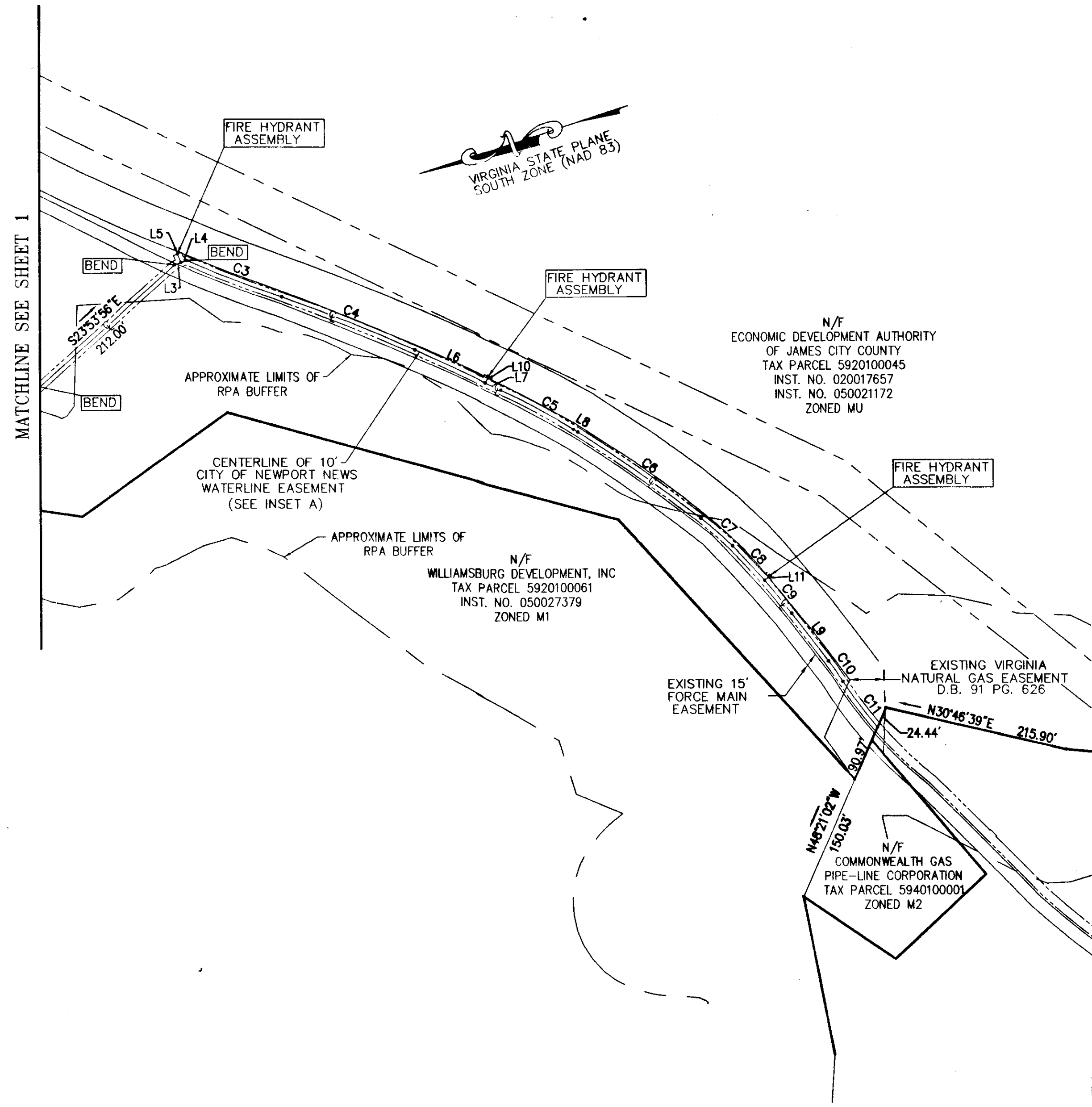

PLAT OF A  
 WATER MAIN EASEMENT  
 PROJECTING (ONTO/ACROSS)  
 LANDS OF  
 ECONOMIC DEVELOPMENT AUTHORITY  
 OF JAMES CITY COUNTY  
 TO BE CONVEYED TO  
 THE CITY OF NEWPORT NEWS, VIRGINIA  
 BY  
 CURRENT OWNER  
 JAMES CITY COUNTY, VIRGINIA  
 SHEET 2 OF 2  
 SCALE: 1"=100' DATE: 08/06/2010

2 Large/Small Plat(s) Recorded  
 herewith as # 110005011

City of Williamsburg & County of James City  
 Circuit Court: This PLAT was recorded on  
 2-17-2011  
 at 2:12 PM/PB PG  
 DOCUMENT # 110005011  
 BETSY B. WOOLRIDGE, CLERK  
 Betsy B. Woolridge Clerk

**VHB** Vanasse Hangen Brustlin, Inc.  
 Transportation Land Development Environmental Services  
 351 McLaws Circle, Suite 3  
 Williamsburg, Virginia 23185-6316  
 (757) 220 0500 FAX (757) 220 8544