

GENERAL NOTES

1. THIS PLAT WAS PRODUCED WITHOUT A TITLE REPORT AND MAY NOT REFLECT ALL EASEMENTS, SETBACKS, RESTRICTIONS, ETC. AFFECTING PROPERTY.
2. THIS PROPERTY APPEARS TO FALL IN ZONE "X" AS SHOWN ON COMMUNITY PANELS 510201 130C & 140C DATED SEPTEMBER 28, 2007.
3. ALL IMPROVEMENTS SHOWN ARE PROPOSED AND TAKEN FROM SITE PLAN.
4. EXTERIOR BOUNDARY LINES SHOWN PER P.B. 82, PG. 89.
5. PROPERTY OWNER INFORMATION:
WILLIAMSBURG PLANTATION, INC.
INST. #080008258
INST. #030008971
P.B. 82, PG. 89
6. SEE INST. #080018663 FOR PLAT OF EASEMENT AND PROPERTY LINE EXTINGUISHMENT

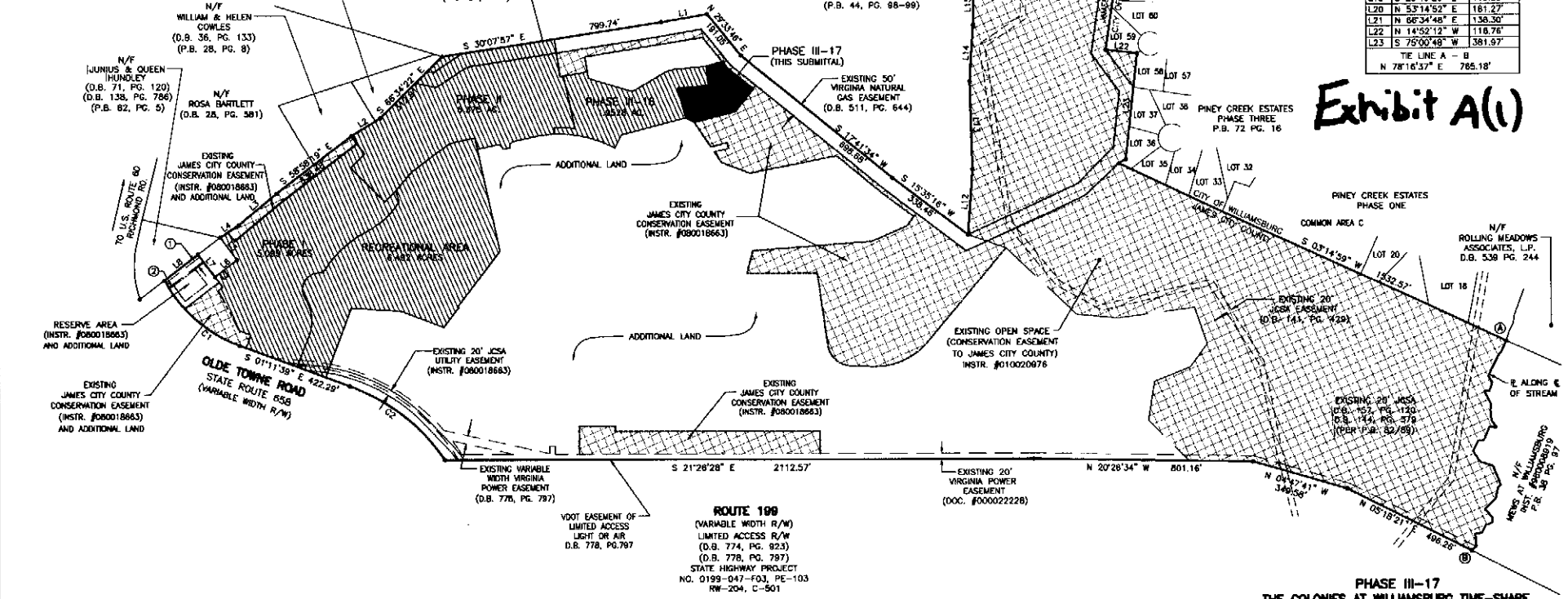
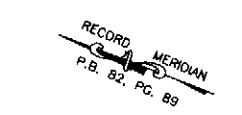

NO.	DIRECTION	DISTANCE
L1	S 31°30'02" E	186.17'
L2	S 52°50'40" E	120.12'
L3	S 60°57'19" E	178.70'
L4	S 54°46'48" E	81.43'
L5	N 31°07'14" E	100.00'
L6	S 58°52'48" E	100.00'
L7	S 31°07'14" W	100.00'
L8	S 58°52'48" E	151.17'
L9	S 58°52'48" E	110.84'
L10	N 04°42'57" E	96.00'
L11	N 17°09'05" W	240.28'
L12	S 72°40'06" W	235.84'
L13	N 68°52'55" E	316.14'
L14	N 72°14'19" E	202.79'
L15	N 62°05'24" E	143.28'
L16	N 69°08'04" E	234.03'
L17	N 70°04'28" E	372.45'
L18	N 75°34'33" E	251.28'
L19	S 25°49'20" E	115.28'
L20	N 55°14'52" E	181.27'
L21	N 66°34'48" E	136.30'
L22	N 14°52'12" W	118.76'
L23	S 78°00'48" W	381.97'
TIE LINE A - B		N 78°16'37" E 785.18'

Exhibit A(1)

EASEMENT TABLE

① EXISTING 20' JAMES CITY SERVICE AUTHORITY EASEMENT (D.B. 151, PG. 405)	② CENTERLINE OF EXISTING VEPCO EASEMENT (D.B. 152, PG. 348)
--	---

CURVE TABLE

NUMBER	DELTA	CHORD BEARING	TAN	RADIUS	ARC	CHORD
C1	41°31'21"	S 19°34'02" W	191.44	505.00	365.98	358.02
C2	35°43'20"	N 16°40'01" E	225.57	700.00	436.43	429.39



AREA TABULATIONS

I. TIME SHARE PROJECT - 13.183 Ac.
PRIOR SUBMISSIONS: 12.427 Ac.
THIS SUBMISSION (PHASE III-17): 0.756 Ac.

II. ADDITIONAL LAND: 99.307 Ac.
III. DEVELOPMENT: 72.48 Ac.

NOTE: THE RECREATIONAL AREA, CONTAINING 6.482 ACRES, REMAINS OUTSIDE THE TIME-SHARE PROJECT.

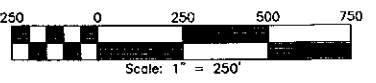

**PHASE III-17
THE COLONIES AT WILLIAMSBURG TIME-SHARE,
A VACATION VILLAGE RESORT**
LOCATED IN
JAMES CITY COUNTY, VA
DATE: 10-05-09 SCALE: 1"=250' JOB# 06-039
SHEET 1 OF 2

LandTech Resources, Inc.
Surveying • Engineering • GPS

205-E Bulfinch Blvd., Williamsburg, VA 23188
Phone: (757) 565-1677 Fax: (757) 565-0782
web: landtechresources.com