

100014684

THIS SHEET ADDRESSES
LOTS 16 - 19 & 37 - 38
SEE SHEET 7 FOR CURVE DATA

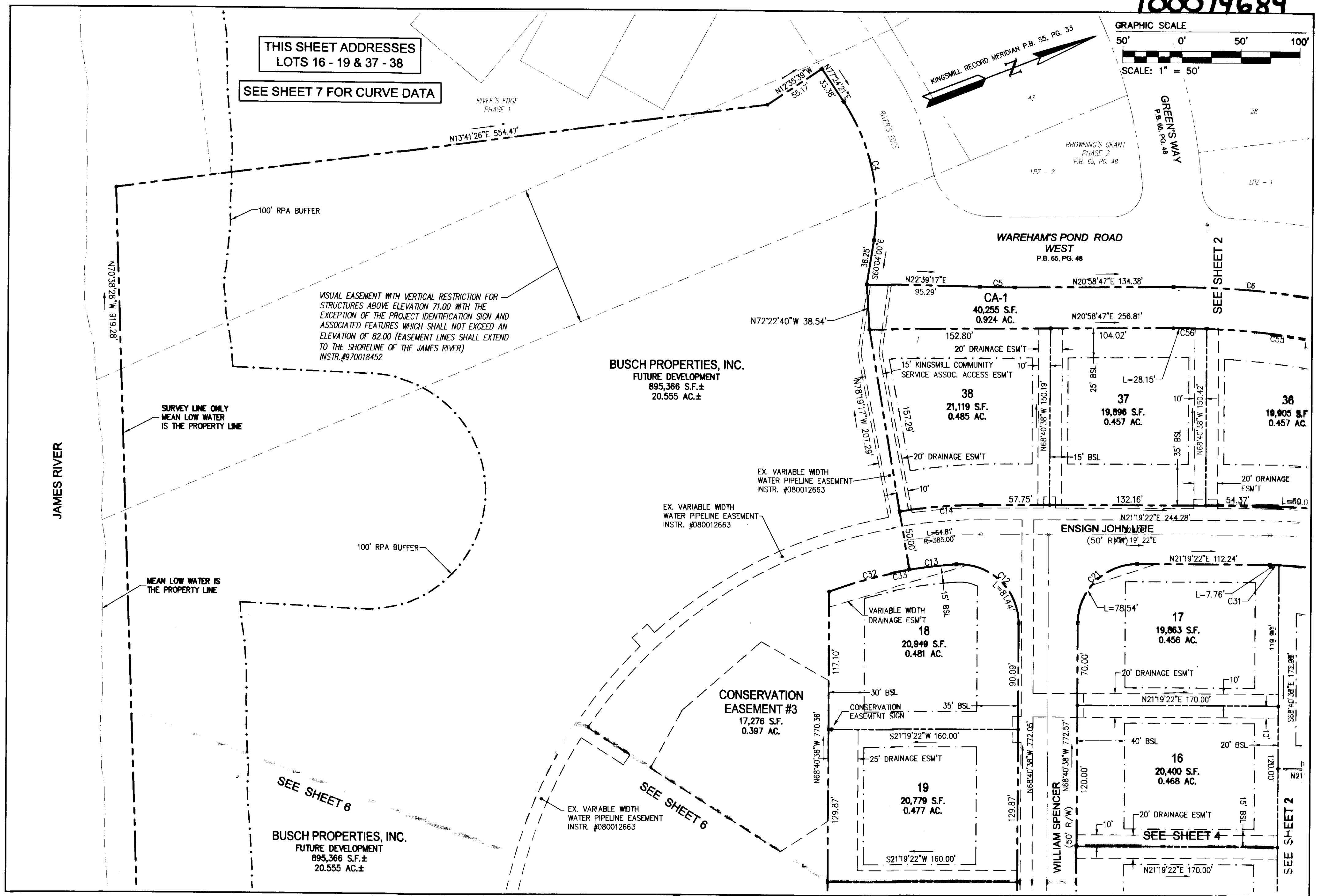
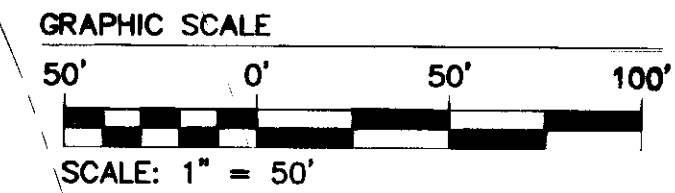

JAMES RIVER

VISUAL EASEMENT WITH VERTICAL RESTRICTION FOR STRUCTURES ABOVE ELEVATION 71.00 WITH THE EXCEPTION OF THE PROJECT IDENTIFICATION SIGN AND ASSOCIATED FEATURES WHICH SHALL NOT EXCEED AN ELEVATION OF 82.00 (EASEMENT LINES SHALL EXTEND TO THE SHORELINE OF THE JAMES RIVER) INSTR. #970018452

SURVEY LINE ONLY MEAN LOW WATER IS THE PROPERTY LINE

MEAN LOW WATER IS THE PROPERTY LINE

BUSCH PROPERTIES, INC.
FUTURE DEVELOPMENT
895,366 S.F.±
20.555 AC.±

EX. VARIABLE WIDTH WATER PIPELINE EASEMENT INSTR. #080012663

CONSERVATION EASEMENT #3
17,276 S.F.
0.397 AC.

BUSCH PROPERTIES, INC.
FUTURE DEVELOPMENT
895,366 S.F.±
20.555 AC.±

SEE SHEET 6

SEE SHEET 6

City of Williamsburg & County of James City		Circuit Court: This PLAT was recorded on <u>22 July 2010</u>	
at <u>10:45</u> AM, P.M. PG. <u>1</u>		DOCUMENT # <u>100014684</u>	
BETSY B. WOOLRIDGE, CLERK		<u>Betsy B. Woolridge</u> Clerk	
1	5/28/2010	Revised By	RDM

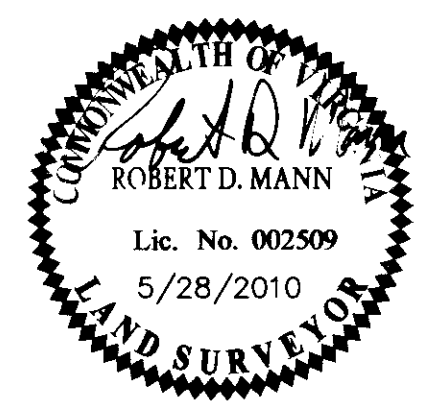

Large/Small Plat(s) Recorded herewith as # 100014684

5248 Old Towne Road, Suite 1
Williamsburg, Virginia 23188
Phone: (757) 253-0040
Fax: (757) 220-8994
www.wesva.com

Hampton Roads | Central Virginia | Middle Peninsula

PLAT OF CORRECTION
SPENCER'S GRANT
KINGSMILL ON THE JAMES
PHASE 1, LOTS 1 - 38
OWNER/DEVELOPER: BUSCH PROPERTIES, INC.

ROBERTS DISTRICT JAMES CITY COUNTY VIRGINIA

Project Contacts: RDM
Project Number: 7763-20
Scale: 1" = 50' Date: 4/2/2010
Sheet Number
5 OF 7