

NOTE:
 THIS SURVEY WAS PREPARED WITHOUT THE BENEFIT OF A TITLE REPORT. THIS PROPERTY IS SUBJECT TO EASEMENTS, SERVITUDES AND COVENANTS OF RECORD. THIS PLAT IS BASED ON DEEDS AND PLATS OF RECORD AND DOES NOT REPRESENT A BOUNDARY SURVEY.

City of Williamsburg & County of James City
 Circuit Court: This PLAT was recorded on
16 July 2010
 at 12:39 AM/PM, P.B. PG 2
 DOCUMENT # 100014376
 BETSY B. WOOLRIDGE, CLERK
Betsy B. Woolridge, Clerk

LITTLETON QUARTER SUBD. SECTION V - P.B.38, PG.95
 3 Large/Small Plat(s) Recorded
 Record # 100014376

S:\Sub\175328-C-County\RD000-County\RD.dwg\Surf\Plat\1001-County\RD_R-9.dwg, 7/12/2010 10:32:38 AM, mark indrants

Rev.	Date	Description	Revised By
2	8/24/2010	BOUNDARY LINE ADJUSTMENT AND EASEMENT ADDITION	RDM
1	8/18/2010	ADDED EASEMENTS, WETLANDS AND RPA	RDM

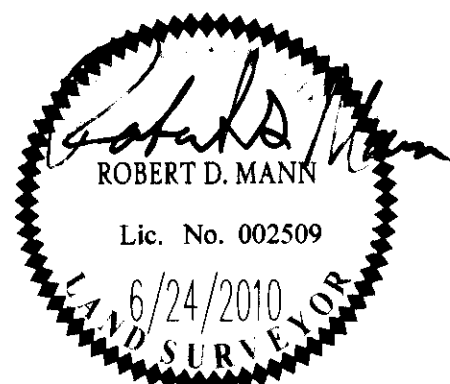

NES
 CONSULTING ENGINEERS
 5248 Olde Towne Road, Suite 1
 Williamsburg, Virginia 23188
 Phone: (757) 253-0040
 Fax: (757) 220-8994
 www.nesva.com

COMPOSITE PLAT OF BOUNDARY LINE ADJUSTMENT
**CARTER'S GROVE COUNTRY ROAD
 AND PARCELS R-9 & R-11**
 KINGSMILL ON THE JAMES
 ROBERTS DISTRICT JAMES CITY COUNTY VIRGINIA

Project Contacts: **RDM**
 Project Number: **7753-28**
 Scale: **1"=200'** Date: **04-06-2010**
 Sheet Number
2 OF 3