

100008359

CURVE TABLE						
CURVE	RADIUS	LENGTH	TANGENT	DELTA	CHORD BEARING	CHORD
C1	338.66'	28.89'	14.45'	4°53'14"	N27°29'26"E	28.88'
C2	333.00'	162.85'	83.09'	28°01'13"	N19°45'31"E	161.23'
C3	37.00'	56.02'	34.96'	86°45'02"	N49°08'35"E	50.82'

LINE TABLE		
LINE	BEARING	DISTANCE
L1	N05°46'04"E	63.26'
L2	N48°19'20"W	68.74'
L3	N07°34'36"E	43.39'
L4	N00°00'00"E	222.08'
L5	N50°38'19"E	130.92'
L6	S16°22'46"W	264.24'
L7	S87°28'54"E	6.72'

NOTES:

THIS PLAT WAS PREPARED WITHOUT THE BENEFIT OF A TITLE BINDER, THEREFOR ALL EXISTING EASEMENTS MAY NOT BE SHOWN.

Large/Small Plat(s) Recorded herewith as # 100008359

City of Williamsburg & County of James City Circuit Court: This PLAT was recorded on 4-30-2010 at 2:13 AM/PM, PB PG DOCUMENT # 100008359 BETSY B. WOOLRIDGE, CLERK

Betsy B. Woolridge Clerk

PLAT SHOWING A VARIABLE WIDTH CONSERVATION EASEMENT ACROSS THE PROPERTY OF JAMES CITY COUNTY, VIRGINIA

Powhatan District	James City County, Va
DATE: SEPT.9, 2009	SCALE: 1"=300'
SHEET: 1 OF 1	J.N.: 24136
DRAWN BY: M.S.F.	CHECK BY: M.C.S.

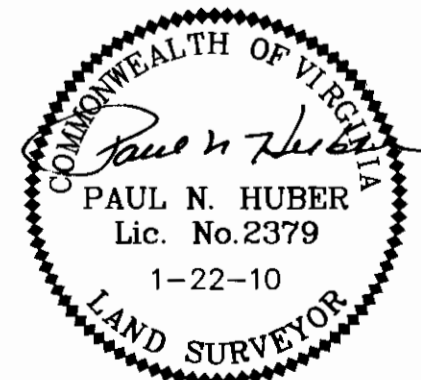

REVISED: 1-22-10 (COMMENTS)
REVISED: 1-6-10 (COMMENTS)

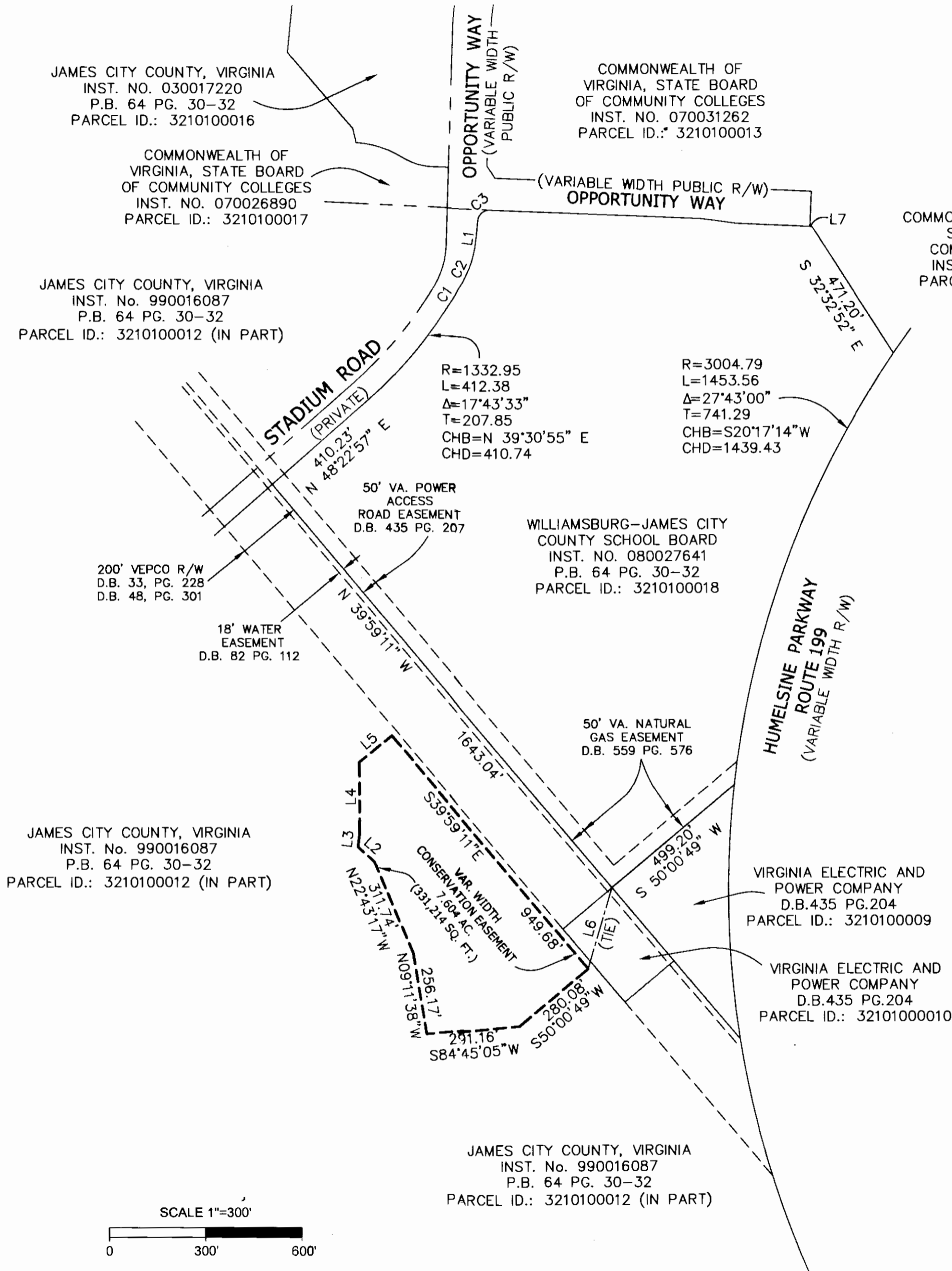

NAD 83

JAMES CITY COUNTY, VIRGINIA
INST. NO. 030017220
P.B. 64 PG. 30-32
PARCEL ID.: 3210100016

COMMONWEALTH OF VIRGINIA, STATE BOARD OF COMMUNITY COLLEGES
INST. NO. 070026890
PARCEL ID.: 3210100017

JAMES CITY COUNTY, VIRGINIA
INST. No. 990016087
P.B. 64 PG. 30-32
PARCEL ID.: 3210100012 (IN PART)

COMMONWEALTH OF VIRGINIA, STATE BOARD OF COMMUNITY COLLEGES
INST. NO. 070031262
PARCEL ID.: 3210100013

COMMONWEALTH OF VIRGINIA, STATE BOARD OF COMMUNITY COLLEGES
INST. NO. 070031262
PARCEL ID.: 3210100013

WILLIAMSBURG-JAMES CITY COUNTY SCHOOL BOARD
INST. NO. 080027641
P.B. 64 PG. 30-32
PARCEL ID.: 3210100018

VIRGINIA ELECTRIC AND POWER COMPANY
D.B.435 PG.204
PARCEL ID.: 3210100009

VIRGINIA ELECTRIC AND POWER COMPANY
D.B.435 PG.204
PARCEL ID.: 3210100010

JAMES CITY COUNTY, VIRGINIA
INST. No. 990016087
P.B. 64 PG. 30-32
PARCEL ID.: 3210100012 (IN PART)

JAMES CITY COUNTY, VIRGINIA
INST. No. 990016087
P.B. 64 PG. 30-32
PARCEL ID.: 3210100012 (IN PART)

THIS DRAWING PREPARED AT THE CORPORATE OFFICE
 1001 Boulders Parkway, Suite 300 | Richmond, VA 23225
 TEL 804.200.6500 FAX 804.560.1016 www.timmons.com

YOUR VISION ACHIEVED THROUGH OURS.

TIMMONS GROUP

Technology
Infrastructure
Residential
Site Development