

090006455

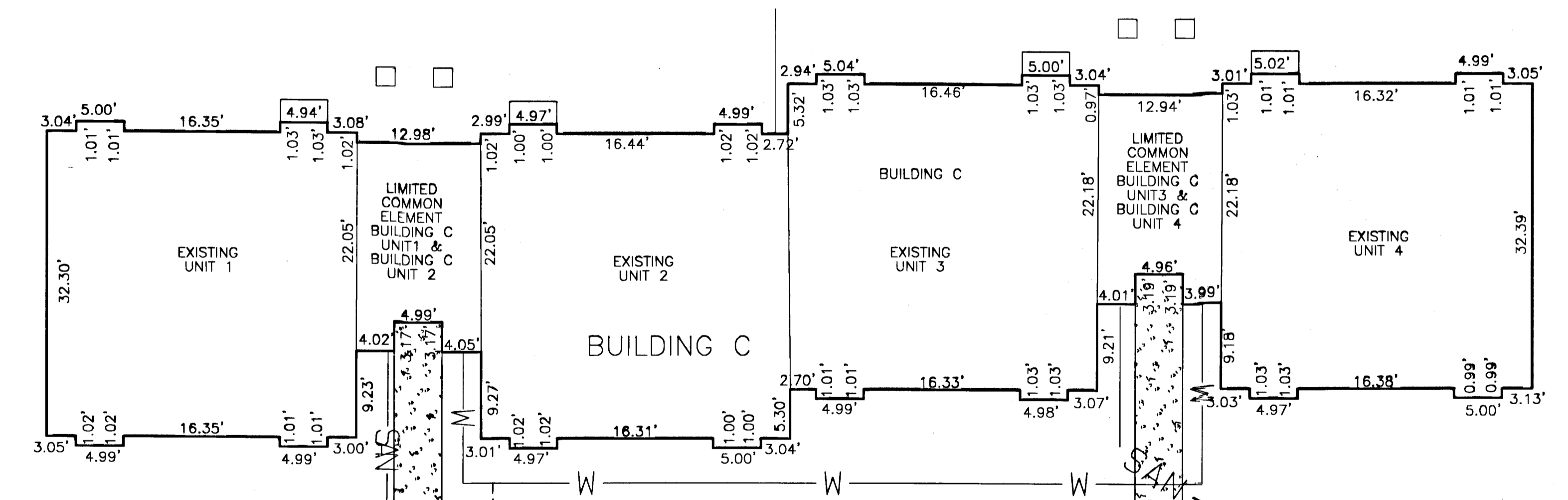
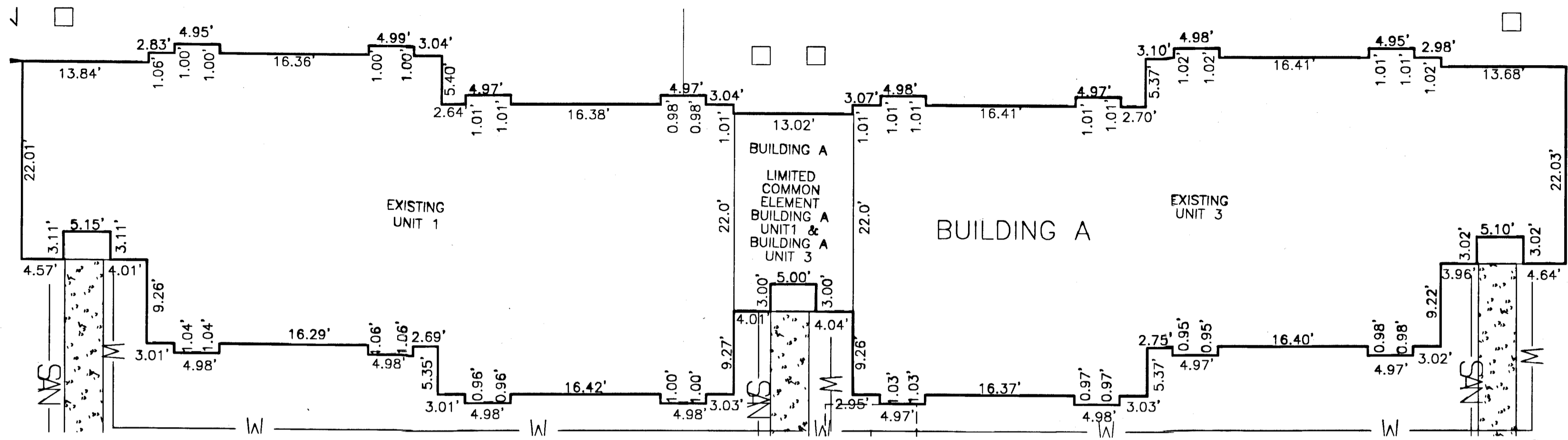

FIFTH AMENDED EXHIBIT
 PACKET'S EXECUTIVE CENTER CONDOMINIUM
 PARCEL 20Y
 BUSCH CORPORATE CENTER

ROBERTS DISTRICT JAMES CITY COUNTY, VIRGINIA
 SCALE: 1" = 10' DATE: 7/17/08
 REVISED: 9-11-08
 SHEET 3 OF 3

3 Large/Small Plat(s) Recorded
 herewith as # 090006455

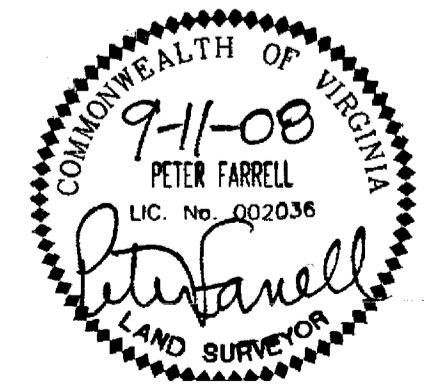

4029 Ironbound Road
 Suite 100
 Williamsburg, VA 23188
 Tel. (757) 253-2975
 Fax (757) 229-0049
 Email: lmdg@landmarkdg.com

5544 Greenwich Road
 Suite 200
 Virginia Beach, VA 23462
 Tel. (757) 473-2000
 Fax (757) 497-7933
 Email: lmdg@landmarkdg.com

City of Williamsburg & County of James City
 Circuit Court: This PLAT was recorded on
 at 11:48 AM/PM, PB PG
 DOCUMENT # 090006455
 BETSY B. WOOLRIDGE, CLERK
 Clerk

- Notes:
1. LOWER VERTICAL BOUNDARY OF EACH UNIT IS THE TOP OF THE SLAB.
 2. UPPER VERTICAL BOUNDARY OF EACH UNIT IS THE UNDERSIDE OF THE ROOF TRUSSES.