

090004712

POCAHONTAS TRAIL U.S. ROUTE 60
VARIABLE WIDTH R/W

LOT 3B
PARCEL ID 6010200003B
1601 GREENMOUNT PKWY.
AREA = 997,052± S.F.
22.89± AC.

N/F
NEWPORT NEWS
WATERWORKS
PARCEL ID:
6010100003
SKIFFES CREEK
RESERVOIR

NOTE:
FROM POINT 'A' TO POINT 'B' (L1 THROUGH L11); TIE LINE
ONLY; PROPERTY LINE IS THE CONTOUR OF ELEVATION 15.0'
ABOVE MEAN HIGH TIDE, 3.0' HIGHER THAN THE CREST OF THE
CONCRETE SPILLWAY OF SKIFFES CREEK.

N/F
HAYNES DISTRIBUTION, LLC
PARCEL ID: 6010200003C
LOT 3C

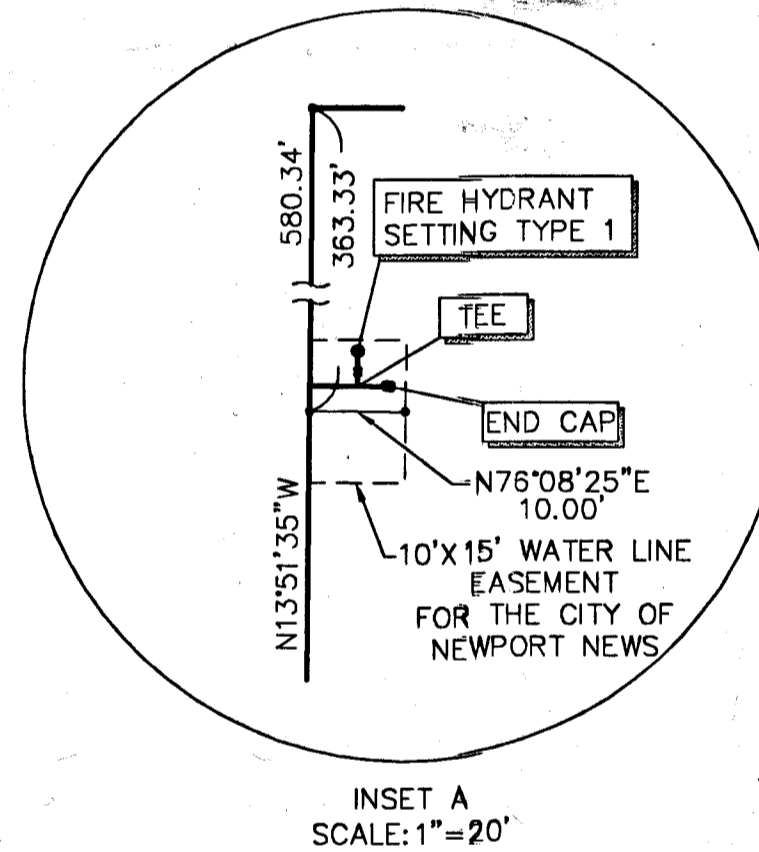

INSET A
SCALE: 1"=20'

LEGEND
RPA=RESOURCE PROTECTION AREA
IRF=IRON ROD FOUND
IPF=IRON PIPE FOUND

PLAT SHOWING WATERLINE EASEMENT
AT
CARTER EQUIPMENT
GREENMOUNT
LOT 3B
ROBERTS DISTRICT, JAMES CITY COUNTY, VIRGINIA
TO BE CONVEYED TO
THE CITY OF NEWPORT NEWS, VIRGINIA
BY
MID EASTERN COMPANY, L.C.
DATE: 3/17/08 SCALE: 1"=100'
REVISED: 11-24-08

LINE TABLE		
LINE	LENGTH	BEARING
L1	36.23'	S41°41'38"W
L2	49.78'	S22°19'03"E
L3	104.58'	S30°56'50"E
L4	103.01'	S06°08'40"E
L5	51.49'	S09°55'02"W
L6	106.76'	S51°44'31"W
L7	93.01'	S61°55'28"W
L8	121.92'	S86°37'57"W
L9	125.24'	S66°27'20"W
L10	75.64'	S81°42'23"W
L11	77.23'	S61°26'16"W

CURVE TABLE						
CURVE	ENGLH	RADIUS	TANGENT	CHORD	CHORD BEARING	DELTA
C1	391.64'	1213.00'	197.54'	389.94'	N23°06'34"W	18°29'57"
C2	313.63'	5704.58'	156.85'	313.59'	N77°42'55"E	3°09'00"

City of Williamsburg & County of James City
Circuit Court: This PLAT was recorded on
at 12:42 AM/PM. PB 12 PG 1
DOCUMENT # 090004712
BETSY B. WOOLRIDGE, CLERK
Betsy B. Woolridge Clerk

GRAPHIC SCALE



(IN FEET)
1" = 100'

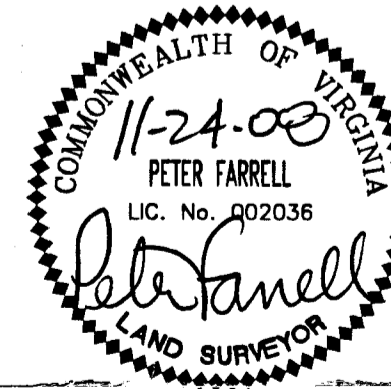

MINIMUM EXT. AGREEMENT NO. 094-FY2008
PRINT FILE N-11671

**LANDMARK
DESIGN GROUP**

Engineers • Planners • Surveyors
Landscape Architects • Environmental Consultants

4029 Ironbound Road
Suite 100
Williamsburg, VA 23188
Tel. (757) 253-2975
Fax (757) 229-0049
Email: lmdg@landmarkdg.com

5544 Greenwich Road
Suite 200
Virginia Beach, VA 23462
Tel. (757) 473-2000
Fax (757) 487-7933
Email: lmdg@landmarkdg.com