

LEGEND
 ■ GREENWAY AREA
 ▨ ROAD RIGHT-OF-WAYS
 □ INDICATES GREENWAY

GRAPHIC SCALE
 1000' 0' 1000' 2000'
 SCALE: 1" = 1000'

NOTE: REALTEC INCORPORATED AND/OR THEIR ASSIGNS HEREBY RESERVE EASEMENT OVER, UNDER AND THROUGH ALL THE LANDS OF THE FORD'S COLONY AT WILLIAMSBURG HOMEOWNERS ASSOCIATION SHOWN HEREON THAT MAY BE NECESSARY FROM TIME TO TIME TO EFFECT FURTHER DEVELOPMENT OF THE PROPERTY AND THE INSTALLATION OF SIGNAGE AND LANDSCAPING. FURTHERMORE, THE AFOREMENTIONED RESERVE THE RIGHT WITHIN SAID HOMEOWNERS' LANDS TO CONSTRUCT AND MAINTAIN ACCESSORY AMENITY BUILDINGS. SUCH PROPERTY IS ALSO SUBJECT TO THE EASEMENTS, RIGHTS AND LIMITATIONS DESCRIBED IN THE DECLARATION OF PROTECTIVE COVENANTS FOR FORD'S COLONY OR IN SUPPLEMENTS EXISTING PLATTED EASEMENTS FOR UTILITIES AND DRAINAGE OVER THE LANDS OF THE FORD'S COLONY AT WILLIAMSBURG HOMEOWNERS' ASSOCIATION SHOWN HEREON ARE NOT SHOWN FOR PURPOSES OF CLARITY, REFERENCE IS HEREBY MADE TO THE LAND RECORDS OF JAMES CITY COUNTY FOR MORE EXACT INFORMATION RELATING TO EASEMENT LOCATIONS AND USE.

AREA TABULATION OF THE LANDS OF THE FORD'S COLONY AT WILLIAMSBURG HOMEOWNER'S ASSOCIATION

PARCEL	WHERE RECORDED	DESCRIPTION	AREA
PARCELS 1 & 2	P.B. 81, PG. 7-9	GREENWAY	102.08 AC.±
PARCEL 3	P.B. 88, PG. 70-71	GREENWAY	21.61 AC.±
PARCEL 4 & 5	P.B. 88, PG. 72-76	GREENWAY	111.32 AC.±
TOTAL=			235.01 AC.±

SUMMARY OF PREVIOUS PLATS OF THE FORD'S COLONY AT WILLIAMSBURG HOMEOWNER'S ASSOCIATION

SECTION	WHERE RECORDED	
SECTION 1, 2, 4, 5	P.B. 46, PG. 79	D.B. 366, PG. 564
SECTION 3	P.B. 48, PG. 96	D.B. 395, PG. 787
SECTION 6, LOTS 1-117	P.B. 52, PG. 39	D.B. 477, PG. 35
SECTION 10	P.B. 52, PG. 38	D.B. 477, PG. 35
SECTION 6, LOTS 118-265;	P.B. 53, PG. 80	D.B. 504, PG. 124
SECTION 11A, LOTS 90-156		
SECTION 11A, LOTS 1-69	P.B. 54, PG. 87	D.B. 529, PG. 74
SECTION 7	P.B. 55, PG. 49	D.B. 548, PG. 299
SECTION 9A	P.B. 68, PG. 75-76	DOC. #980004672
SECTION 9B	P.B. 58, PG. 43	D.B. 647, PG. 395
SECTION 13B	P.B. 76, PG. 79	DOC. #000000
SECTION 13C, D, E	P.B. 61, PG. 56	D.B. 734, PG. 740
SECTION 13C	P.B. 68, PG. 75-76	DOC. #980004672
SECTION 16, LOTS 7-84	P.B. 68, PG. 75-76	DOC. #980004672
SECTION IIIB, LOTS 1-25	P.B. 76, PG. 51-52	DOC. #000002031
SECTION XVII, LOTS 1-46	P.B. 76, PG. 51-52	DOC. #000002031
SECTION XVII, LOTS 48-71	P.B. 76, PG. 51-52	DOC. #000002031
SECTION XVII, LOTS 1-32	P.B. 76, PG. 51-52	DOC. #000002031
SECTIONS I (BLOCK D), LOTS 1-5,9;(BLOCK F), LOTS 1-39;		
VII, LOTS 1-172; VIII, LOTS 1-35;		
VIII-B, LOTS 1-45; IX, LOTS 58-111;		
XI-A, LOTS 70-156; XIII-A, LOTS 1-41;		
XIII-B, LOTS 1-62; XIII-C, LOTS 1-34;		
XIV-A, LOTS 1-12; XIV-B, LOTS 1-56;		
XV, LOTS 1-12; XVI, LOTS 1-6,8,5;		
XVII, LOTS 1-14,31-32; XXXI,		
LOTS 1-81; XXXII, LOTS 1-71,79-92,		
130-134		
SECTION I (BLOCK D), LOTS 1-5,9; SECTION II, ST. ANDREWS DRIVE; SECTION III, LOTS 251-290, MAINTENANCE CENTER; SECTION VII; SECTION XIII-A, LOTS 1-41; SECTION XIII-B, LOTS 1-62; XIV-B, LOTS 1-56; XXXI-A, LOTS 1-35	P.B. 89, PG. 54-55	DOC. #030005477
SECTION XI-A, LOTS 1-69	P.B. 49, PG. 45-50	DOC. #040009115
	P.B. 55, PG. 2	
SECTION XII, LOTS 2-38,41-72	P.B. 90, PG. 23-25	DOC. #050010098
SECTION XII, LOTS 39 & 40	P.B. 90, PG. 47	DOC. #050010098

TOTAL AREA OF ROAD RIGHT-OF-WAYS (AS SUMMARIZED BY DOC. #050010098)	314.50 AC.±
TOTAL AREA OF GREENWAYS (AS SUMMARIZED BY DOC. #050010098)	135.16 AC.±
TOTAL AREA OF THE LANDS OF THE FORD'S COLONY AT WILLIAMSBURG HOMEOWNER'S ASSOCIATION	449.66 AC.±
TOTAL AREA TO DATE SUMMARY OF THE LANDS OF THE FORD'S COLONY AT WILLIAMSBURG HOMEOWNER'S ASSOCIATION (INCLUDES ALL PREVIOUS PLATS)	
TOTAL AREA OF ROAD RIGHT-OF-WAYS	314.50 AC.±
TOTAL AREA OF GREENWAYS	370.17 AC.±
TOTAL AREA OF THE LANDS OF THE FORD'S COLONY AT WILLIAMSBURG HOMEOWNER'S ASSOCIATION	684.67 AC.±

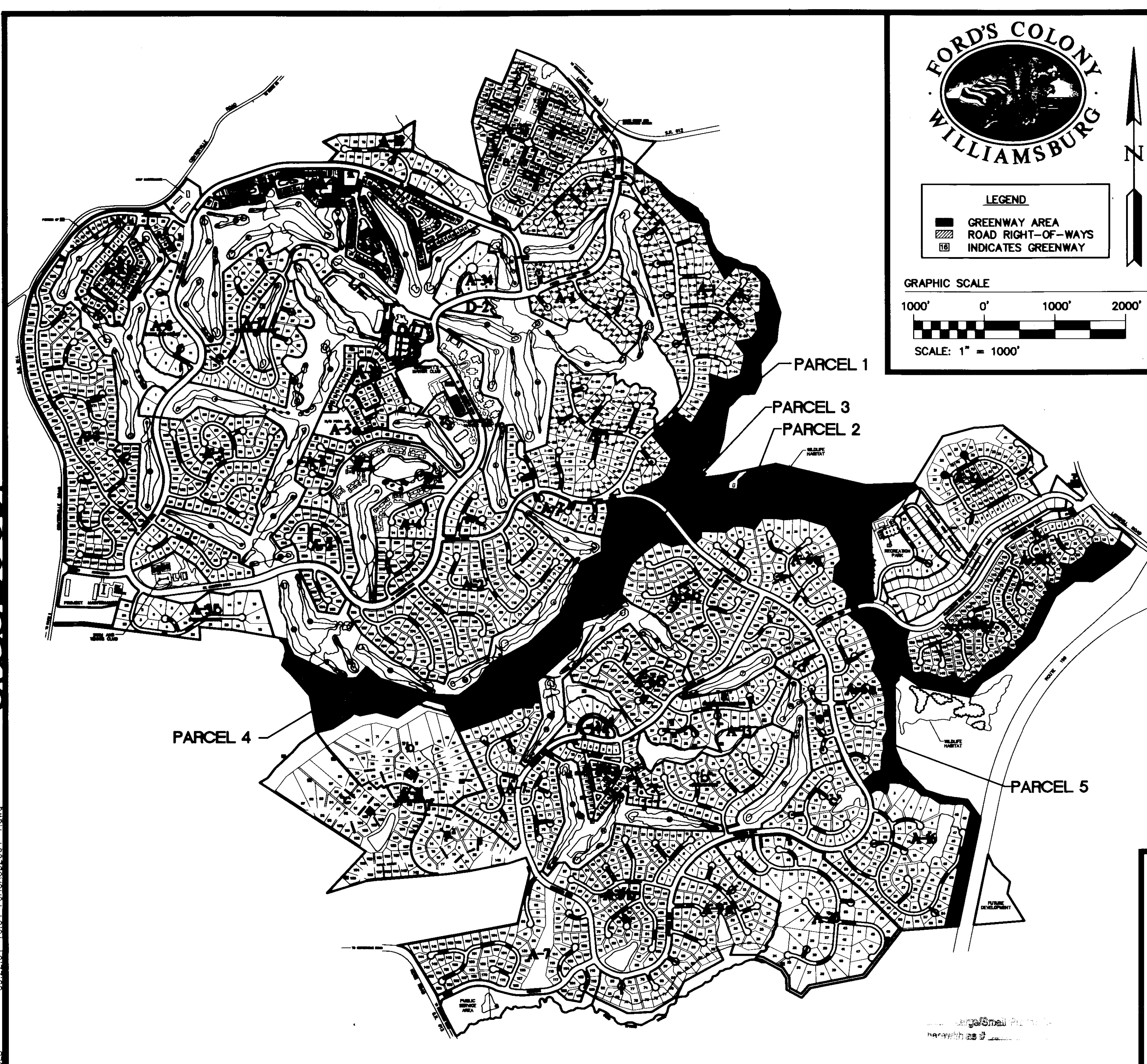

080025861

D.L.D. 09.22.04-16.04 EchoAc2004-1.dwg

CONSULTING ENGINEERS
 5248 Olde Towne Road, Suite 1
 Williamsburg, Virginia 23188
 (757) 253-0040
 Fax (757) 220-8994

MAP OF ADDITIONAL LANDS OF THE FORD'S COLONY AT WILLIAMSBURG HOMEOWNERS ASSOCIATION

POWhatan DISTRICT JAMES CITY COUNTY VIRGINIA

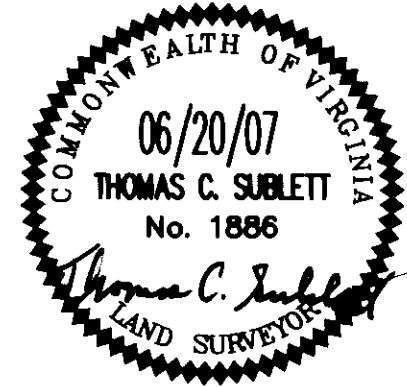

No.	DATE	REVISION / COMMENT / NOTE	BY

Designed CBR	Drawn MEG
Scale 1"=1000'	Date 6/20/07
Project No. 5652-96	
Drawing No. 1 OF 5	

City of Williamsburg & County of James City
 Circuit Court: This PLAT was recorded on
 21 October 2008
 at 10:45 AM/PM. PG. 1
 DOCUMENT # 080025861
 BETSY B. WOOLRIDGE, CLERK
 Betsy B. Woolridge Clerk

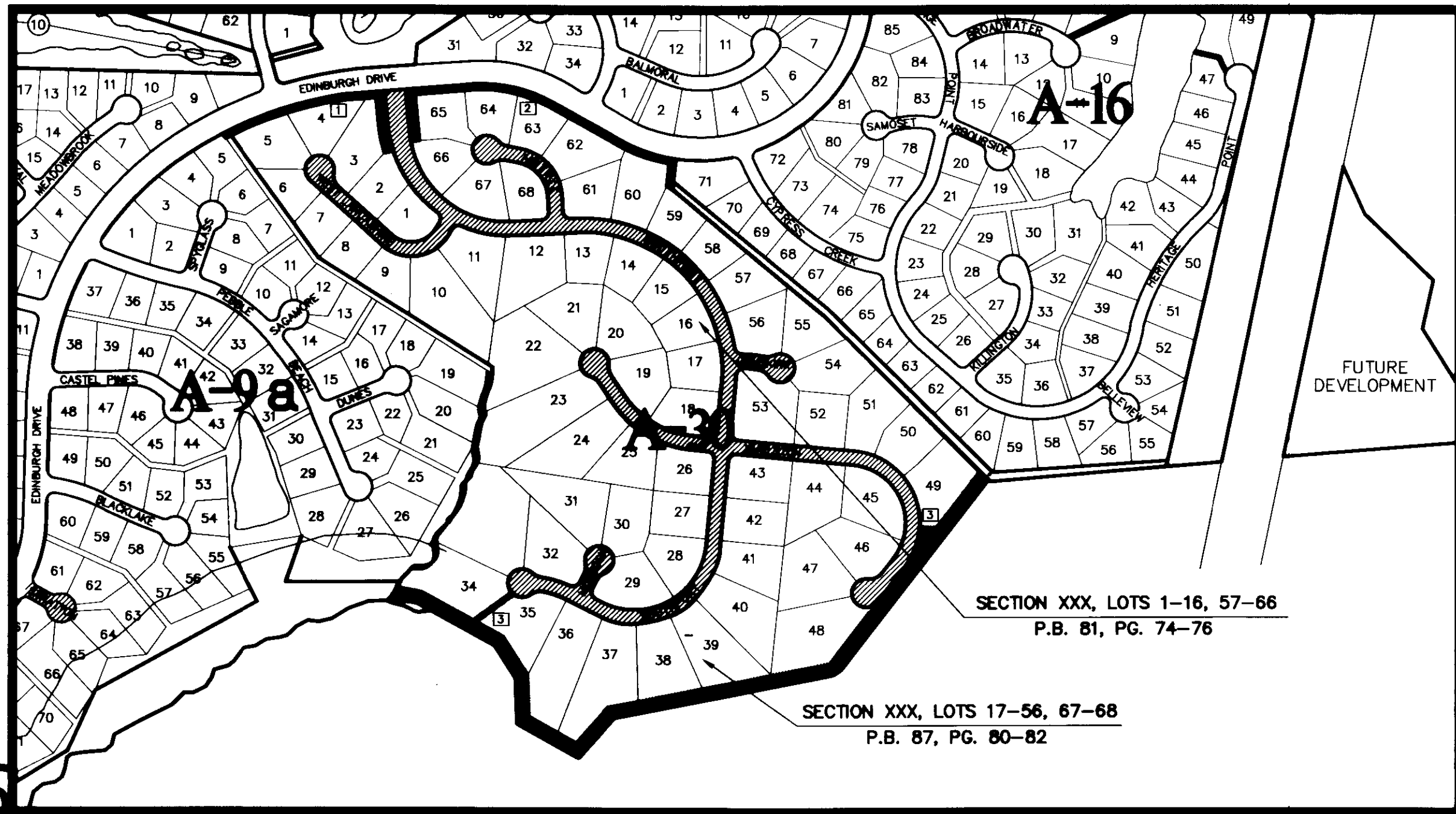

SECTION XXX, LOTS 1-16, 57-66
P.B. 81, PG. 74-76

SECTION XXX, LOTS 17-56, 67-68
P.B. 87, PG. 80-82

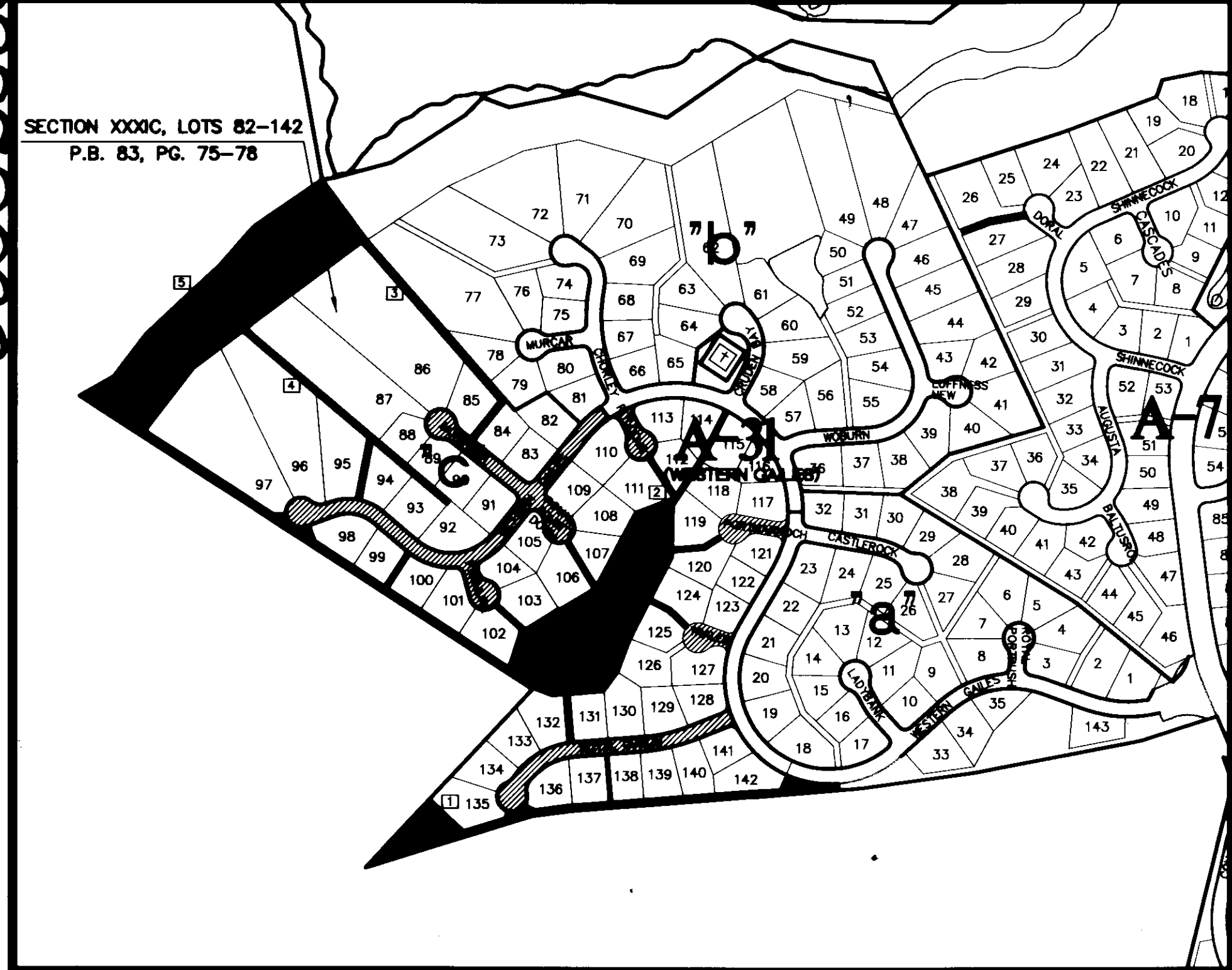

SECTION XXXC, LOTS 82-142
P.B. 83, PG. 75-78

AREA TABULATION OF THE LANDS OF THE FORD'S COLONY AT WILLIAMSBURG HOMEOWNER'S ASSOCIATION

SECTIONS XXX AND XXXC	WHERE RECORDED	DESCRIPTION	AREA
SECTION XXX	P.B. 81, PG. 74-76	GREENWAY	1.01 AC.±
LOTS 1-16, 57-66		RIGHT-OF-WAY	3.47 AC.±
LOTS 17-56, 67-68	P.B. 87, PG. 80-82	GREENWAY	3.26 AC.±
		RIGHT-OF-WAY	4.59 AC.±
SECTION XXXC	P.B. 83, PG. 75-78	GREENWAY	22.81 AC.±
LOTS 82-142		RIGHT-OF-WAY	4.62 AC.±
		TOTAL (GREENSPACE)=	27.08 AC.±
		TOTAL (RIGHT OF WAY)=	12.68 AC.±

* A PORTION OF GREENWAY PREVIOUSLY CONVEYED IN SECTION IXA "MAP OF ADDITIONAL LANDS" PLAT BOOK 68, PAGES 75-76, GREENWAY 1, HAS BEEN REDUCED BY (0.196 AC.) WITH THE SUBDIVISION OF LOT 5 AND GREENWAY HEREBY CONVEYED IN SECTION XXX. IN ADDITION A PORTION OF GREENWAY PREVIOUSLY CONVEYED IN SECTION XVI "MAP OF ADDITIONAL LANDS" PLAT BOOK 61, PAGE 56, GREENWAY 29, HAS BEEN REDUCED BY (1.095 AC.) WITH THE ADDITIONAL R/W, SUBDIVISION OF LOTS 3-5, 62-65 AND NEW GREENWAY HEREBY CONVEYED IN THE SECTION XXX.

REDUCTION IN GREENWAY 18 = -1.291 AC.±

SUMMARY OF PREVIOUS PLATS OF THE FORD'S COLONY AT WILLIAMSBURG HOMEOWNER'S ASSOCIATION

SECTION	WHERE RECORDED	WHERE RECORDED
SECTION 1, 2, 4, 5	P.B. 46, PG. 79	D.B. 366, PG. 564
SECTION 3	P.B. 48, PG. 96	D.B. 395, PG. 787
SECTION 6, LOTS 1-117	P.B. 52, PG. 39	D.B. 477, PG. 35
SECTION 10	P.B. 52, PG. 38	D.B. 477, PG. 35
SECTION 6, LOTS 118-265;	P.B. 53, PG. 80	D.B. 504, PG. 124
SECTION 11A, LOTS 70-156		
SECTION 11A, LOTS 1-69	P.B. 54, PG. 87	D.B. 529, PG. 74
SECTION 7	P.B. 55, PG. 49	D.B. 548, PG. 299
SECTION 9A	P.B. 68, PG. 75-76	DOC. #980004672
SECTION 9B	P.B. 58, PG. 43	D.B. 647, PG. 395
SECTION 13B	P.B. 76, PG. 79	DOC. #000000
SECTION 13C, D, E	P.B. 61, PG. 56	D.B. 734, PG. 740
SECTION 13C	P.B. 68, PG. 75-76	DOC. #980004672
SECTION 16, LOTS 7-84	P.B. 68, PG. 75-76	DOC. #980004672
SECTION 11B, LOTS 1-25	P.B. 76, PG. 51-52	DOC. #000002031
SECTION XVII, LOTS 1-46	P.B. 76, PG. 51-52	DOC. #000002031
SECTION XVII, LOTS 48-71	P.B. 76, PG. 51-52	DOC. #000002031
SECTION XVII, LOTS 1-32	P.B. 76, PG. 51-52	DOC. #000002031
SECTIONS I (BLOCK D), LOTS 1-5,9;(BLOCK F), LOTS 1-39;		
VII, LOTS 1-172; VIII, LOTS 1-35;		
VIII-B, LOTS 1-45; IX, LOTS 58-111;		
XI-A, LOTS 70-156; XIII-A, LOTS 1-41;		
XIII-B, LOTS 1-62; XIII-C, LOTS 1-34;		
XIV-A, LOTS 1-12; XIV-B, LOTS 1-56;		
XV, LOTS 1-12; XVI, LOTS 1-6,85;		
XVIII, LOTS 1-14,31-32; XXI,		
LOTS 1-81; XXII, LOTS 1-71,79-92,		
130-134		
SECTION I (BLOCK D), LOTS 1-5,9;	P.B. 89, PG. 54-55	DOC. #030005477
SECTION II, ST. ANDREWS DRIVE;		
SECTION III, LOTS 251-290,		
MAINTENANCE CENTER; SECTION VI;		
SECTION XIII-A, LOTS 1-41; SECTION		
XIII-B, LOTS 1-62; XIV-B, LOTS 1-56;		
XXXI-A, LOTS 1-35		
SECTION XI-A, LOTS 1-69	P.B. 49, PG. 45-50	DOC. #040009115
	P.B. 55, PG. 2	
SECTION XII, LOTS 2-38,41-72	P.B. 90, PG. 23-25	DOC. #050010098
SECTION XII, LOTS 39 & 40	P.B. 90, PG. 47	DOC. #050010098
OPEN SPACE ADJACENT TO POWHATAN CREEK, LONGHILL SWAMP, AND CHISEL RUN (PARCELS 1-5)	P.B. 81, PG. 7-9	AES PLAT DATED 3-30-05
	P.B. 88, PG. 70-71	AES PLAT DATED 3-30-05
	P.B. 88, PG. 72-76	AES PLAT DATED 3-30-05

NOTE: REALTEC INCORPORATED AND/OR THEIR ASSIGNS HEREBY RESERVE EASEMENT OVER, UNDER AND THROUGH ALL THE LANDS OF THE FORD'S COLONY AT WILLIAMSBURG HOMEOWNERS ASSOCIATION SHOWN HEREON THAT MAY BE NECESSARY FROM TIME TO TIME TO EFFECT FURTHER DEVELOPMENT OF THE PROPERTY AND THE INSTALLATION OF SIGNAGE AND LANDSCAPING. FURTHERMORE, THE AFOREMENTIONED RESERVE THE RIGHT WITHIN SAID HOMEOWNERS' LANDS TO CONSTRUCT AND MAINTAIN ACCESSORY AMENITY BUILDINGS. SUCH PROPERTY IS ALSO SUBJECT TO THE EASEMENTS, RIGHTS AND LIMITATIONS DESCRIBED IN THE DECLARATION OF PROTECTIVE COVENANTS FOR FORD'S COLONY OR IN SUPPLEMENTS

EXISTING PLATTED EASEMENTS FOR UTILITIES AND DRAINAGE OVER THE LANDS OF THE FORD'S COLONY AT WILLIAMSBURG HOMEOWNERS' ASSOCIATION SHOWN HEREON ARE NOT SHOWN FOR PURPOSES OF CLARITY. REFERENCE IS HEREBY MADE TO THE LAND RECORDS OF JAMES CITY COUNTY FOR MORE EXACT INFORMATION RELATING TO EASEMENT LOCATIONS AND USE.

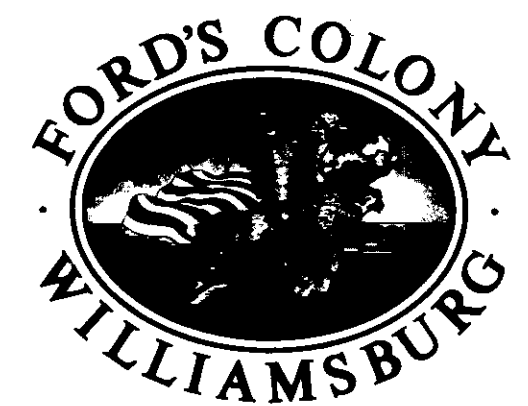

LEGEND

	GREENWAY AREA
	ROAD RIGHT-OF-WAYS
	INDICATES GREENWAY

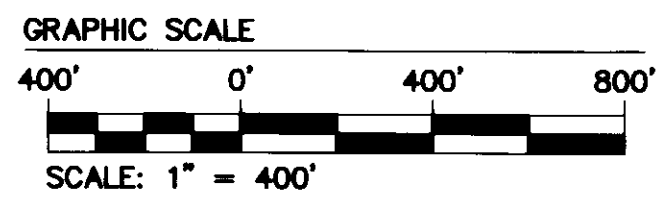

TOTAL AREA OF ROAD RIGHT-OF-WAYS (AS SUMMARIZED BY AES PLAT DATED 3-30-05)	314.50 AC.±
TOTAL AREA OF GREENWAYS (AS SUMMARIZED BY AES PLAT DATED 3-30-05)	370.17 AC.±
TOTAL AREA OF THE LANDS OF THE FORD'S COLONY AT WILLIAMSBURG HOMEOWNER'S ASSOCIATION	684.67 AC.±

TOTAL AREA TO DATE SUMMARY OF THE LANDS OF THE FORD'S COLONY AT WILLIAMSBURG HOMEOWNER'S ASSOCIATION (INCLUDES ALL PREVIOUS PLATS)

TOTAL AREA OF ROAD RIGHT-OF-WAYS	327.18 AC.±
TOTAL AREA OF GREENWAYS	397.25 AC.±
TOTAL AREA OF THE LANDS OF THE FORD'S COLONY AT WILLIAMSBURG HOMEOWNER'S ASSOCIATION	724.43 AC.±

080025861

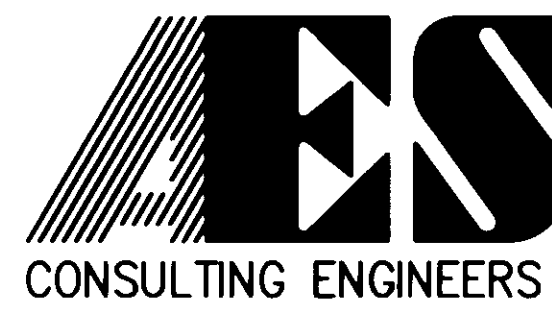

5248 Olde Towne Road, Suite 1
Williamsburg, Virginia 23188
(757) 253-0040
Fax (757) 220-8994

MAP OF ADDITIONAL LANDS OF THE FORD'S COLONY

WILLIAMSBURG
HOMEOWNERS ASSOCIATION

POWHATAN DISTRICT JAMES CITY COUNTY VIRGINIA

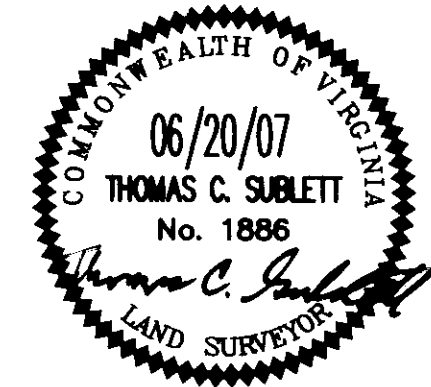

No.	DATE	REVISION / COMMENT / NOTE	BY

Designed CBR	Drawn MEG
Scale 1"=400'	Date 6/20/07
Project No. 5652-96	
Drawing No. 2 OF 5	

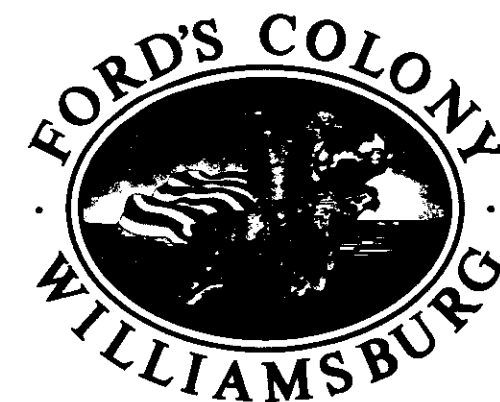

LEGEND

■ GREENWAY AREA
 ▨ ROAD RIGHT-OF-WAYS
 (16) INDICATES GREENWAY

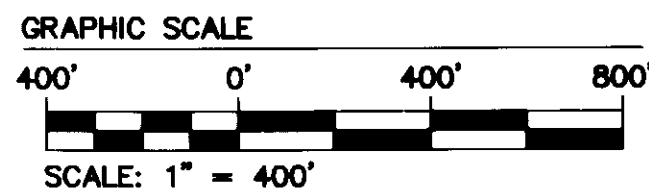

NOTE: REALTEC INCORPORATED AND/OR THEIR ASSIGNS HEREBY RESERVE EASEMENT OVER, UNDER AND THROUGH ALL THE LANDS OF THE FORD'S COLONY AT WILLIAMSBURG HOMEOWNERS ASSOCIATION SHOWN HEREON THAT MAY BE NECESSARY FROM TIME TO TIME TO EFFECT FURTHER DEVELOPMENT OF THE PROPERTY AND THE INSTALLATION OF SIGNAGE AND LANDSCAPING. FURTHERMORE, THE AFORESAID RESERVE THE RIGHT WITHIN SAID HOMEOWNERS' LANDS TO CONSTRUCT AND MAINTAIN ACCESSORY AMENITY BUILDINGS. SUCH PROPERTY IS ALSO SUBJECT TO THE EASEMENTS, RIGHTS AND LIMITATIONS DESCRIBED IN THE DECLARATION OF PROTECTIVE COVENANTS FOR FORD'S COLONY OR IN SUPPLEMENTS

EXISTING PLATTED EASEMENTS FOR UTILITIES AND DRAINAGE OVER THE LANDS OF THE FORD'S COLONY AT WILLIAMSBURG HOMEOWNERS ASSOCIATION SHOWN HEREON ARE NOT SHOWN FOR PURPOSES OF CLARITY. REFERENCE IS HEREBY MADE TO THE LAND RECORDS OF JAMES CITY COUNTY FOR MORE EXACT INFORMATION RELATING TO EASEMENT LOCATIONS AND USE.

AREA TABULATION OF THE LANDS OF THE FORD'S COLONY @ WILLIAMSBURG HOMEOWNERS ASSOCIATION

SECTION	WHERE RECORDED	DESCRIPTION	AREA
SECTION XXXIII LOTS 1-50	DOC. #050008649	GREENWAY	0.34 AC.±
SECTION XXXIV LOTS 1-9	DOC. #050008676	RIGHT-OF-WAY	5.02 AC.±
		GREENWAY	0.00 AC.±
		RIGHT-OF-WAY	0.92 AC.±
		TOTAL GREENWAY:	0.34 AC.±
		TOTAL RIGHT OF WAY:	5.94 AC.±

SUMMARY OF PREVIOUS PLATS OF THE FORD'S COLONY AT WILLIAMSBURG HOMEOWNERS ASSOCIATION

SECTION	WHERE RECORDED	DESCRIPTION
SECTION 1, 2, 4, 5	P.B. 46, PG. 79	D.B. 366, PG. 564
SECTION 3	P.B. 48, PG. 96	D.B. 395, PG. 787
SECTION 6, LOTS 1-117	P.B. 52, PG. 39	D.B. 477, PG. 35
SECTION 10	P.B. 52, PG. 38	D.B. 477, PG. 35
SECTION 6, LOTS 118-285; SECTION 11A, LOTS 70-158	P.B. 53, PG. 80	D.B. 504, PG. 124
SECTION 11A, LOTS 1-69	P.B. 54, PG. 87	D.B. 529, PG. 74
SECTION 7	P.B. 55, PG. 49	D.B. 548, PG. 299
SECTION 9A	P.B. 68, PG. 75-78	DOC. #080004672
SECTION 9B	P.B. 58, PG. 43	D.B. 647, PG. 395
SECTION 13B	P.B. 78, PG. 79	DOC. #000000
SECTION 13C, D, E	P.B. 81, PG. 56	D.B. 734, PG. 740
SECTION 13C	P.B. 88, PG. 75-78	DOC. #080004672
SECTION 16, LOTS 7-84	P.B. 88, PG. 75-78	DOC. #080004672
SECTION 18B, LOTS 1-25	P.B. 76, PG. 51-52	DOC. #000002031
SECTION XVII, LOTS 1-46	P.B. 76, PG. 51-52	DOC. #000002031
SECTION XVII, LOTS 48-71	P.B. 76, PG. 51-52	DOC. #000002031
SECTION XVII, LOTS 1-32	P.B. 76, PG. 51-52	DOC. #000002031
SECTIONS (BLOCK D), LOTS 1-5, 8; (BLOCK F), LOTS 1-30; VI, LOTS 1-172; VII, LOTS 1-35; VIII-B, LOTS 1-45; IX, LOTS 56-111; XI-A, LOTS 70-196; XII-A, LOTS 1-41; XIII-B, LOTS 1-82; XIII-C, LOTS 1-34; XIV-A, LOTS 1-12; XIV-B, LOTS 1-56; XV, LOTS 1-12; XVI, LOTS 1-8, 85; XVII, LOTS 1-14, 31-32; XXXI, LOTS 1-81; XXXII, LOTS 1-71, 79-92, 130-134	P.B. 88, PG. 40-42	INST. #020026590
SECTION (BLOCK D), LOTS 1-5, 8; SECTION II, ST. ANDREWS DRIVE; SECTION III, LOTS 251-290, MAINTENANCE CENTER; SECTION VI; SECTION XII-A, LOTS 1-41; SECTION XII-B, LOTS 1-82; XIV-B, LOTS 1-56; XXXI-A, LOTS 1-35	P.B. 89, PG. 54-55	DOC. #030005477
SECTION XI, LOTS 1-69	P.B. 49, PG. 45-50	DOC. #040009115
SECTION XII, LOTS 2-36, 41-72	P.B. 55, PG. 2	DOC. #050010088
SECTION XII, LOTS 39 & 40	P.B. 90, PG. 23-25	DOC. #050010088
OPEN SPACE ADJACENT TO POWHATAN CREEK, LONGHILL SWAMP, AND CHISEL RUN (PARCELS 1-5)	P.B. 81, PG. 7-9	AES PLAT DATED 3-30-05
SECTION XXX, LOTS 1-16, 57-66	P.B. 88, PG. 70-71	AES PLAT DATED 3-30-05
SECTION XXX, LOTS 17-56, 67-86	P.B. 88, PG. 72-76	AES PLAT DATED 3-30-05
SECTION XXXC, LOTS 82-142	P.B. 81, PG. 74-76	AES PLAT DATED 3-30-05
	P.B. 87, PG. 80-82	AES PLAT DATED 3-30-05
	P.B. 83, PG. 75-78	AES PLAT DATED 3-30-05

TOTAL AREA OF ROAD RIGHT-OF-WAYS (AS SUMMARIZED BY AES PLAT DATED 3-30-05) 327.18 AC.±

TOTAL AREA OF GREENWAYS (AS SUMMARIZED BY AES PLAT DATED 3-30-05) 387.25 AC.±

TOTAL AREA OF THE LANDS OF THE FORD'S COLONY AT WILLIAMSBURG HOMEOWNERS ASSOCIATION 724.43 AC.±

TOTAL AREA TO DATE SUMMARY OF THE LANDS OF THE FORD'S COLONY AT WILLIAMSBURG HOMEOWNERS ASSOCIATION (INCLUDES ALL PREVIOUS PLATS)

TOTAL AREA OF ROAD RIGHT-OF-WAYS 333.12 AC.±

TOTAL AREA OF GREENWAYS 387.50 AC.±

TOTAL AREA OF THE LANDS OF THE FORD'S COLONY AT WILLIAMSBURG HOMEOWNERS ASSOCIATION 730.71 AC.±

080025861

09.24.04-10.31 F:\H\AC\2004-2.dwg

D.L.D.

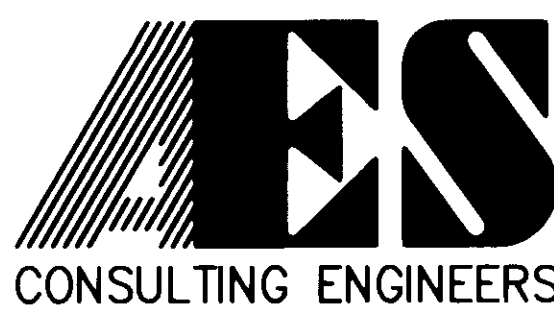

5248 Olde Towne Road, Suite 1
 Williamsburg, Virginia 23188
 (757) 253-0040
 Fax (757) 220-8994

MAP OF ADDITIONAL LANDS OF
THE FORD'S COLONY
 WILLIAMSBURG
 HOMEOWNERS ASSOCIATION

POWHATAN DISTRICT JAMES CITY COUNTY VIRGINIA

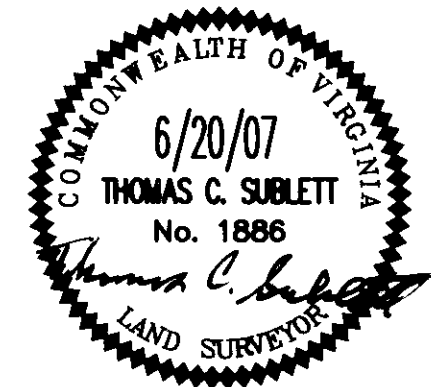

No.	DATE	REVISION / COMMENT / NOTE	BY

Designed	Drawn
CBR	MEG
Scale	Date
1" = 400'	6/20/07
Project No.	
5652-96	
Drawing No.	
3 OF 5	

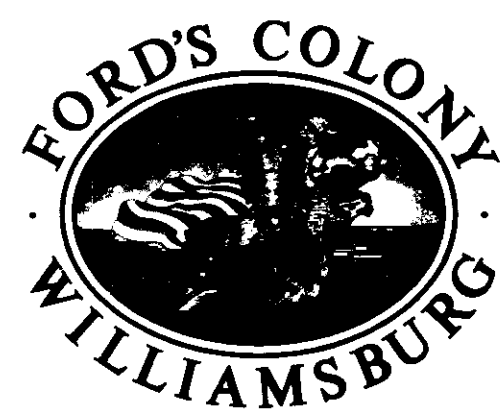
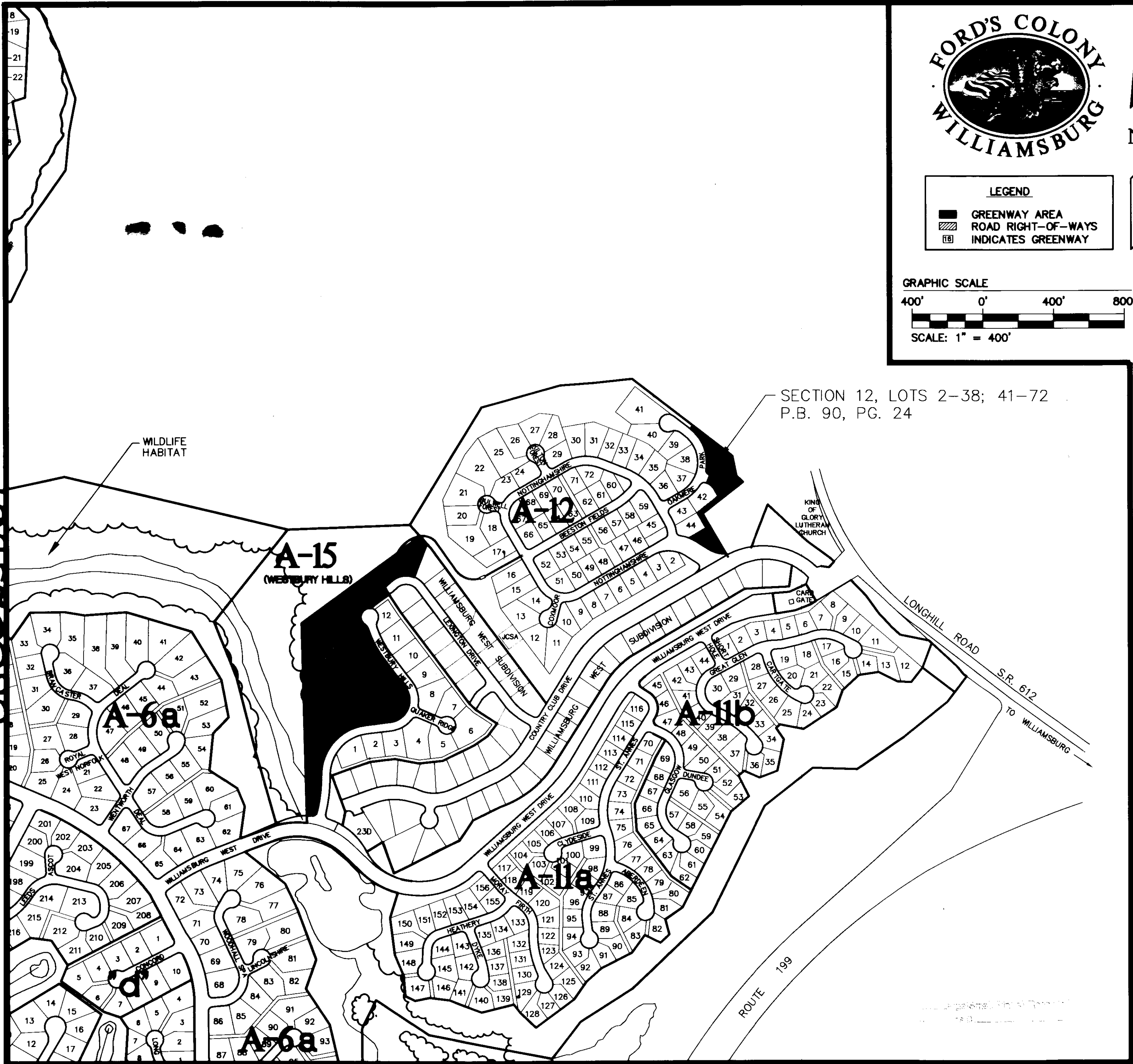

LEGEND

- GREENWAY AREA
- ROAD RIGHT-OF-WAYS
- INDICATES GREENWAY

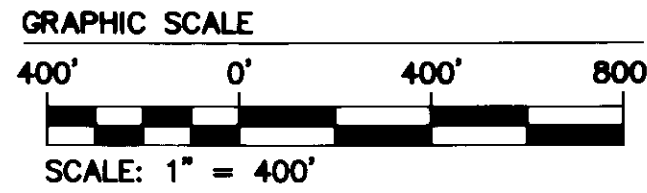

NOTE: REALTEC INCORPORATED AND/OR THEIR ASSIGNS HEREBY RESERVE EASEMENT OVER, UNDER AND THROUGH ALL THE LANDS OF THE FORD'S COLONY AT WILLIAMSBURG HOMEOWNERS ASSOCIATION SHOWN HEREON THAT MAY BE NECESSARY FROM TIME TO TIME TO EFFECT FURTHER DEVELOPMENT OF THE PROPERTY AND THE INSTALLATION OF SIGNAGE AND LANDSCAPING. FURTHERMORE, THE AFORESAIDED RESERVE THE RIGHT WITHIN SAID HOMEOWNERS' LANDS TO CONSTRUCT AND MAINTAIN ACCESSORY AMENITY BUILDINGS. SUCH PROPERTY IS ALSO SUBJECT TO THE EASEMENTS, RIGHTS AND LIMITATIONS DESCRIBED IN THE DECLARATION OF PROTECTIVE COVENANTS FOR FORD'S COLONY OR IN SUPPLEMENTS EXISTING PLATTED EASEMENTS FOR UTILITIES AND DRAINAGE OVER THE LANDS OF THE FORD'S COLONY AT WILLIAMSBURG HOMEOWNERS ASSOCIATION SHOWN HEREON ARE NOT SHOWN FOR PURPOSES OF CLARITY, REFERENCE IS HEREBY MADE TO THE LAND RECORDS OF JAMES CITY COUNTY FOR MORE EXACT INFORMATION RELATING TO EASEMENT LOCATIONS AND USE.

AREA TABULATION OF THE LANDS OF THE FORD'S COLONY AT WILLIAMSBURG HOMEOWNERS ASSOCIATION

OPEN SPACE ADJACENT TO WESTBURY HILLS

PARCEL	WHERE RECORDED	DESCRIPTION	AREA
PARCEL 1	P.B. 79, PG. 43-44	GREENWAY	11.73 AC.±
SECTION 12, LOTS 2-38 & LOTS 41-72	P.B. 90, PG. 24	GREENWAY	1.54 AC.±
TOTAL GREENWAY			13.27 AC.±

SUMMARY OF PREVIOUS PLATS OF THE FORD'S COLONY AT WILLIAMSBURG HOMEOWNERS ASSOCIATION

SECTION	WHERE RECORDED	DESCRIPTION
SECTION 1, 2, 4, 5	P.B. 46, PG. 79	D.B. 366, PG. 564
SECTION 3	P.B. 48, PG. 96	D.B. 395, PG. 787
SECTION 6, LOTS 1-117	P.B. 52, PG. 39	D.B. 477, PG. 35
SECTION 10	P.B. 52, PG. 38	D.B. 477, PG. 35
SECTION 6, LOTS 118-265; SECTION 11A, LOTS 70-156	P.B. 53, PG. 80	D.B. 504, PG. 124
SECTION 11A, LOTS 1-69	P.B. 54, PG. 87	D.B. 529, PG. 74
SECTION 7	P.B. 55, PG. 49	D.B. 548, PG. 299
SECTION 9A	P.B. 68, PG. 75-76	DOC. #980004672
SECTION 9B	P.B. 58, PG. 43	D.B. 647, PG. 395
SECTION 13B	P.B. 76, PG. 79	DOC. #000000
SECTION 13C, D, E	P.B. 61, PG. 56	D.B. 734, PG. 740
SECTION 13C	P.B. 68, PG. 75-76	DOC. #980004672
SECTION 16, LOTS 7-84	P.B. 68, PG. 75-76	DOC. #980004672
SECTION III B, LOTS 1-25	P.B. 76, PG. 51-52	DOC. #000002031
SECTION XVII, LOTS 1-46	P.B. 76, PG. 51-52	DOC. #000002031
SECTION XVII, LOTS 48-71	P.B. 76, PG. 51-52	DOC. #000002031
SECTION XVIII, LOTS 1-32	P.B. 76, PG. 51-52	DOC. #000002031
SECTIONS I (BLOCK D), LOTS 1-5, 9; I (BLOCK F), LOTS 1-39; VII, LOTS 1-172; VIII, LOTS 1-35; VII-B, LOTS 1-45; IX, LOTS 58-111; XI-A, LOTS 70-156; XII-A, LOTS 1-41; XIII-B, LOTS 1-62; XIII-C, LOTS 1-34; XIV-A, LOTS 1-12; XIV-B, LOTS 1-56; XV, LOTS 1-12; XVI, LOTS 1-6, 8, 5; XVIII, LOTS 1-14, 31-32; XXXI, LOTS 1-81; XXXII, LOTS 1-71, 79-92, 130-134	P.B. 88, PG. 40-42	INST. #020026590
SECTION II (BLOCK D), LOTS 1-5, 9; SECTION II, ST. ANDREWS DRIVE; SECTION III, LOTS 251-290, MAINTENANCE CENTER; SECTION VII; SECTION XIII-A, LOTS 1-41; SECTION XIII-B, LOTS 1-62; XIV-B, LOTS 1-56; XXXI-A, LOTS 1-35	P.B. 89, PG. 54-55	DOC. #030005477
SECTION XI-A, LOTS 1-69	P.B. 49, PG. 45-50	DOC. #040009115
SECTION XII, LOTS 2-38, 41-72	P.B. 55, PG. 2	
SECTION XII, LOTS 39 & 40	P.B. 90, PG. 23-25	DOC. #050010098
OPEN SPACE ADJACENT TO POWHATAN CREEK, LONGHILL SWAMP, AND CHISEL RUN (PARCELS 1-5)	P.B. 81, PG. 7-9	AES PLAT DATED 3-30-05
SECTION XXX, LOTS 1-16, 57-66	P.B. 88, PG. 70-71	AES PLAT DATED 3-30-05
SECTION XXX, LOTS 17-56, 67-88	P.B. 88, PG. 72-76	AES PLAT DATED 3-30-05
SECTION XXXI, LOTS 82-142	P.B. 81, PG. 74-76	AES PLAT DATED 3-30-05
SECTION XXXII, LOTS 1-50	P.B. 87, PG. 80-82	AES PLAT DATED 3-30-05
	P.B. 83, PG. 75-78	AES PLAT DATED 3-30-05
	DOC. #050009649	AES PLAT DATED 10-14-05
TOTAL AREA OF ROAD RIGHT-OF-WAYS (AS SUMMARIZED BY AES PLAT DATED 10-14-05)		333.12 AC.±
TOTAL AREA OF GREENWAYS (AS SUMMARIZED BY AES PLAT DATED 10-14-05)		397.59 AC.±
TOTAL AREA OF THE LANDS OF THE FORD'S COLONY AT WILLIAMSBURG HOMEOWNERS ASSOCIATION		730.71 AC.±
TOTAL AREA TO DATE SUMMARY OF THE LANDS OF THE FORD'S COLONY AT WILLIAMSBURG HOMEOWNERS ASSOCIATION (INCLUDES ALL PREVIOUS PLATS)		
TOTAL AREA OF ROAD RIGHT-OF-WAYS		333.12 AC.±
TOTAL AREA OF GREENWAYS		410.86 AC.±
TOTAL AREA OF THE LANDS OF THE FORD'S COLONY AT WILLIAMSBURG HOMEOWNERS ASSOCIATION		743.98 AC.±

080025861

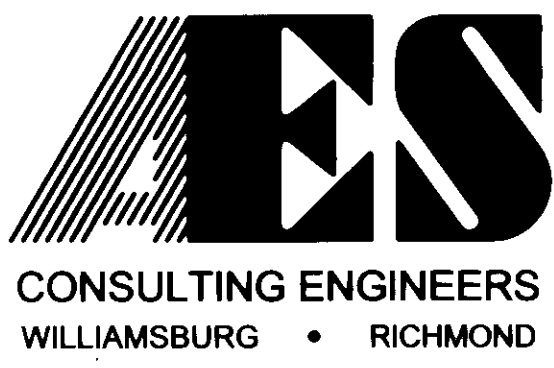

5248 Olde Towne Road, Suite 1
Williamsburg, Virginia 23188
(757) 253-0040
Fax (757) 220-8994

MAP OF ADDITIONAL LANDS OF THE FORD'S COLONY

WILLIAMSBURG HOMEOWNERS ASSOCIATION

POWHATAN DISTRICT JAMES CITY COUNTY VIRGINIA

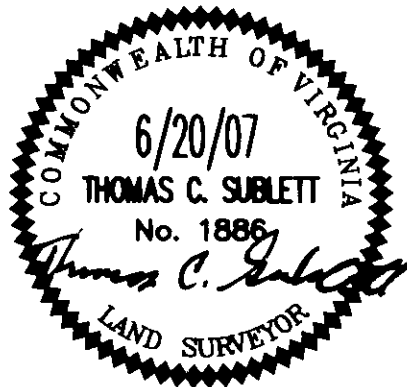

No.	DATE	REVISION / COMMENT / NOTE	BY

Designed	Drawn
TCS	MEG
Scale	Date
1"=400'	6/20/07
Project No.	
5652-96	
Drawing No.	
4 OF 5	

City of Williamsburg & County of James City Circuit Court: This PLAT was recorded on 21 October 2008 at 10:45 AM/PM, PG. DOCUMENT # 080025861 BETSY B. WOOLRIDGE, CLERK Betsy B. Woolridge Clerk

NOTE:
 REALTEC INCORPORATED AND/OR THEIR ASSIGNS HEREBY RESERVE EASEMENT OVER, UNDER AND THROUGH ALL THE LANDS OF THE FORD'S COLONY AT WILLIAMSBURG HOMEOWNERS ASSOCIATION SHOWN HEREON THAT MAY BE NECESSARY FROM TIME TO TIME TO EFFECT FURTHER DEVELOPMENT OF THE PROPERTY AND THE INSTALLATION OF SIGNAGE AND LANDSCAPING. FURTHERMORE, THE AFORESAID RESERVE THE RIGHT WITHIN SAID HOMEOWNERS' LANDS TO CONSTRUCT AND MAINTAIN ACCESSORY AMENITY BUILDINGS. SUCH PROPERTY IS ALSO SUBJECT TO THE EASEMENTS, RIGHTS AND LIMITATIONS DESCRIBED IN THE DECLARATION OF PROTECTIVE COVENANTS FOR FORD'S COLONY OR IN SUPPLEMENTS

EXISTING PLATTED EASEMENTS FOR UTILITIES AND DRAINAGE OVER THE LANDS OF THE FORD'S COLONY AT WILLIAMSBURG HOMEOWNERS' ASSOCIATION SHOWN HEREON ARE NOT SHOWN FOR PURPOSES OF CLARITY. REFERENCE IS HEREBY MADE TO THE LAND RECORDS OF JAMES CITY COUNTY FOR MORE EXACT INFORMATION RELATING TO EASEMENT LOCATIONS AND USE.

AREA TABULATION OF THE LANDS OF THE FORD'S COLONY AT WILLIAMSBURG HOMEOWNER'S ASSOCIATION

OPEN SPACE ADJACENT TO WESTBURY HILLS

PARCEL	WHERE RECORDED	DESCRIPTION	AREA
SECTION 32	P.B. 78, PG. 73-76	GREENWAY	8.78 AC.±
		RIGHT-OF-WAY	3.71 AC.±

SUMMARY OF PREVIOUS PLATS OF THE FORD'S COLONY AT WILLIAMSBURG HOMEOWNER'S ASSOCIATION

SECTION	WHERE RECORDED	DESCRIPTION
SECTION 1, 2, 4, 5	P.B. 46, PG. 79	D.B. 366, PG. 564
SECTION 3	P.B. 48, PG. 96	D.B. 395, PG. 787
SECTION 6, LOTS 1-117	P.B. 52, PG. 39	D.B. 477, PG. 35
SECTION 10	P.B. 52, PG. 38	D.B. 477, PG. 35
SECTION 6, LOTS 118-265;	P.B. 53, PG. 80	D.B. 504, PG. 124
SECTION 11A, LOTS 70-156		
SECTION 11A, LOTS 1-89	P.B. 54, PG. 87	D.B. 529, PG. 74
SECTION 7	P.B. 55, PG. 49	D.B. 548, PG. 299
SECTION 9A	P.B. 68, PG. 75-76	DOC. #980004672
SECTION 9B	P.B. 58, PG. 43	D.B. 647, PG. 395
SECTION 13B	P.B. 76, PG. 79	DOC. #00000
SECTION 13C, D, E	P.B. 61, PG. 56	D.B. 734, PG. 740
SECTION 13C	P.B. 68, PG. 75-76	DOC. #980004672
SECTION 16, LOTS 7-84	P.B. 68, PG. 75-76	DOC. #980004672
SECTION 11B, LOTS 1-25	P.B. 76, PG. 51-52	DOC. #000002031
SECTION XVII, LOTS 1-46	P.B. 76, PG. 51-52	DOC. #000002031
SECTION XVII, LOTS 48-71	P.B. 76, PG. 51-52	DOC. #000002031
SECTION XVIII, LOTS 1-32	P.B. 76, PG. 51-52	DOC. #000002031
SECTIONS I (BLOCK D), LOTS 1-5,9;(BLOCK F), LOTS 1-39;		
VII, LOTS 1-172;VIII, LOTS 1-35;		
VIII-B, LOTS 1-45;IX, LOTS 58-111;		
XI-A, LOTS 70-156;XIII-A, LOTS 1-41;		
XIII-B, LOTS 1-62;XIII-C, LOTS 1-34;		
XIV-A, LOTS 1-12;XIV-B, LOTS 1-56;		
XV, LOTS 1-12;XVI, LOTS 1-6,85;		
XVIII, LOTS 1-14,31-32;XXI, LOTS 1-81;XXII, LOTS 1-71,79-92, 130-134	P.B. 88, PG. 40-42	INST. #020026590
SECTION I (BLOCK D), LOTS 1-5,9;(BLOCK F), LOTS 1-39;	P.B. 89, PG. 54-55	DOC. #030005477
SECTION II, ST. ANDREWS DRIVE; SECTION III, LOTS 251-290, MAINTENANCE CENTER; SECTION VI; SECTION XIII-A, LOTS 1-41; SECTION XIII-B, LOTS 1-62; XIV-B, LOTS 1-56; XXXI-A, LOTS 1-35		
SECTION XI-A, LOTS 1-69	P.B. 49, PG. 45-50	DOC. #040009115
	P.B. 55, PG. 2	
SECTION XII, LOTS 2-38,41-72	P.B. 90, PG. 23-25	DOC. #050010098
SECTION XII, LOTS 39 & 40	P.B. 90, PG. 47	DOC. #050010098
OPEN SPACE ADJACENT TO POWHATAN CREEK, LONGHILL SWAMP, AND CHISEL RUN (PARCELS 1-5)	P.B. 81, PG. 7-9	AES PLAT DATED 3-30-05
	P.B. 88, PG. 70-71	AES PLAT DATED 3-30-05
	P.B. 88, PG. 72-76	AES PLAT DATED 3-30-05
SECTION XXX, LOTS 1-16,57-66	P.B. 81, PG. 74-76	AES PLAT DATED 3-30-05
SECTION XXX,	P.B. 87, PG. 80-82	AES PLAT DATED 3-30-05
SECTION XXXIC, LOTS 82-142	P.B. 83, PG. 75-78	AES PLAT DATED 3-30-05
SECTION XXXIII, LOTS 1-50	DOC. #050009649	AES PLAT DATED 10-14-05

TOTAL AREA OF ROAD RIGHT-OF-WAYS (AS SUMMARIZED BY AES PLAT DATED 10-14-05) 333.12 AC.±

TOTAL AREA OF GREENWAYS (AS SUMMARIZED BY AES PLAT DATED 10-14-05) 410.86 AC.±

TOTAL AREA OF THE LANDS OF THE FORD'S COLONY AT WILLIAMSBURG HOMEOWNER'S ASSOCIATION 743.98 AC.±

TOTAL AREA TO DATE SUMMARY OF THE LANDS OF THE FORD'S COLONY AT WILLIAMSBURG HOMEOWNER'S ASSOCIATION (INCLUDES ALL PREVIOUS PLATS)

TOTAL AREA OF ROAD RIGHT-OF-WAYS 336.83 AC.±

TOTAL AREA OF GREENWAYS 419.64 AC.±

TOTAL AREA OF THE LANDS OF THE FORD'S COLONY AT WILLIAMSBURG HOMEOWNER'S ASSOCIATION 756.47 AC.±

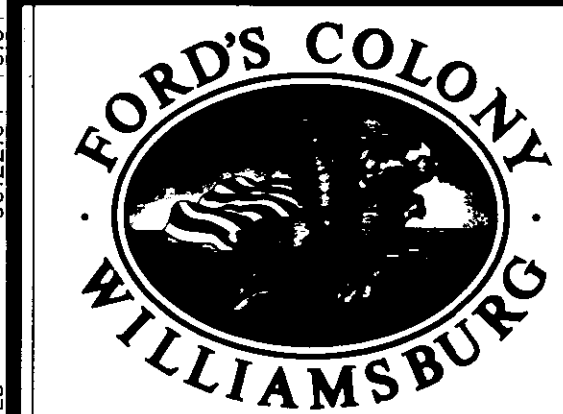
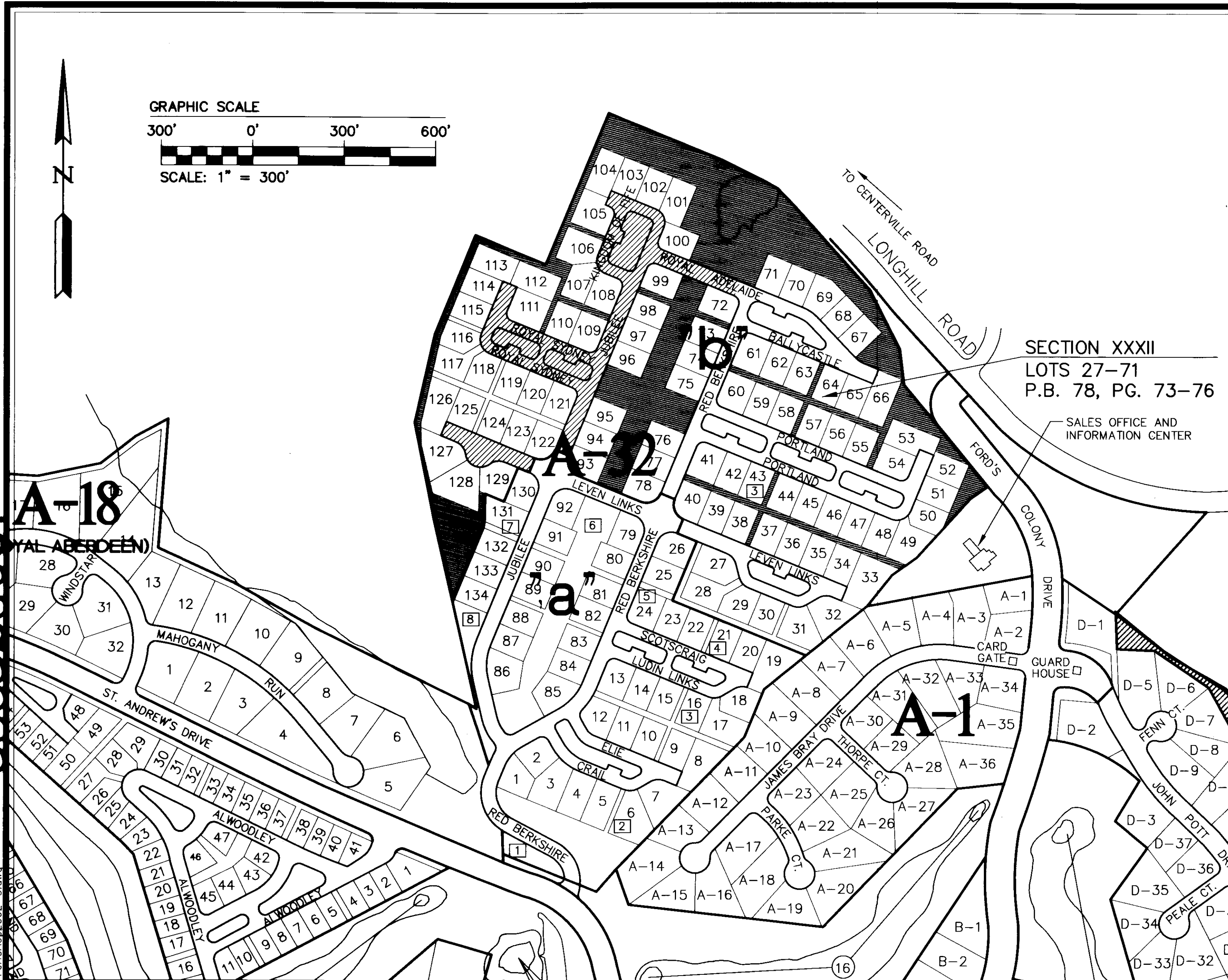

LEGEND
 [Hatched Box] GREENWAY AREA
 [Hatched Box] ROAD RIGHT-OF-WAYS
 [Square Box] INDICATES GREENWAY

080025861
 09.22.04-16.01 Fch0ACp2002-3.dwg
 DLD

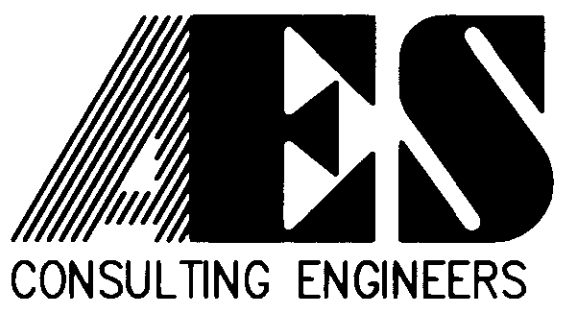

5248 Olde Towne Road, Suite 1
 Williamsburg, Virginia 23188
 (757) 253-0040
 Fax (757) 220-8994

MAP OF ADDITIONAL LANDS OF THE FORD'S COLONY AT WILLIAMSBURG HOMEOWNERS ASSOCIATION

POWHATAN DISTRICT JAMES CITY COUNTY VIRGINIA



No.	DATE	REVISION / COMMENT / NOTE	BY

Designed CBR	Drawn MEG
Scale 1"=400'	Date 6/20/07
Project No. 5652-96	
Drawing No. 5 OF 5	

City of Williamsburg & County of James City
 Circuit Court: This PLAT was recorded on
 21 October 2008
 at 10:45 AM/PM: PG. 7-9
 DOCUMENT # 080025861
 BETSY B. WOOLRIDGE, CLERK
 Betsy B. Woolridge Clerk