

**LEGEND**

■ GREENWAY AREA  
 ▨ ROAD RIGHT-OF-WAYS  
 (16) INDICATES GREENWAY

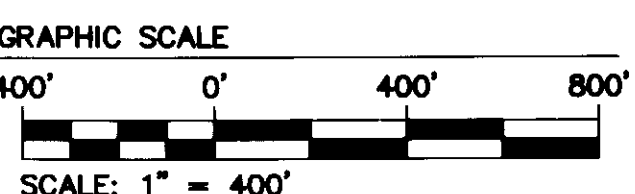

NOTE: REALTEC INCORPORATED AND/OR THEIR ASSIGNS HEREBY RESERVE EASEMENT OVER, UNDER AND THROUGH ALL THE LANDS OF THE FORD'S COLONY AT WILLIAMSBURG HOMEOWNERS ASSOCIATION SHOWN HEREON THAT MAY BE NECESSARY FROM TIME TO TIME TO EFFECT FURTHER DEVELOPMENT OF THE PROPERTY AND THE INSTALLATION OF SIGNAGE AND LANDSCAPING. FURTHERMORE, THE AFOREMENTIONED RESERVE THE RIGHT WITHIN SAID HOMEOWNERS' LANDS TO CONSTRUCT AND MAINTAIN ACCESSORY AMENITY BUILDINGS. SUCH PROPERTY IS ALSO SUBJECT TO THE EASEMENTS, RIGHTS AND LIMITATIONS DESCRIBED IN THE DECLARATION OF PROTECTIVE COVENANTS FOR FORD'S COLONY OR IN SUPPLEMENTS

EXISTING PLATTED EASEMENTS FOR UTILITIES AND DRAINAGE OVER THE LANDS OF THE FORD'S COLONY AT WILLIAMSBURG HOMEOWNERS ASSOCIATION SHOWN HEREON ARE NOT SHOWN FOR PURPOSES OF CLARITY. REFERENCE IS HEREBY MADE TO THE LAND RECORDS OF JAMES CITY COUNTY FOR MORE EXACT INFORMATION RELATING TO EASEMENT LOCATIONS AND USE.

**AREA TABULATION OF THE LANDS OF THE FORD'S COLONY @ WILLIAMSBURG HOMEOWNERS ASSOCIATION**

SECTION	WHERE RECORDED	DESCRIPTION	AREA
SECTION XXXIII LOTS 1-50	DOC. #050008649	GREENWAY	0.34 AC.±
		RIGHT-OF-WAY	5.02 AC.±
SECTION XXXIV LOTS 1-9	DOC. #050008876	GREENWAY	0.00 AC.±
		RIGHT-OF-WAY	0.92 AC.±
		TOTAL GREENWAY:	0.34 AC.±
		TOTAL RIGHT OF WAY:	5.94 AC.±

**SUMMARY OF PREVIOUS PLATS OF THE FORD'S COLONY AT WILLIAMSBURG HOMEOWNERS ASSOCIATION**

SECTION	WHERE RECORDED	DESCRIPTION
SECTION 1, 2, 4, 5	P.B. 46, PG. 79	D.B. 366, PG. 564
SECTION 3	P.B. 48, PG. 96	D.B. 395, PG. 787
SECTION 6, LOTS 1-117	P.B. 52, PG. 39	D.B. 477, PG. 35
SECTION 10	P.B. 52, PG. 38	D.B. 477, PG. 35
SECTION 6, LOTS 118-285; SECTION 11A, LOTS 70-158	P.B. 53, PG. 80	D.B. 504, PG. 124
SECTION 11A, LOTS 1-69	P.B. 54, PG. 87	D.B. 529, PG. 74
SECTION 7	P.B. 55, PG. 49	D.B. 548, PG. 299
SECTION 9A	P.B. 68, PG. 75-78	DOC. #080004672
SECTION 9B	P.B. 58, PG. 43	D.B. 647, PG. 395
SECTION 13B	P.B. 78, PG. 79	DOC. #00000
SECTION 13C, D, E	P.B. 81, PG. 56	D.B. 734, PG. 740
SECTION 13C	P.B. 88, PG. 75-78	DOC. #080004672
SECTION 16, LOTS 7-84	P.B. 88, PG. 75-78	DOC. #080004672
SECTION 18B, LOTS 1-25	P.B. 76, PG. 51-52	DOC. #000002031
SECTION XVII, LOTS 1-46	P.B. 76, PG. 51-52	DOC. #000002031
SECTION XVII, LOTS 48-71	P.B. 76, PG. 51-52	DOC. #000002031
SECTION XVIII, LOTS 1-32	P.B. 76, PG. 51-52	DOC. #000002031
SECTIONS (BLOCK D), LOTS 1-5, 8; (BLOCK F), LOTS 1-30; VI, LOTS 1-172; VII, LOTS 1-35; VIII-B, LOTS 1-45; IX, LOTS 56-111; XI-A, LOTS 70-196; XII-A, LOTS 1-41; XIII-B, LOTS 1-82; XIII-C, LOTS 1-34; XIV-A, LOTS 1-12; XIV-B, LOTS 1-56; XV, LOTS 1-12; XVI, LOTS 1-8, 85; XVIII, LOTS 1-14, 31-32; XXX, LOTS 1-81; XXXI, LOTS 1-71, 79-92, 130-134	P.B. 88, PG. 40-42	INST. #020026590
SECTION (BLOCK D), LOTS 1-5, 8; SECTION II, ST. ANDREWS DRIVE; SECTION III, LOTS 251-290, MAINTENANCE CENTER; SECTION VI; SECTION XII-A, LOTS 1-41; SECTION XII-B, LOTS 1-82; XIV-B, LOTS 1-56; XXX-A, LOTS 1-35	P.B. 89, PG. 54-55	DOC. #030005477
SECTION XI, LOTS 2-36, 41-72	P.B. 49, PG. 45-50	DOC. #040009115
SECTION XII, LOTS 39 & 40	P.B. 55, PG. 2	DOC. #050010088
OPEN SPACE ADJACENT TO POWHATAN CREEK, LONGHILL SWAMP, AND CHISEL RUN (PARCELS 1-5)	P.B. 90, PG. 23-25	DOC. #050010088
SECTION XXX, LOTS 1-16, 57-66	P.B. 81, PG. 7-9	AES PLAT DATED 3-30-05
SECTION XXXI, LOTS 17-58, 67-88	P.B. 88, PG. 70-71	AES PLAT DATED 3-30-05
SECTION XXXII, LOTS 82-142	P.B. 88, PG. 72-78	AES PLAT DATED 3-30-05
	P.B. 81, PG. 74-78	AES PLAT DATED 3-30-05
	P.B. 87, PG. 80-82	AES PLAT DATED 3-30-05
	P.B. 83, PG. 75-78	AES PLAT DATED 3-30-05

TOTAL AREA OF ROAD RIGHT-OF-WAYS (AS SUMMARIZED BY AES PLAT DATED 3-30-05) 327.18 AC.±

TOTAL AREA OF GREENWAYS (AS SUMMARIZED BY AES PLAT DATED 3-30-05) 387.25 AC.±

TOTAL AREA OF THE LANDS OF THE FORD'S COLONY AT WILLIAMSBURG HOMEOWNERS ASSOCIATION 724.43 AC.±

**TOTAL AREA TO DATE SUMMARY OF THE LANDS OF THE FORD'S COLONY AT WILLIAMSBURG HOMEOWNERS ASSOCIATION (INCLUDES ALL PREVIOUS PLATS)**

TOTAL AREA OF ROAD RIGHT-OF-WAYS 333.12 AC.±

TOTAL AREA OF GREENWAYS 387.50 AC.±

TOTAL AREA OF THE LANDS OF THE FORD'S COLONY AT WILLIAMSBURG HOMEOWNERS ASSOCIATION 730.71 AC.±

080025861

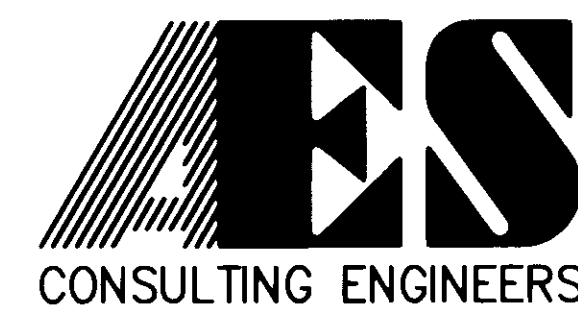
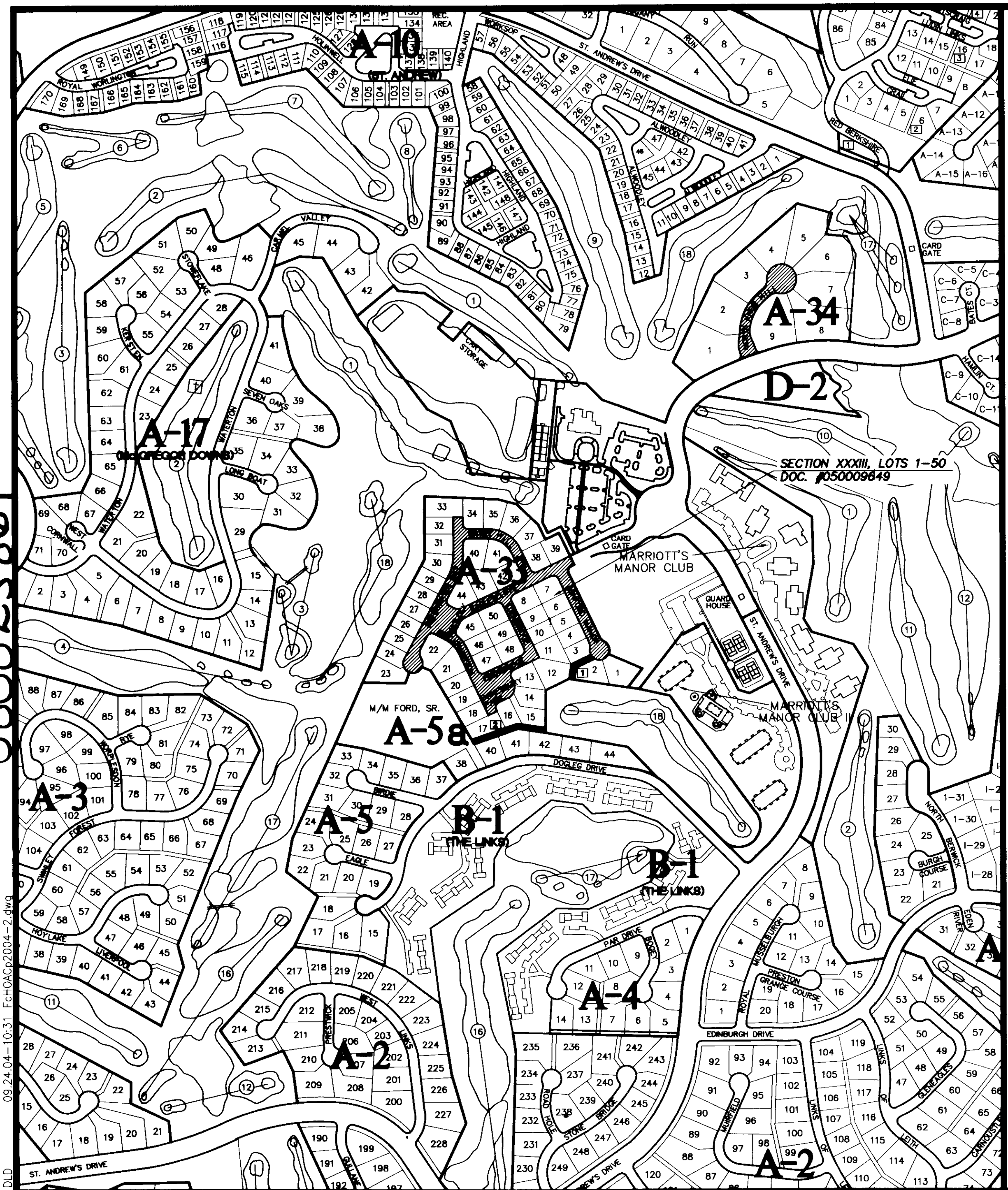

5248 Olde Towne Road, Suite 1  
 Williamsburg, Virginia 23188  
 (757) 253-0040  
 Fax (757) 220-8994

MAP OF ADDITIONAL LANDS OF  
**THE FORD'S COLONY**  
 WILLIAMSBURG  
 HOMEOWNERS ASSOCIATION

POWHATAN DISTRICT JAMES CITY COUNTY VIRGINIA

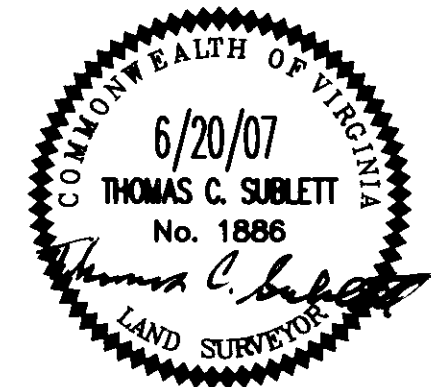

No.	DATE	REVISION / COMMENT / NOTE	BY

Designed	Drawn
CBR	MEG
Scale	Date
1" = 400'	6/20/07
Project No.	
5652-96	
Drawing No.	
3 OF 5	

City of Williamsburg & County of James City  
 Circuit Court: This PLAT was recorded on  
 21 October 2008  
 at 10:45 AM/PM, PG. 1- PG. 1  
 DOCUMENT # 080025861  
 BETSY B. WOOLRIDGE, CLERK  
 Betsy B. Woolridge Clerk