

SECTION XXX, LOTS 1-16, 57-66
P.B. 81, PG. 74-76

SECTION XXX, LOTS 17-56, 67-68
P.B. 87, PG. 80-82

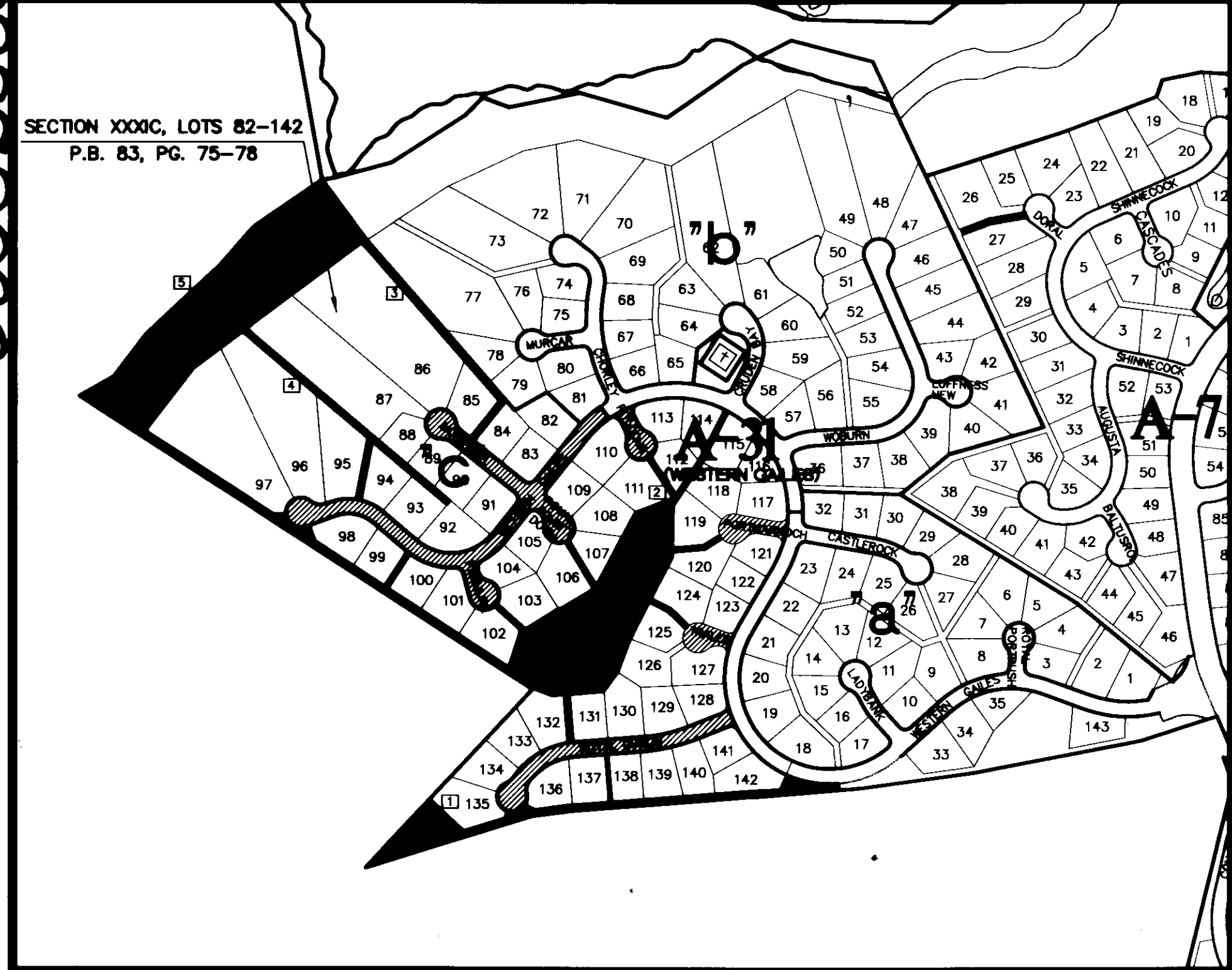

SECTION XXXC, LOTS 82-142
P.B. 83, PG. 75-78

NOTE:
REALTEC INCORPORATED AND/OR THEIR ASSIGNS HEREBY RESERVE EASEMENT OVER, UNDER AND THROUGH ALL THE LANDS OF THE FORD'S COLONY AT WILLIAMSBURG HOMEOWNERS ASSOCIATION SHOWN HEREON THAT MAY BE NECESSARY FROM TIME TO TIME TO EFFECT FURTHER DEVELOPMENT OF THE PROPERTY AND THE INSTALLATION OF SIGNAGE AND LANDSCAPING. FURTHERMORE, THE AFOREMENTIONED RESERVE THE RIGHT WITHIN SAID HOMEOWNERS' LANDS TO CONSTRUCT AND MAINTAIN ACCESSORY AMENITY BUILDINGS. SUCH PROPERTY IS ALSO SUBJECT TO THE EASEMENTS, RIGHTS AND LIMITATIONS DESCRIBED IN THE DECLARATION OF PROTECTIVE COVENANTS FOR FORD'S COLONY OR IN SUPPLEMENTS

EXISTING PLATTED EASEMENTS FOR UTILITIES AND DRAINAGE OVER THE LANDS OF THE FORD'S COLONY AT WILLIAMSBURG HOMEOWNERS' ASSOCIATION SHOWN HEREON ARE NOT SHOWN FOR PURPOSES OF CLARITY. REFERENCE IS HEREBY MADE TO THE LAND RECORDS OF JAMES CITY COUNTY FOR MORE EXACT INFORMATION RELATING TO EASEMENT LOCATIONS AND USE.

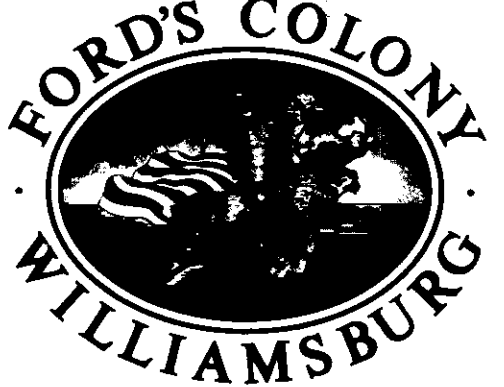

LEGEND

	GREENWAY AREA
	ROAD RIGHT-OF-WAYS
	INDICATES GREENWAY

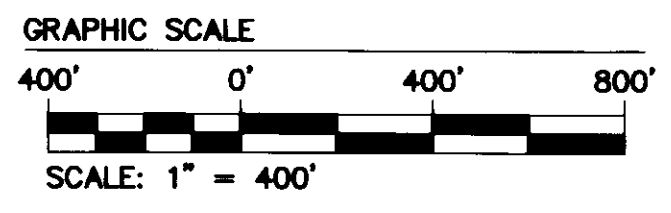

AREA TABULATION OF THE LANDS OF THE FORD'S COLONY @ WILLIAMSBURG HOMEOWNER'S ASSOCIATION

SECTIONS XXX AND XXXC	WHERE RECORDED	DESCRIPTION	AREA
SECTION XXX			
LOTS 1-16, 57-66	P.B. 81, PG. 74-76	GREENWAY	1.01 AC.±
		RIGHT-OF-WAY	3.47 AC.±
LOTS 17-56, 67-68	P.B. 87, PG. 80-82	GREENWAY	3.26 AC.±
		RIGHT-OF-WAY	4.59 AC.±
SECTION XXXC			
LOTS 82-142	P.B. 83, PG. 75-78	GREENWAY	22.81 AC.±
		RIGHT-OF-WAY	4.62 AC.±
		TOTAL (GREENSPACE)=	27.08 AC.±
		TOTAL (RIGHT OF WAY)=	12.68 AC.±

* A PORTION OF GREENWAY PREVIOUSLY CONVEYED IN SECTION IXA "MAP OF ADDITIONAL LANDS" PLAT BOOK 68, PAGES 75-76, GREENWAY 1, HAS BEEN REDUCED BY (0.196 AC.) WITH THE SUBDIVISION OF LOT 5 AND GREENWAY HEREBY CONVEYED IN SECTION XXX. IN ADDITION A PORTION OF GREENWAY PREVIOUSLY CONVEYED IN SECTION XVI "MAP OF ADDITIONAL LANDS" PLAT BOOK 61, PAGE 56, GREENWAY 29, HAS BEEN REDUCED BY (1.095 AC.) WITH THE ADDITIONAL R/W, SUBDIVISION OF LOTS 3-5, 62-65 AND NEW GREENWAY HEREBY CONVEYED IN THE SECTION XXX.

REDUCTION IN GREENWAY 18 = -1.291 AC.±

SUMMARY OF PREVIOUS PLATS OF THE FORD'S COLONY AT WILLIAMSBURG HOMEOWNER'S ASSOCIATION

SECTION	WHERE RECORDED	WHERE RECORDED
SECTION 1, 2, 4, 5	P.B. 46, PG. 79	D.B. 366, PG. 564
SECTION 3	P.B. 48, PG. 96	D.B. 395, PG. 787
SECTION 6, LOTS 1-117	P.B. 52, PG. 39	D.B. 477, PG. 35
SECTION 10	P.B. 52, PG. 38	D.B. 477, PG. 35
SECTION 6, LOTS 118-265;	P.B. 53, PG. 80	D.B. 504, PG. 124
SECTION 11A, LOTS 70-156		
SECTION 11A, LOTS 1-69	P.B. 54, PG. 87	D.B. 529, PG. 74
SECTION 7	P.B. 55, PG. 49	D.B. 548, PG. 299
SECTION 9A	P.B. 68, PG. 75-76	DOC. #980004672
SECTION 9B	P.B. 58, PG. 43	D.B. 647, PG. 395
SECTION 13B	P.B. 76, PG. 79	DOC. #000000
SECTION 13C, D, E	P.B. 61, PG. 56	D.B. 734, PG. 740
SECTION 13C	P.B. 68, PG. 75-76	DOC. #980004672
SECTION 16, LOTS 7-84	P.B. 68, PG. 75-76	DOC. #980004672
SECTION 11B, LOTS 1-25	P.B. 76, PG. 51-52	DOC. #000002031
SECTION XVII, LOTS 1-46	P.B. 76, PG. 51-52	DOC. #000002031
SECTION XVII, LOTS 48-71	P.B. 76, PG. 51-52	DOC. #000002031
SECTION XVII, LOTS 1-32	P.B. 76, PG. 51-52	DOC. #000002031
SECTIONS I (BLOCK D), LOTS 1-5,9;(BLOCK F), LOTS 1-39;		
VII, LOTS 1-172; VIII, LOTS 1-35;		
VIII-B, LOTS 1-45; IX, LOTS 58-111;		
XI-A, LOTS 70-156; XIII-A, LOTS 1-41;		
XIII-B, LOTS 1-62; XIII-C, LOTS 1-34;		
XIV-A, LOTS 1-12; XIV-B, LOTS 1-56;		
XV, LOTS 1-12; XVI, LOTS 1-6,85;		
XVIII, LOTS 1-14,31-32;XXXI,		
LOTS 1-81;XXXII, LOTS 1-71,79-92,		
130-134		
SECTION I (BLOCK D), LOTS 1-5,9;	P.B. 89, PG. 54-55	DOC. #030005477
SECTION II, ST. ANDREWS DRIVE;		
SECTION III, LOTS 251-290,		
MAINTENANCE CENTER; SECTION VI;		
SECTION XIII-A, LOTS 1-41; SECTION		
XIII-B, LOTS 1-62; XIV-B, LOTS 1-56;		
XXXI-A, LOTS 1-35		
SECTION XI-A, LOTS 1-69	P.B. 49, PG. 45-50	DOC. #040009115
	P.B. 55, PG. 2	
SECTION XII, LOTS 2-38,41-72	P.B. 90, PG. 23-25	DOC. #050010098
SECTION XII, LOTS 39 & 40	P.B. 90, PG. 47	DOC. #050010098
OPEN SPACE ADJACENT TO	P.B. 81, PG. 7-9	AES PLAT DATED 3-30-05
POWHATAN CREEK, LONGHILL	P.B. 88, PG. 70-71	AES PLAT DATED 3-30-05
SWAMP, AND CHISEL RUN	P.B. 88, PG. 72-76	AES PLAT DATED 3-30-05
(PARCELS 1-5)		

TOTAL AREA OF ROAD RIGHT-OF-WAYS (AS SUMMARIZED BY AES PLAT DATED 3-30-05)	314.50 AC.±
TOTAL AREA OF GREENWAYS (AS SUMMARIZED BY AES PLAT DATED 3-30-05)	370.17 AC.±
TOTAL AREA OF THE LANDS OF THE FORD'S COLONY AT WILLIAMSBURG HOMEOWNER'S ASSOCIATION	684.67 AC.±

TOTAL AREA TO DATE SUMMARY OF THE LANDS OF THE FORD'S COLONY AT WILLIAMSBURG HOMEOWNER'S ASSOCIATION (INCLUDES ALL PREVIOUS PLATS)

TOTAL AREA OF ROAD RIGHT-OF-WAYS	327.18 AC.±
TOTAL AREA OF GREENWAYS	397.25 AC.±
TOTAL AREA OF THE LANDS OF THE FORD'S COLONY AT WILLIAMSBURG HOMEOWNER'S ASSOCIATION	724.43 AC.±

080025861

5248 Olde Towne Road, Suite 1
Williamsburg, Virginia 23188
(757) 253-0040
Fax (757) 220-8994

MAP OF ADDITIONAL LANDS OF THE FORD'S COLONY
WILLIAMSBURG HOMEOWNERS ASSOCIATION

POWHATAN DISTRICT JAMES CITY COUNTY VIRGINIA

No.	DATE	REVISION / COMMENT / NOTE	BY

Designed CBR	Drawn MEG
Scale 1"=400'	Date 6/20/07
Project No. 5652-96	
Drawing No. 2 OF 5	