

NOTES:

1. COMMON ELEMENTS, LIMITED COMMON ELEMENTS AND UNITS ARE SUBSTANTIALLY COMPLETE.
2. ALL BUILDING FLOOR PLANS AND DETAILS SHOWN ARE PER ARCHITECTURAL PLANS PROVIDED TO AES CONSULTING ENGINEERS BY THE DEVELOPER.
3. THE LOWER (HORIZONTAL) BOUNDARY OF EACH UNIT AS SHOWN IN THE PLAN IS THE HORIZONTAL PLANE OF THE UPPER SURFACE OF THE CONCRETE FLOOR SLAB.
4. THE UPPER (HORIZONTAL) BOUNDARY IS THE PLANE OF THE LOWER SURFACE OF THE SUSPENDED ACOUSTIC CEILING OF THE UNIT.
5. THE VERTICAL (SIDE) BOUNDARIES OF THE UNIT SHALL BE THE VERTICAL PLANE OF THE CENTERLINE OF THE INTERIOR WALL DIVIDING ANY TWO UNITS AND/OR THE OUTSIDE FACE OF THE EXTERIOR WALL OF THE PERIMETER UNIT, EXTENDED TO INTERSECTIONS WITH EACH OTHER AND WITH THE UPPER AND LOWER UNIT BOUNDARIES.
6. LOWER, UPPER AND SIDE BOUNDARIES ARE MORE FULLY DESCRIBED IN THE DECLARATION OF CONDOMINIUM.
7. THE INTERIOR WALLS AND ELEMENTS AS SHOWN HEREON WERE TAKEN DIRECTLY FROM ARCHITECTURAL DRAWINGS PROVIDED BY THE DEVELOPER AND ARE INTENDED FOR REFERENCE PURPOSES ONLY. INTERIOR PARTITION WALLS AND ELEMENTS HAVE NOT BEEN FIELD VERIFIED AND ARE NOT SHOWN.

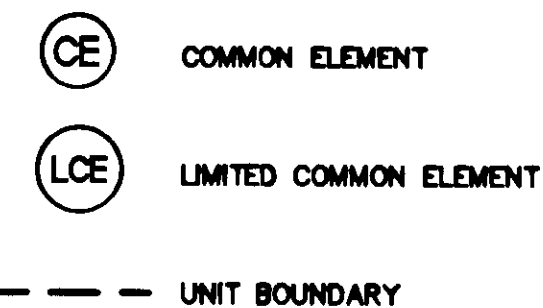

080008351

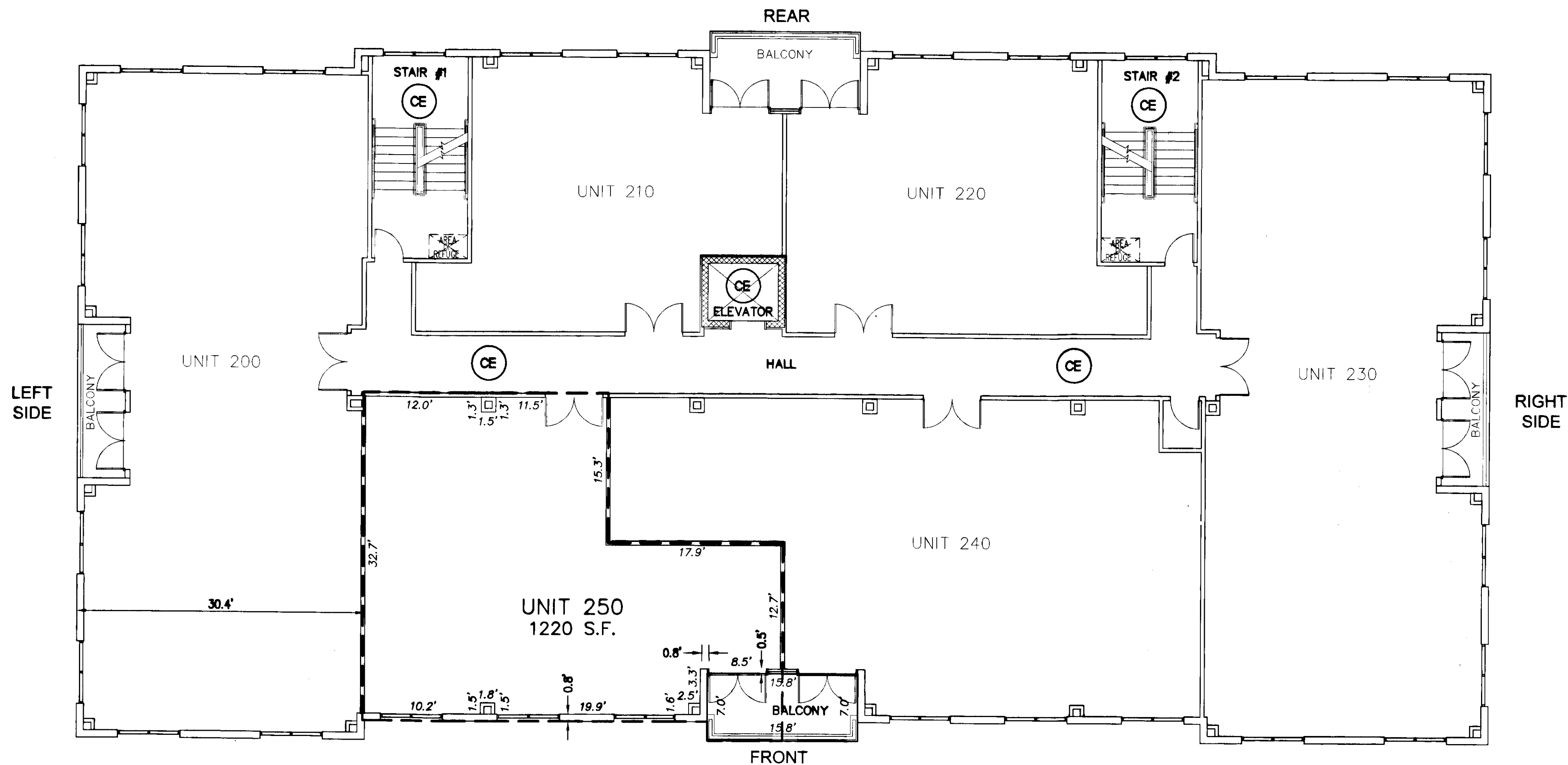

SECOND FLOOR PLAN

NOT TO SCALE

Large/Small Plat(s) Recorder
horowitz as # 080008351

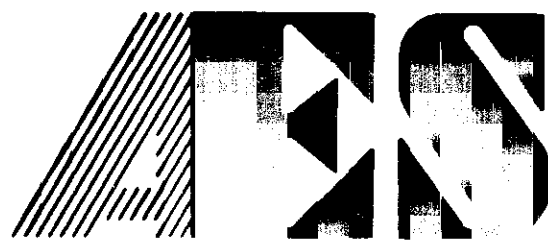

CONSULTING ENGINEERS

WILLIAMSBURG • RICHMOND • GLOUCESTER • FREDERICKSBURG

5248 Olde Towne Road, Suite 1
Williamsburg, Virginia 23188
(757) 253-0040
Fax (757) 220-8994

"EXHIBIT 3"

PLAN OF CONDOMINIUM
PATRIOT PARK, A CONDOMINIUM
PHASE 5, UNIT 250
OWNER/DEVELOPER: PATRIOT DEVELOPMENT ASSOCIATES, LLC
BERKELEY DISTRICT JAMES CITY COUNTY VIRGINIA

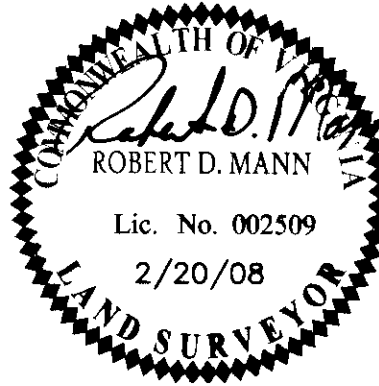

| | | | |
|--|---------|---------------------------|--------------------------|
| City of Williamsburg & County of James City Circuit Court: This PLAT was recorded on <u>25 March 2008</u> at <u>10:17</u> AM/PM, PB <u> </u> PG <u> </u> DOCUMENT # <u>080008351</u> BETSY B. WOOLRIDGE, CLERK <u>Betsy B. Woolridge</u> Clerk | | | |
| 1 | 3/14/08 | ADJUSTED UNIT BOUNDARY | RDM |
| No. | DATE | REVISION / COMMENT / NOTE | REVISED BY / REVIEWED BY |

| | |
|---------------------------|-----------------|
| Designed AES | Drawn AWT |
| Scale NTS | Date 2/20/08 |
| Project No. 6632-6-15D | |
| Drawing No. 2 of 5 | |