

080003775

N/F
QUARTERLAND COMMONS
UNIT OWNERS ASSOCIATION
TAX PARCEL 5021400001

SURVEYORS CERTIFICATE:
I HEREBY CERTIFY THAT TO THE BEST OF MY KNOWLEDGE AND BELIEF, THIS PLAT
COMPLIES WITH THE PROCEDURES AND STANDARDS ESTABLISHED BY THE BOARD FOR
ARCHITECTS, PROFESSIONAL ENGINEERS, LAND SURVEYORS, CERTIFIED INTERIOR DESIGNERS,
AND LANDSCAPE ARCHITECTS IN THE COMMONWEALTH OF VIRGINIA; COMPLIES WITH THE
PROVISIONS OF SECTION 55-79.58(a) & (b) OF THE CODE OF VIRGINIA 1950 AS AMENDED
AND THAT THE BUILDINGS AS DEPICTED HEREON HAVE BEEN SUBSTANTIALLY COMPLETED.

DATE: 1-17-08
Peter Farrell
PETER FARRELL, L.S. #002036

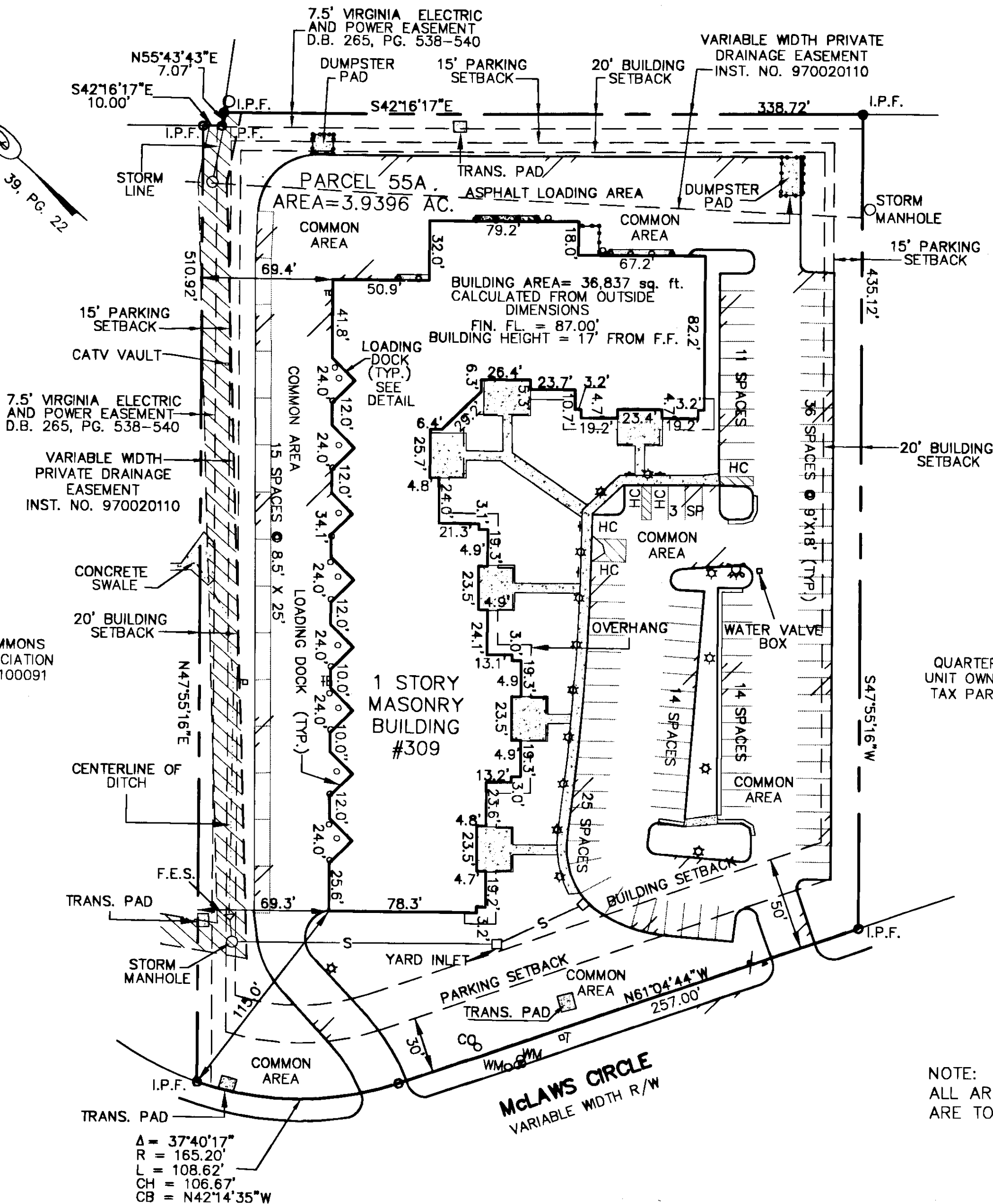
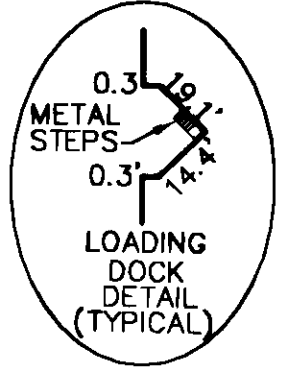
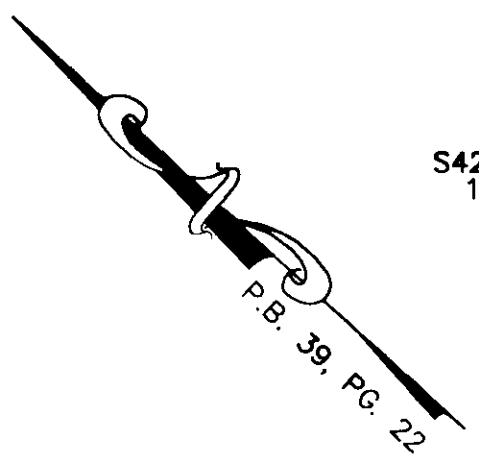
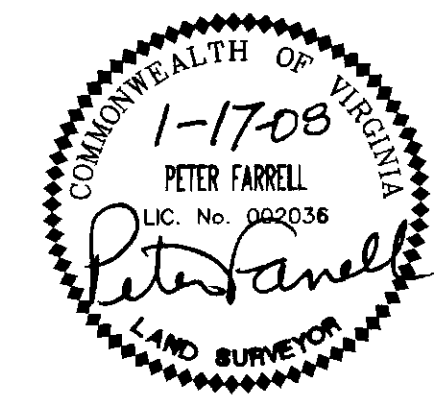

N/F
QUARTERLAND COMMONS
UNIT OWNERS ASSOCIATION
TAX PARCEL 5020100091

N/F
QUARTERLAND COMMONS
UNIT OWNERS ASSOCIATION
TAX PARCEL 5020100084

- LEGEND**
- SEWER CLEAN OUT
 - WATER METER
 - TELEPHONE PEDESTAL
 - TRANSFORMER PAD
 - CHAIN LINK FENCE
 - STORM MANHOLE
 - FIRE HYDRANT
 - F.E.S.
 - STORM DROP INLET
 - LIGHT POLE
 - BOLLARD
 - IRON PIN FOUND
 - EDGE OF PAVEMENT
 - CONCRETE
 - SIGN

CONDOMINIUM EXHIBIT
RIVERGATE BUSINESS CENTER
PARCEL 55A
BUSCH CORPORATE CENTER

JAMES CITY COUNTY, VA

SCALE 1"=50' DATE: JANUARY 17, 2008

SHEET 1 OF 2

NOTE:
ALL AREAS OUTSIDE OF UNIT BOUNDARIES
ARE TO BE CONSIDERED COMMON AREA.

2 Large/Small Plat(s) Recorded
herewith as # 080003775

City of Williamsburg & County of James City
Circuit Court: This PLAT was recorded on
2-4-2008
at 2:39 AM/PM, PG _____
DOCUMENT # 080003775
BETSY B. WOOLRIDGE, CLERK
Betsy B. Woolridge Clerk

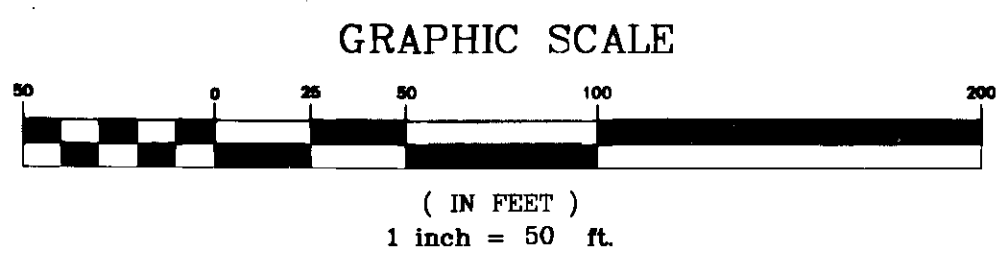

REFERENCES:
P.B. 39, PG. 22
INST. NO. 980000446



Engineers • Planners • Surveyors
Landscape Architects • Environmental Consultants

4029 Ironbound Road
Suite 100
Williamsburg, VA 23188
Tel. (757) 253-2975
Fax (757) 229-0049
Email: lmdg@landmarkdg.com

5544 Greenwich Road
Suite 200
Virginia Beach, VA 23462
Tel. (757) 473-2000
Fax (757) 497-7933
Email: lmdg@landmarkdg.com

DRAWN BY: PF
CHKD. BY: SAR
PROJ. NO.: 2007084-000.00
DWG. NO.: 18156W

080003775

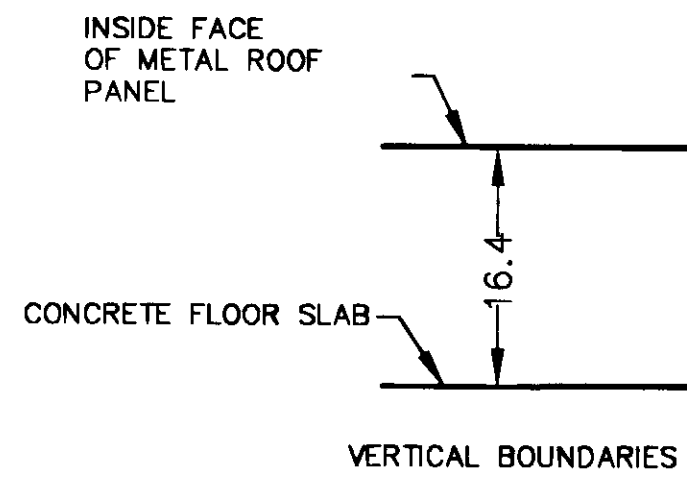

NOTE:
EXCEPT WHERE NOTED OTHERWISE INTERIOR DIMENSIONS SHOWN:
TO INSIDE FACE OF GLASS OR REAR FACE OF WALLBOARD IN FRONT.
TO INSIDE FACE OF CONCRETE BLOCK IN REAR.
TO REAR FACE OF WALLBOARD ON DIVIDING WALLS AND SIDE WALLS.

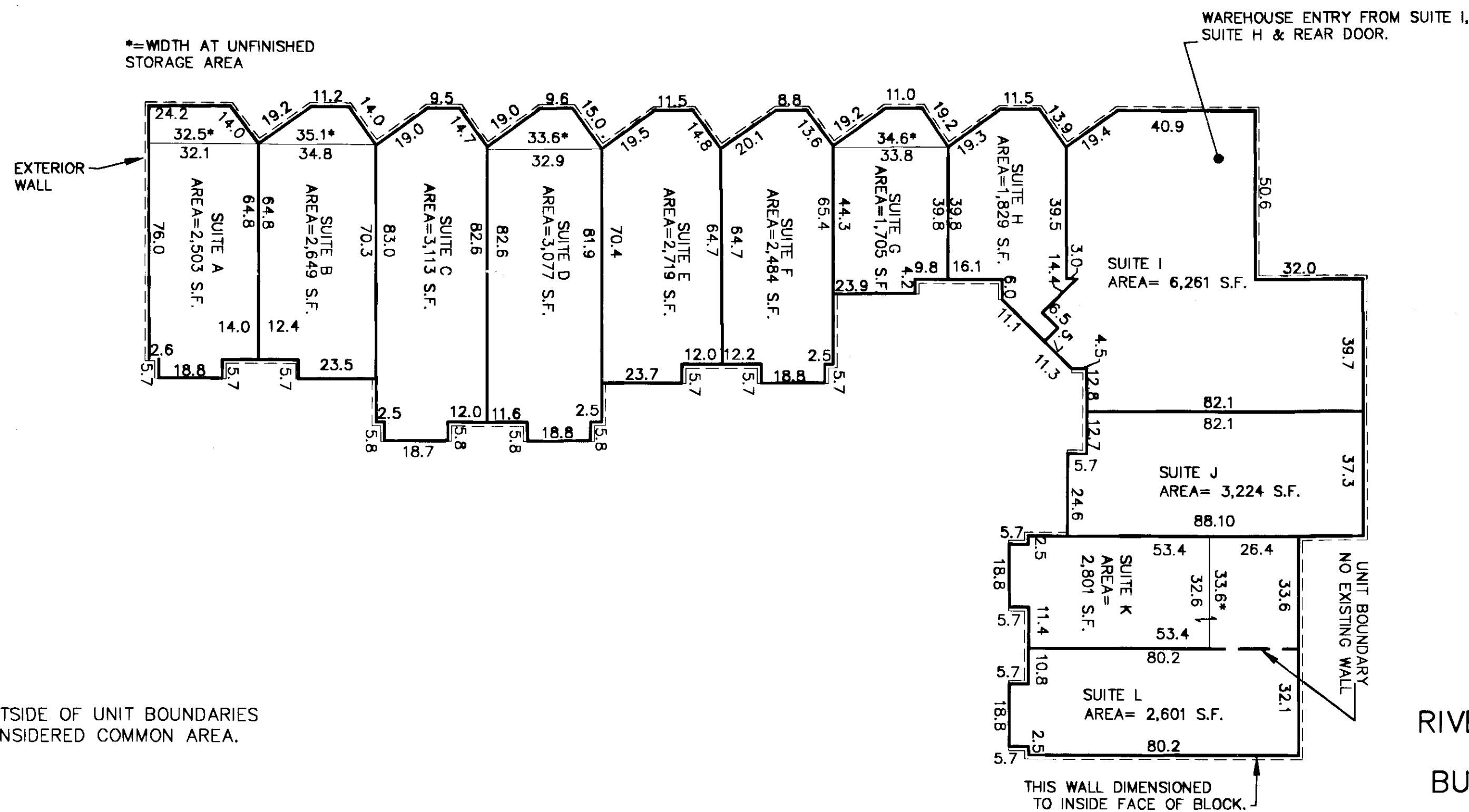

NOTE:
ALL AREAS OUTSIDE OF UNIT BOUNDARIES
ARE TO BE CONSIDERED COMMON AREA.

CONDOMINIUM EXHIBIT
RIVERGATE BUSINESS CENTER
PARCEL 55A
BUSCH CORPORATE CENTER

JAMES CITY COUNTY, VA

SCALE 1"=30' DATE: JANUARY 17, 2008
SHEET 2 OF 2

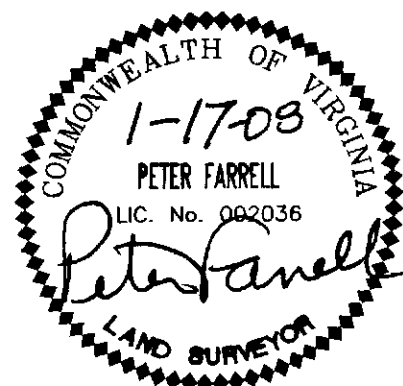
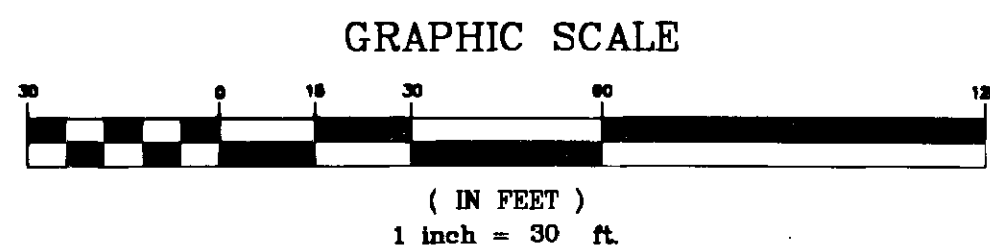

2 Large Plat(s) Recorded
herewith as # 080003775

City of Williamsburg & County of James City
Circuit Court: This PLAT was recorded on
2-4-2008
at 2:39 P.M. PG
DOCUMENT # 080003775
BETSY B. WOOLRIDGE, CLERK
Betsy B. Woolridge Clerk

LANDMARK
DESIGN GROUP
Engineers • Planners • Surveyors
Landscape Architects • Environmental Consultants

4029 Ironbound Road
Suite 100
Williamsburg, VA 23188
Tel: (757) 253-2975
Fax: (757) 229-0049
Email: lmdg@landmarkdg.com

5544 Greenwich Road
Suite 200
Virginia Beach, VA 23462
Tel: (757) 473-2000
Fax: (757) 497-7933
Email: lmdg@landmarkdg.com

DRAWN BY: AST
CHKD. BY: PF

PROJ. NO.: 2007084-000.00
DWG. NO.: 18155W