

080002806

RECORD MERIDIAN
P.B. 66, PG. 52

N/F
JAMESTOWN, LLC
PARCEL W-1
INST. #990005545
P.B. 72 PG. 31-37
PIN #3640100022

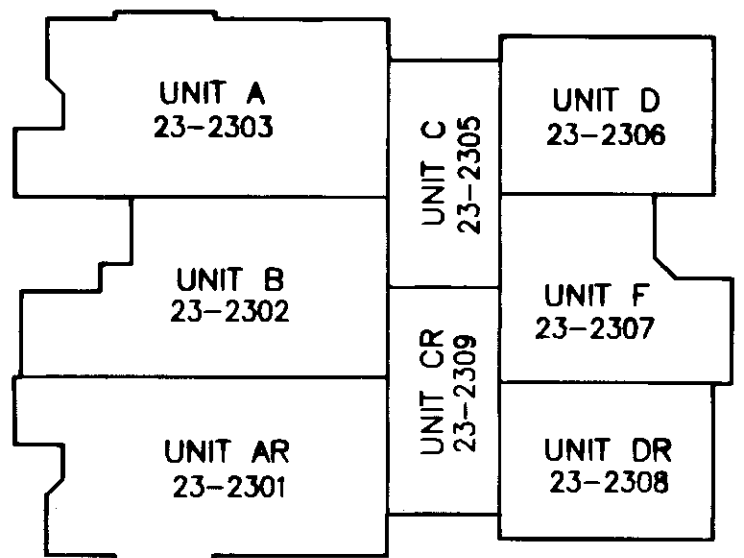

BUILDING #23 - 1ST FLOOR
N.T.S.

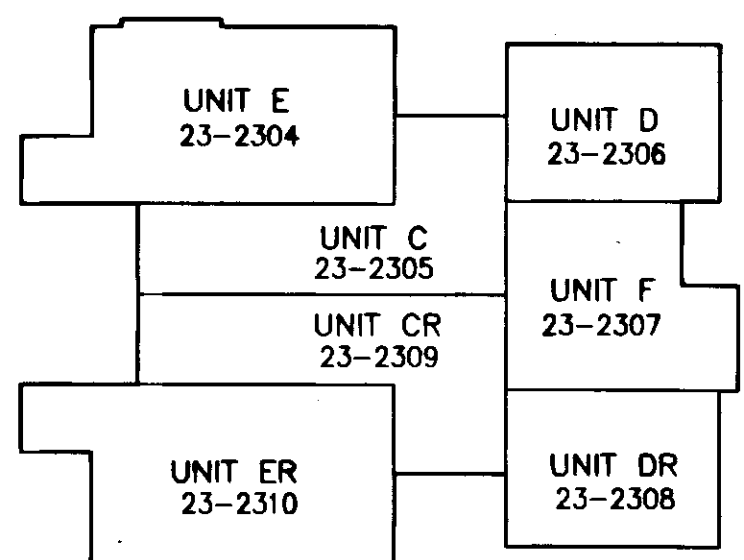

BUILDING #23 - 2ND FLOOR
N.T.S.

SURVEYORS CERTIFICATE

I HEREBY CERTIFY THAT TO THE BEST OF MY KNOWLEDGE OR BELIEF, THIS PLAT IS ACCURATE AND COMPLIES WITH THE PROVISIONS OF SECTION 55-79.58 (A) OF THE CODE OF VIRGINIA 1950 AS AMENDED AND THAT ALL UNITS DEPICTED HEREON HAVE BEEN SUBSTANTIALLY COMPLETED.

Ch. A. Chen
STATE CERTIFIED LAND SURVEYOR

1-10-08
DATE

City of Williamsburg & County of James City
Circuit Court: This PLAT was recorded on
24 January 2008
at *11:15* AM/PM, PG. *—*
DOCUMENT # *080002806*
BETSY B. WOOLRIDGE, CLERK
Betsy B. Woolridge Clerk

LINE TABLE

NUMBER	DIRECTION	DISTANCE
L41	N 29°48'18" E	63.50'
L42	S 60°11'42" E	67.50'

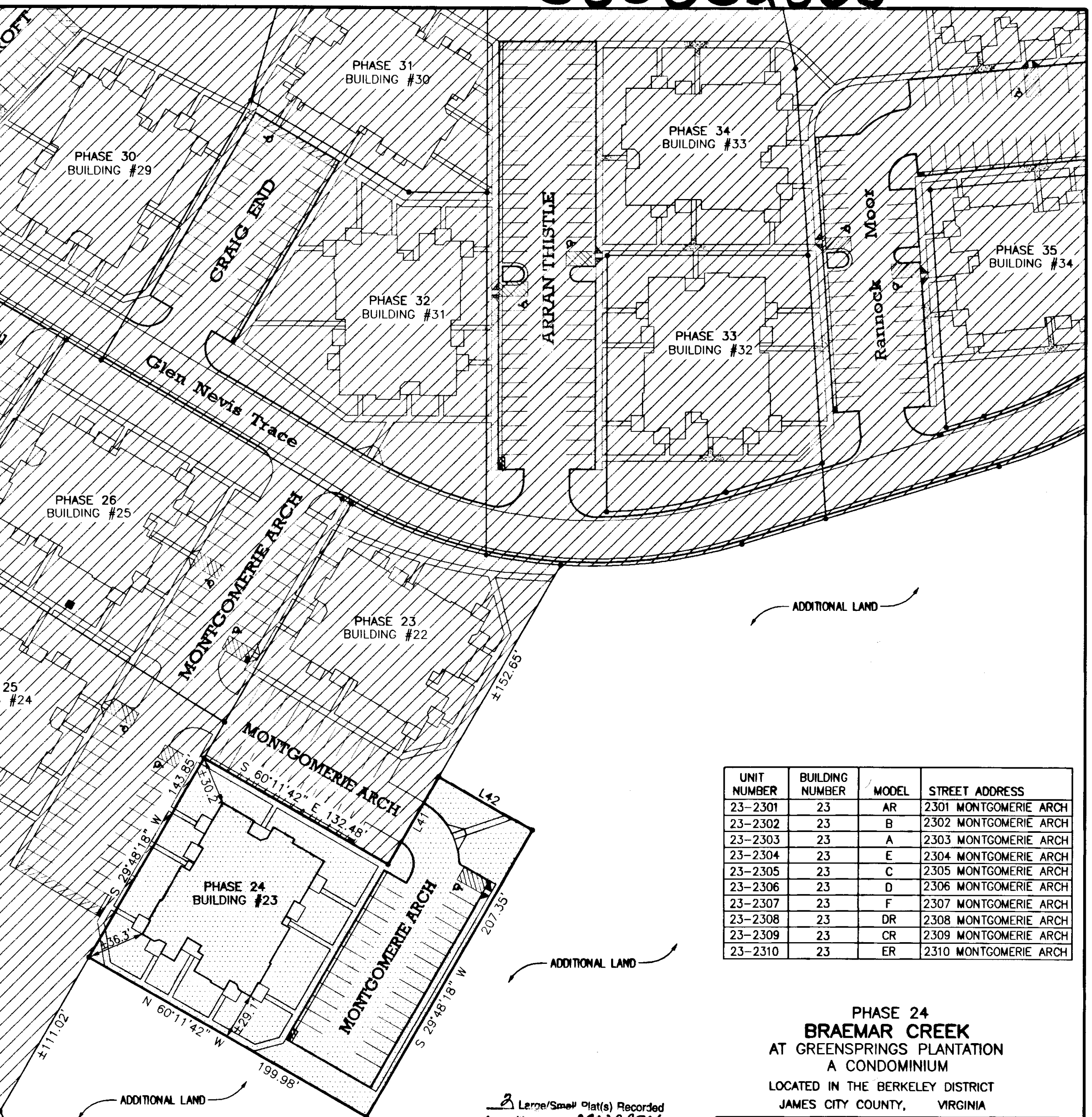

UNIT NUMBER	BUILDING NUMBER	MODEL	STREET ADDRESS
23-2301	23	AR	2301 MONTGOMERIE ARCH
23-2302	23	B	2302 MONTGOMERIE ARCH
23-2303	23	A	2303 MONTGOMERIE ARCH
23-2304	23	E	2304 MONTGOMERIE ARCH
23-2305	23	C	2305 MONTGOMERIE ARCH
23-2306	23	D	2306 MONTGOMERIE ARCH
23-2307	23	F	2307 MONTGOMERIE ARCH
23-2308	23	DR	2308 MONTGOMERIE ARCH
23-2309	23	CR	2309 MONTGOMERIE ARCH
23-2310	23	ER	2310 MONTGOMERIE ARCH

**PHASE 24
BRAEMAR CREEK
AT GREENSPRINGS PLANTATION
A CONDOMINIUM**
LOCATED IN THE BERKELEY DISTRICT
JAMES CITY COUNTY, VIRGINIA
DATE: 1/18/08 SCALE: 1" = 50' JOB# 05-548-24
SHEET 2 OF 2

AREA TABULATIONS
TOTAL AREA ENCOMPASSED BY THIS CONDOMINIUM PLAT: 39.9215 AC.
EX. PHASES: = 13.4390 ACRES (PREVIOUSLY SUBMITTED)
PHASE 24: = 0.7588 ACRES (THIS SUBMITTAL)
TOTAL ACREAGE OF ADDITIONAL LAND = 25.7237 ACRES

50 0 50 100 150
Scale: 1" = 50'

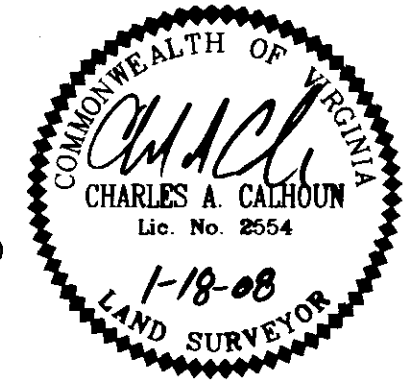

LandTech Resources, Inc.
Surveying • Engineering • GPS
201-A Bulifants Boulevard, Williamsburg, VA 23188
Phone: (757) 565-1677 Fax: (757) 565-0782
web: landtechresources.com