

#070034660

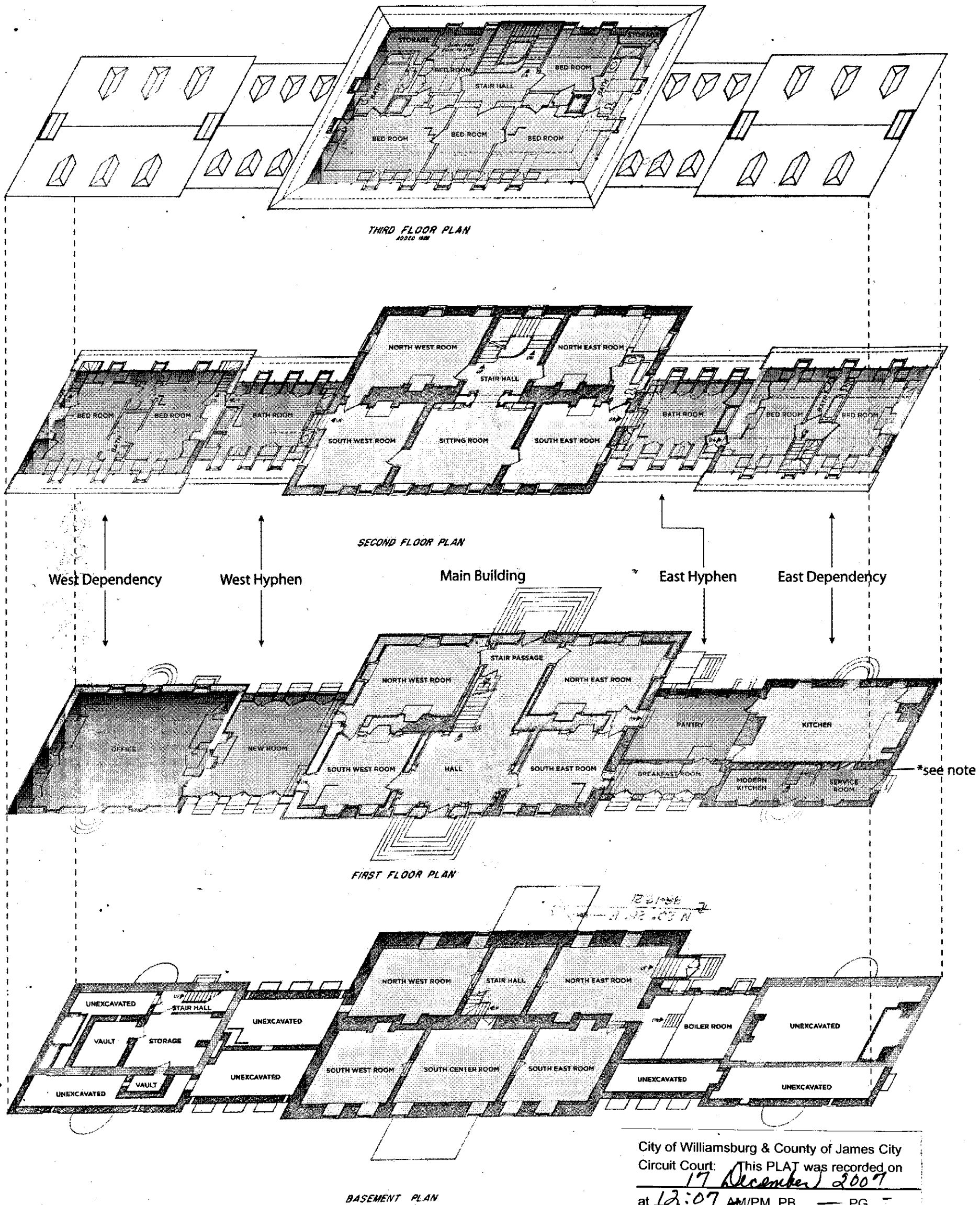

City of Williamsburg & County of James City
 Circuit Court: This PLAT was recorded on
 17 December 2007
 at 12:07 AM/PM. PB - PG -
 DOCUMENT # 070034660
 BETSY B. WOOLRIDGE, CLERK
Betsy B. Woolridge Clerk

EXHIBIT B:

CARTER'S GROVE MANSION
DIAGRAM

- 18th Century Original
- 20th Century Modifications to Original
- 20th Century Additions

*Kitchen partition wall consists of both 18th- and 20th-century materials

Mansion Exterior: The 18th- and 20-century exterior architectural elements including without limitation the brick masonry, wood trim, roof, roof lines, color, building materials, walls, windows, doors, and the six sets of exterior stone steps.

Mansion Interior Features: The 18th- and 20th-century interior architectural elements including without limitation paneling, woodwork, mantels, windows, window frames, doors, door frames, stairs,

3 Large/Small Plat(s) Recorded
 herewith as # 070034660