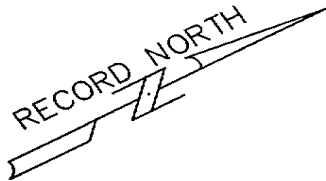
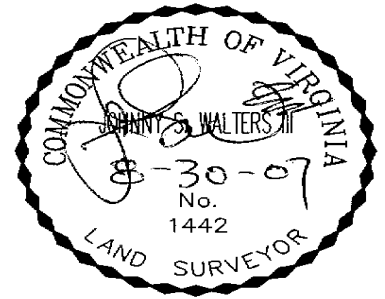

EXHIBIT "A"

N/F
NEWPORT NEWS WATERWORKS
D.B. 133, PG. 291-293
N 04°05'10" E 65.49'
EDGE OF MARSH



N/F
FREDDIE L. WALLACE
D.B. 63, PG. 283

N/F
WILLE SIMPSON
D.B. 462, PG. 359

PIPE FD.
@ 437.7'

456.00'

LATTICE

TOTAL AREA:
27,463 SQ. FT.

S 59°04'23" E

N 59°04'23" W

CONC

WALL

WALL

WELL

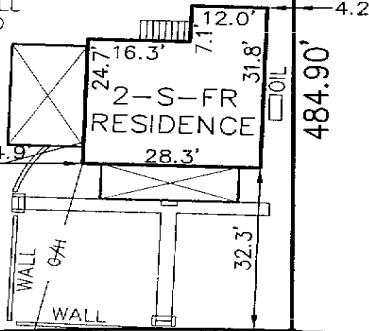

NAIL SET
@ 0.26'

R = 604.92'
L = 58.46'

PIPE
FD.

DEED REF.: D.B. 512, PG. 324
FLOOD ZONE: X
COMMUNITY NO.: 510201
PANEL NO.: 20
SUFFIX: B
DATE OF FIRM INDEX: 2-6-91

This is to certify that on August 30th, 2007 I surveyed the property shown on this plat and found the property lines to be correct as shown hereon. There are no visible encroachments either way across the lines except as shown. This survey is subject to easements, servitudes and covenants of record and was prepared without benefit of a back title letter. This survey is not to be used for construction purposes.

[Signature]
JOHNNY S. WALTERS, III LAND SURVEYOR

CHICKAHOMINY ROAD
#3344 CHICKAHOMINY ROAD
PLAT OF THE PROPERTY OF
HARGRAVE FAMILY TRUST

PARCEL OF LAND
LOCATED ON CHICKAHOMINY ROAD
CONTAINING 27,463 SQ. FT.
JAMES CITY COUNTY, VIRGINIA

WALTERS LAND SURVEYING, LTD.
710 DENBIGH BOULEVARD, SUITE 4C
NEWPORT NEWS, VIRGINIA 23608
PHONE: (757) 898-1057
FAX: (757) 898-2862