

070021225

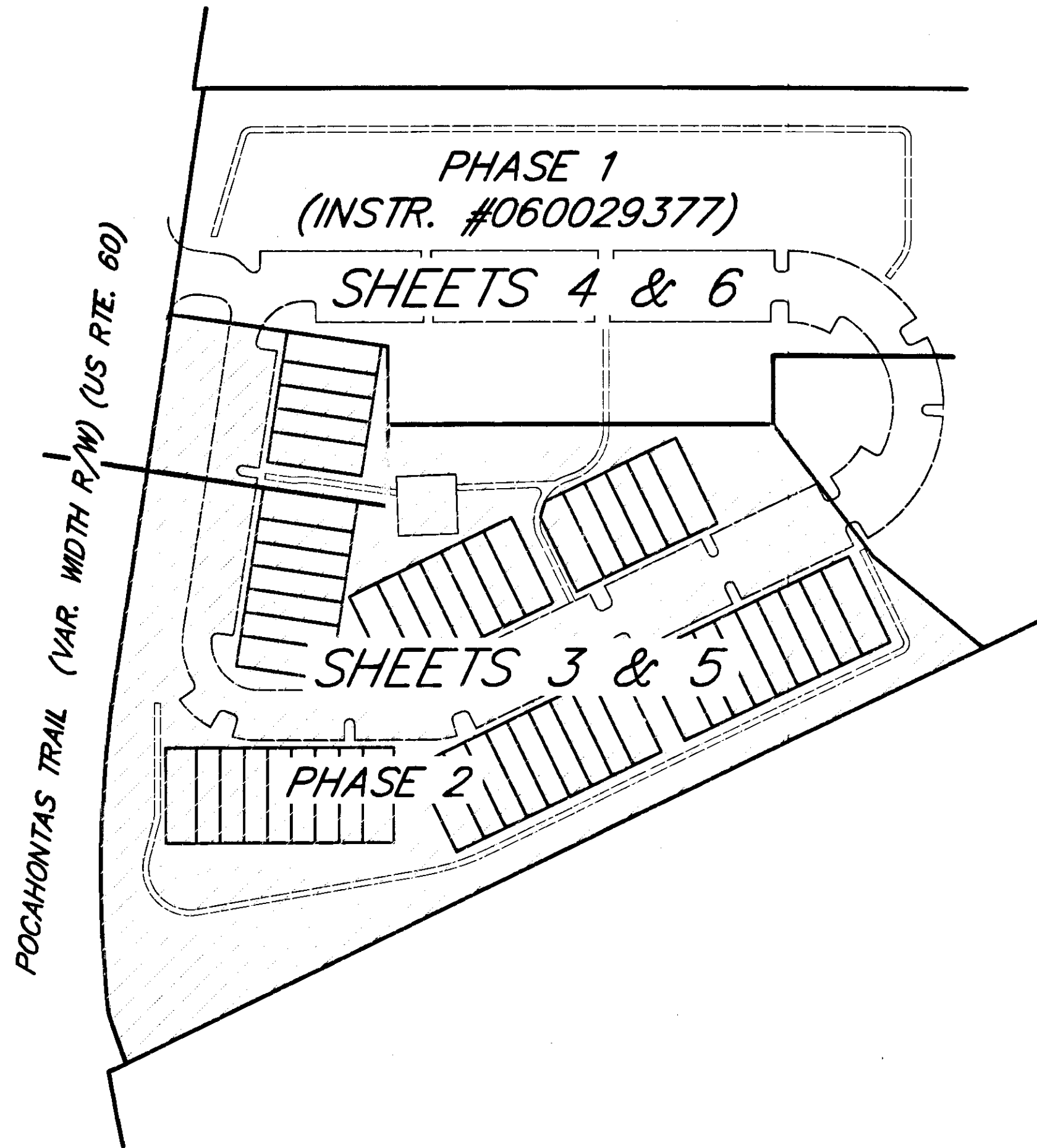

VIRGINIA STATE PLANE COORDINATE SYSTEM, SOUTH ZONE, NAD 83/86

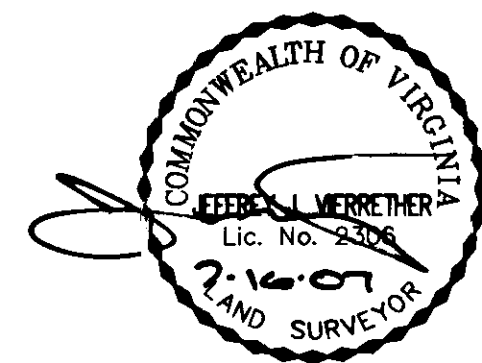

PLAT OF CORRECTION
OF
POCAHONTAS SQUARE, PHASE 2
JAMES CITY COUNTY, VIRGINIA
JULY 13, 2007

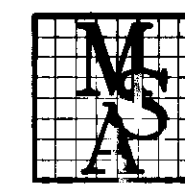

MSA, P.C.
Landscape Architecture • Planning • Surveying
Engineering • Environmental Sciences
5033 ROUSE DRIVE, VIRGINIA BEACH, VA 23462-3708
PHONE (757) 490-9264 • FAX (757) 490-0634

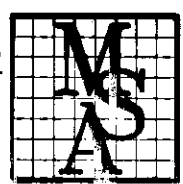

GRAPHIC SCALE
1" = 100'

JOB# 03066A
SHEET 2 OF 6

6 Large/Small Plat(s) Recorded
herewith as # 070021225

City of Williamsburg & County of James City
Circuit Court: This PLAT was recorded on
at 11:09 AM/PM, PB PG
DOCUMENT # 070021225
BETSY B. WOOLRIDGE, CLERK
Betsy B. Woolridge Clerk

SHEET INDEX

SEE SHEET 1 OF 6 FOR NOTES AND CERTIFICATES

FB CS 323, PG 25 & 32
DRWN. BY CJS
CHK'D. BY JJV DATE 07/13/07