

#060006909

STONEHOUSE
DEVELOPMENT AREA ONE
PHASE I

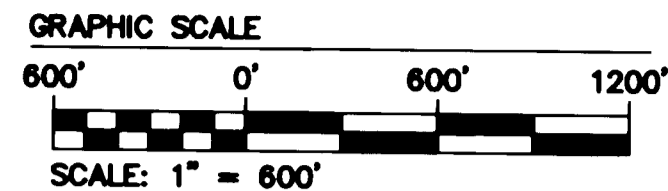

COMMON AREAS TO BE CONVEYED			
SECTION	COMMON AREA	ACRES	REFERENCE
SUMMERFIELD	CA-11 CA-12	0.1022 0.2528	PLAT BOOK 88, PAGE 57-58
FIELDSTONE PARKWAY RIGHT OF WAY	CA-43	2.4733	PLAT BOOK 90, PAGE 9-11
PORTION OF PARCEL A	BMP O.S.	1.85	DOCUMENT #030040275
STONEHOUSE COMMUNITY RECREATION CENTER	NEW CRC NEW COMMON AREA	4.637 3.386	DOCUMENT #040008042
TOTAL	8 PARCELS	12.4813	

* = COMMUNITY RECREATION CENTER

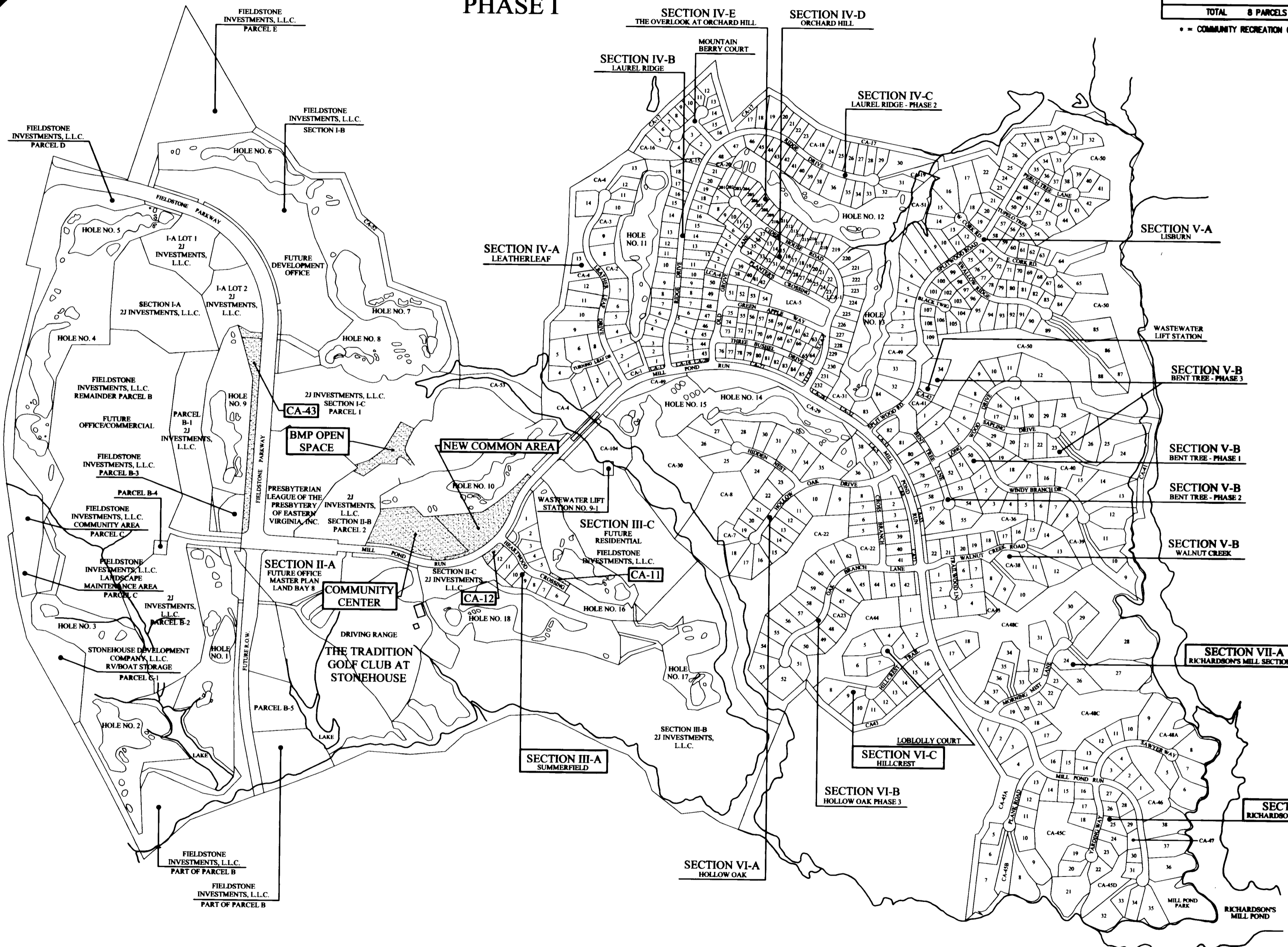
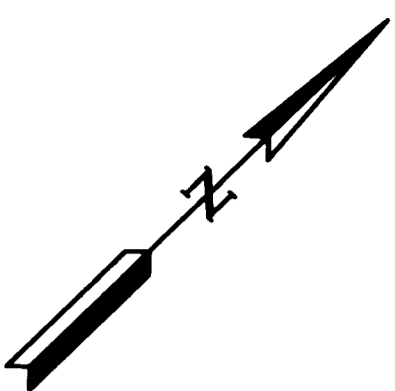

L Large/Small Plat(s) Recorded herewith as # 060006909

#060006909

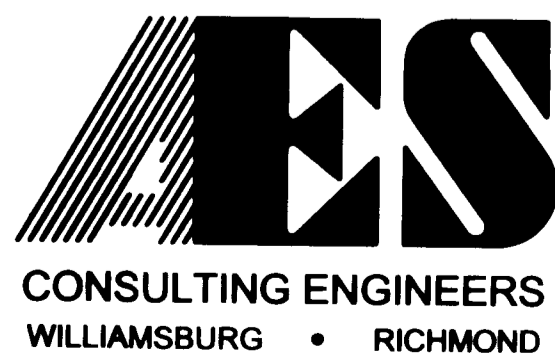

5248 Olde Towne Road, Suite 1
Williamsburg, Virginia 23188
(757) 253-0040
Fax (757) 220-8994

MAP SHOWING A PORTION OF
THE COMMON AREAS PREPARED FOR
STONEHOUSE DEVELOPMENT COMPANY, L.L.C.

STONEHOUSE

STONEHOUSE DISTRICT JAMES CITY COUNTY VIRGINIA

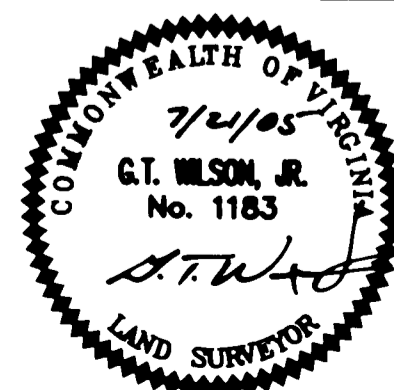

City of Williamsburg & County of James City	
Circuit Court: This PLAT was recorded on	
at 10:37 AM/PM, PB - PG -	
DOCUMENT # 060006909	
BETSY B. WOOLRIDGE, CLERK	
Betsy B. Woolridge Clerk	
1	12/05 REMOVE CA-52 AND CA-53 FROM CONVEYANCE
No.	DATE REVISION / COMMENT / NOTE
	BY

Digned AES	Drawn AWT
Scale 1" = 600'	Date 7/21/05
Project No. 9028-17	
Drawing No. 1 OF 1	