

#060006909

STONEHOUSE
DEVELOPMENT AREA ONE
PHASE I

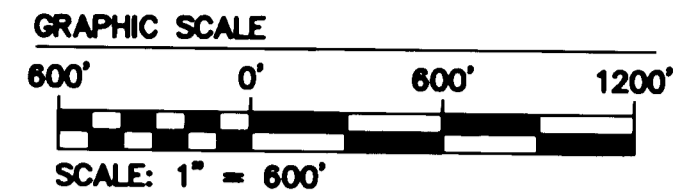

| COMMON AREAS TO BE CONVEYED | | | |
|--|----------------------------|------------------|--------------------------|
| SECTION | COMMON AREA | ACRES | REFERENCE |
| SUMMERFIELD | CA-11 CA-12 | 0.1022 0.2528 | PLAT BOOK 88, PAGE 57-58 |
| FIELDSTONE PARKWAY RIGHT OF WAY | CA-43 | 2.4733 | PLAT BOOK 90, PAGE 9-11 |
| PORTION OF PARCEL A | BMP O.S. | 1.85 | DOCUMENT #030040275 |
| STONEHOUSE COMMUNITY RECREATION CENTER | NEW CRC NEW COMMON AREA | 4.637 3.386 | DOCUMENT #040008042 |
| TOTAL | 8 PARCELS | 12.4813 | |

* = COMMUNITY RECREATION CENTER

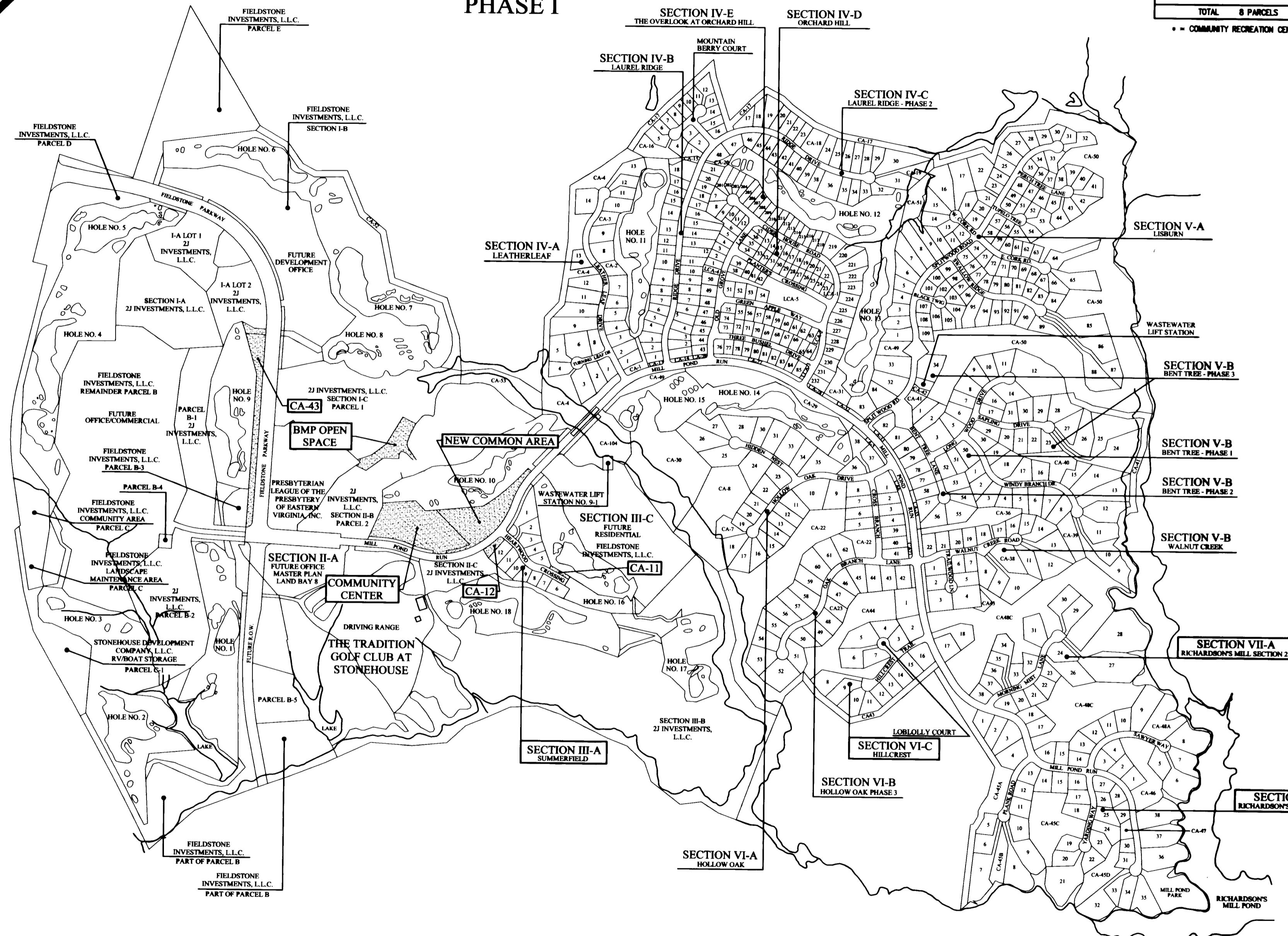
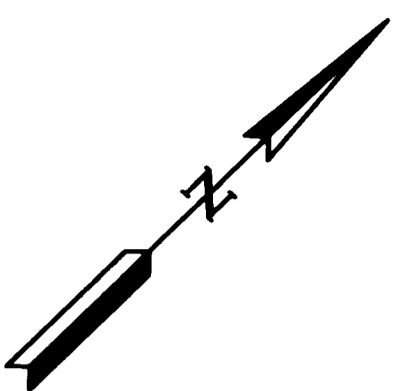

L Large/Small Plat(s) Recorded herewith as # 060006909

#060006909

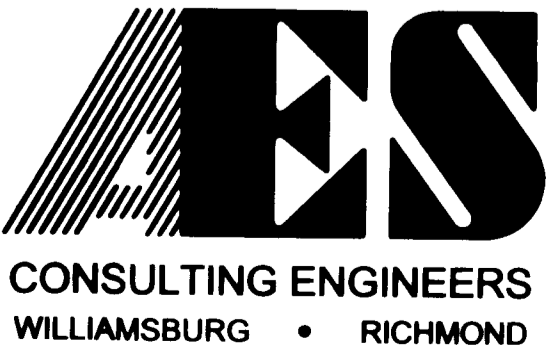

5248 Olde Towne Road, Suite 1
Williamsburg, Virginia 23188
(757) 253-0040
Fax (757) 220-8994

MAP SHOWING A PORTION OF
THE COMMON AREAS PREPARED FOR
STONEHOUSE DEVELOPMENT COMPANY, L.L.C.

STONEHOUSE

STONEHOUSE DISTRICT JAMES CITY COUNTY VIRGINIA

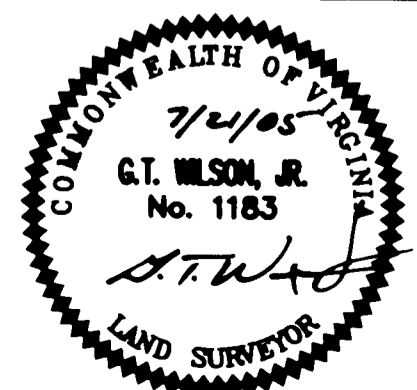

| | | | |
|-----|-------|--|-----|
| 1 | 12/05 | REMOVE CA-52 AND CA-53 FROM CONVEYANCE | VMB |
| No. | DATE | REVISION / COMMENT / NOTE | BY |

City of Williamsburg & County of James City
Circuit Court: This PLAT was recorded on
27 March 2006
at 10:37 AM/PM, PG. --
DOCUMENT # 060006909
BETSY B. WOOLRIDGE, CLERK
Betsy B. Woolridge Clerk

| | |
|------------------------|-----------------|
| Designed AES | Drawn AWT |
| Scale 1" = 600' | Date 7/21/05 |
| Project No. 9028-17 | |
| Drawing No. 1 OF 1 | |