

#060005393

Property Of:
James City County,
a political subdivision of the
Commonwealth of Virginia
Parcel ID# 3210100012

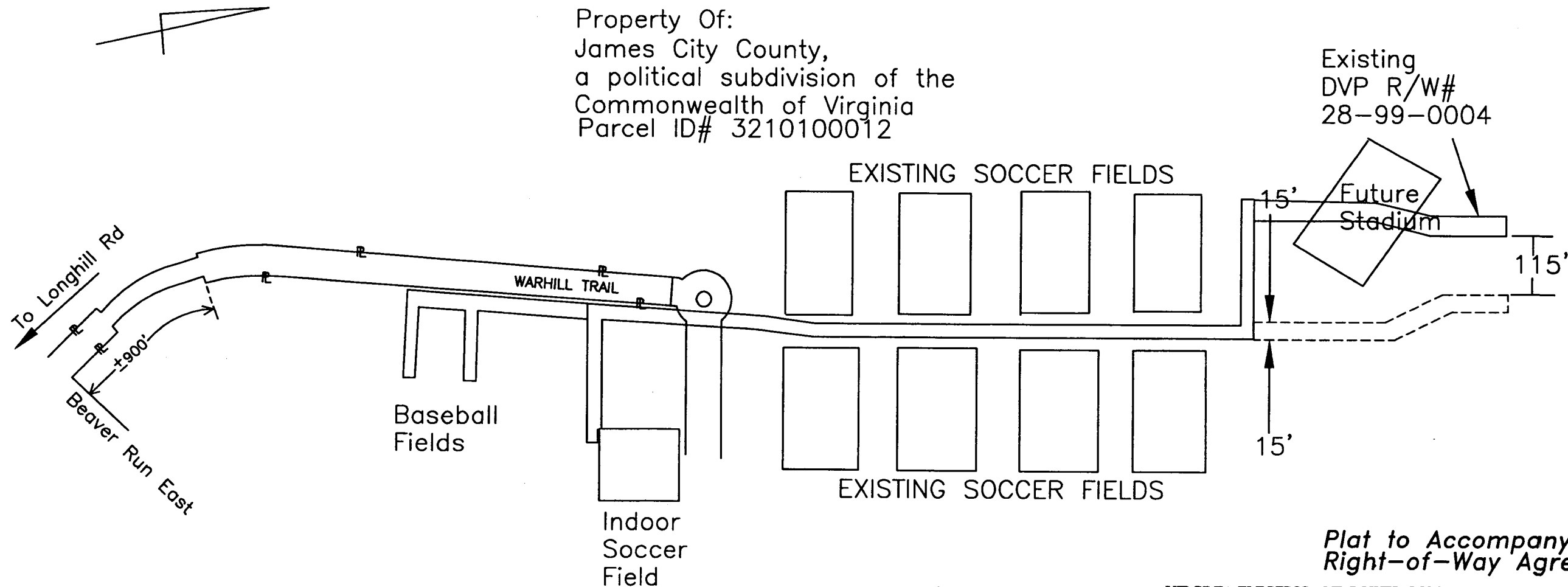

**Plat to Accompany
Right-of-Way Agreement**

VIRGINIA ELECTRIC AND POWER COMPANY		
doing business as		
Dominion Virginia Power	UNDERGROUND	
District		
WILLIAMSBURG		
District-Township-Borough	County-City	State
POWHATAN		
Office	JAMES CITY	VA
Plat Number		
PORT TECH CNTR		
Estimate Number	28-05-0058	
Grid Number		
5021600		M1739

Date 6-24-05 By D. Stephenson

City of Williamsburg & County of James City
Circuit Court: This PLAT was recorded on
10 March 2006
at 11:09 AM/PM. PB PG
DOCUMENT # 060005393
BETSY B. WOOLRIDGE, CLERK
Betsy B. Woolridge Clerk

* Location of the facilities surveyed by James City County determine the centerline of the right of way herein granted on the property of owner.

1 Large/Small Plat(s) Recorded
herewith as # 060005393

Legend

- Location of Boundary Lines of Right of Way FIFTEEN (15') FEET IN WIDTH
- |——— Indicates Property Line is Right-of-Way Boundary FIFTEEN (15') FEET IN WIDTH