

# #060000418

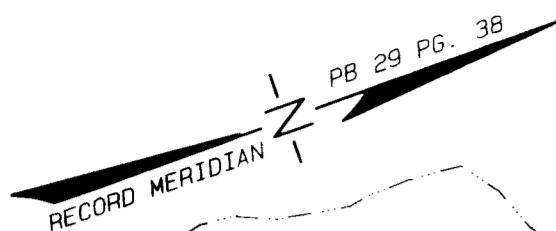

N/F  
NEWPORT NEWS  
WATERWORKS  
LITTLE CREEK RESERVIOR  
PARCEL ID # 2120100001  
1790 +/- ACRES  
DB 176 PG. 796

N/F  
JAMES CITY COUNTY  
LITTLE CREEK RESERVIOR PARK  
PARCEL ID # 2110100026  
37.55 +/- ACRES  
DB 378 PG. 436

## PLAT OF SURVEY OF PARCEL OF LAND CONTAINING 60.79 ACRES

BEING  
A PORTION OF  
THE LANDS OF THE FORMER  
JAMES R. WARREN ESTATE  
PORTION OF TRACT ALSO KNOWN AS  
"JUDGES PLACE" TRACT

PROPERTY LIES IN  
STONEHOUSE DISTRICT  
JAMES CITY COUNTY, VIRGINIA

PLAT PREPARED BY  
ANGLE & DISTANCE LAND SURVEYING, INC.  
156 OLD STAGE RD., TOANO, VA. 23168  
(757) 566-1206  
PLAT PREPARED 11-30-05

### GENERAL NOTES

- 1) TAX PARCEL (21-1) (1-25)
- 2) PROPERTY IS ZONED A1
- 3) PROPERTY APPEARS TO LIE IN FLOOD ZONE X AREA DETERMINED TO BE OUTSIDE THE 500 YR. FLOOD PLAIN AS SHOWN ON F.I.R.M. MAP # 510201-0015B, EFFECTIVE DATE FEB. 6th., 1991.
- 4) FRONTAGE RIGHT OF WAY ALONG RTE. 776 CREATED FROM BEST FIT ROAD ALIGNMENT FROM BEGINNING OF TRACT SHOWN TO END OF TRACT. HWY PLANS # 2600-S-950(I) 631-1347-05 DATED SEPT. 13, 1956.
- 5) BOUNDARY LINES TAKE FROM SURVEY BY STEPHEN STEPHENS FOR CONVEYANCE TO CITY OF NEWPORT NEWS, PB 22 PG. 38.
- 6) THIS PLAT WAS PREPARED WITHOUT THE BENEFIT OF A FURNISHED TITLE REPORT, AND DOES NOT REFLECT ALL ENCUMBRANCES, SERVITUDES AND EASEMENTS OF RECORD THAT COULD AFFECT PROPERTY SHOWN.
- 7) THIS PLAT IS BASED ON A CURRENT FIELD SURVEY.
- 8) DEED REFERENCES: DB 776 PG. 221/DB 59 PG. 163  
WB 20 PG. 718/WB 16 PG. 535

N/F  
NEWPORT NEWS  
WATERWORKS  
LITTLE CREEK RESERVIOR  
PARCEL ID # 2120100001  
1790 +/- ACRES  
DB 134 PG. 796

AREA  
60.79 +/-  
ACRES

N/F  
NEWPORT NEWS  
WATERWORKS  
LITTLE CREEK RESERVIOR  
PARCEL ID # 2120100001  
1790 +/- ACRES  
DB 134 PG. 796

N/F  
NEWPORT NEWS  
WATERWORKS  
LITTLE CREEK RESERVIOR  
PARCEL ID # 2120100001  
1790 +/- ACRES  
DB 134 PG. 776

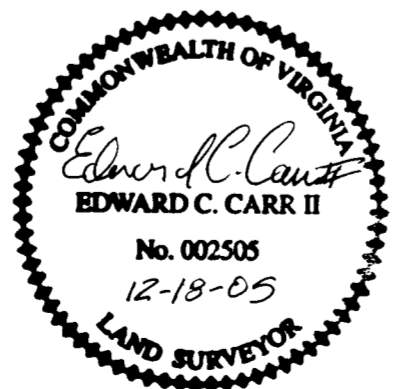

Large/Small Plat(s) Recorded  
herewith as # 060000418

City of Williamsburg & County of James City  
Circuit Court: This PLAT was recorded on  
6 January 2006  
at 1:22 AM/PM, PB 0 PG 1  
DOCUMENT # 060000418  
BETSY B. WOOLRIDGE, CLERK  
Betsy B. Woolridge Clerk

GRAPHIC SCALE 1"=200'

