

GENERAL NOTES:

1. PARCEL CONTAINS 36,354 S.F.± OR 0.835 ACRES±
2. PROPERTY SHOWN HEREON IS ALL OF TAX MAP PARCEL #(10-3)(1-1).
3. PROPERTY ADDRESS IS #8395 DIASCUND ROAD.
4. PROPERTY IS CURRENTLY ZONED "A-1".
5. PROPERTY SHOWN HEREON LIES IN ZONE "X", AREA DETERMINED TO BE OUTSIDE THE 500-YEAR FLOODPLAIN PER F.I.R.M. #510201-005-B, DATED FEBRUARY 6, 1991.

REFERENCES:

- INSTRUMENT #040030294
- DEED BOOK 138, PAGE 497 (C & P EASEMENT)
- DEED BOOK 36A, PAGE 459 (V.E.P.CO. EASEMENT)
- DEED BOOK 155, PAGE 212 ST. HWY. PLAT BOOK 5, PAGES 229-230
- DEED BOOK 347, PAGE 768
- INSTRUMENT #980010238
- PLAT BOOK 69, PAGE 57

TAX MAP PARCEL
#(10-1)(1-40)
NOW OR FORMERLY
WISE A. SKILLMAN, III
D.B. 347, PG. 768
INSTR. #980010238
P.B. 69, PG. 57

TAX MAP PARCEL
#(10-3)(1-2)
NOW OR FORMERLY
WISE A. SKILLMAN, III
D.B. 347, PG. 768
INSTR. #980010238
P.B. 69, PG. 57

NOW OR FORMERLY
C & O RAILROAD
"DIASCUND STATION"
P.B. 2, PG. 7
P.B. 4, PG. 261

PARCEL AREA =
36,354 S.F.± OR
0.835 ACRES±

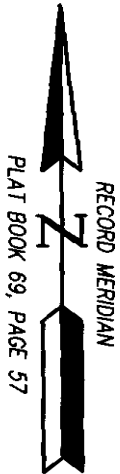

303

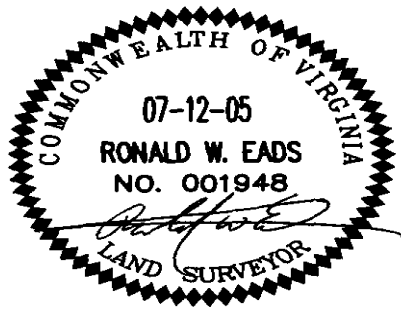

ES CONSULTING ENGINEERS
WILLIAMSBURG • RICHMOND

5248 Olde Towne Road, Suite 1
Williamsburg, Virginia 23188
(757) 253-0040 Fax (757) 220-8994

PLAT OF SURVEY
A PARCEL CONTAINING 0.835 ACRES±
FOR CONVEYANCE TO ANON K. WYATT, NORMA L. WYATT AND KAREN D. FULLER
FROM PAMAKA, LLC, A VIRGINIA LIMITED LIABILITY COMPANY
STONEHOUSE DISTRICT JAMES CITY COUNTY VIRGINIA

Scale: 1" = 100' Ref: INSTR. #040030294 Date: 07/12/05 Job No: 07/12/05