

**GENERAL NOTES:**

1. PARCEL CONTAINS 36,354 S.F.± OR 0.835 ACRES±
2. PROPERTY SHOWN HEREON IS ALL OF TAX MAP PARCEL #(10-3)(1-1).
3. PROPERTY ADDRESS IS #8395 DIASCUND ROAD.
4. PROPERTY IS CURRENTLY ZONED "A-1".
5. PROPERTY SHOWN HEREON LIES IN ZONE "X", AREA DETERMINED TO BE OUTSIDE THE 500-YEAR FLOODPLAIN PER F.I.R.M. #510201-005-B, DATED FEBRUARY 6, 1991.

**REFERENCES:**

- INSTRUMENT #040030294
- DEED BOOK 138, PAGE 497
- (C & P EASEMENT)
- DEED BOOK 36A, PAGE 459
- (V.E.P.CO. EASEMENT)
- DEED BOOK 155, PAGE 212
- ST. HWY. PLAT BOOK 5, PAGES 229-230
- DEED BOOK 347, PAGE 768
- INSTRUMENT #980010238
- PLAT BOOK 69, PAGE 57

TAX MAP PARCEL  
 #(10-1)(1-40)  
 NOW OR FORMERLY  
 WISE A. SKILLMAN, III  
 D.B. 347, PG. 768  
 INSTR. #980010238  
 P.B. 69, PG. 57

TAX MAP PARCEL  
 #(10-3)(1-2)  
 NOW OR FORMERLY  
 WISE A. SKILLMAN, III  
 D.B. 347, PG. 768  
 INSTR. #980010238  
 P.B. 69, PG. 57

NOW OR FORMERLY  
 C & O RAILROAD  
 "DIASCUND STATION"  
 P.B. 2, PG. 7  
 P.B. 4, PG. 261

PARCEL AREA =  
 36,354 S.F.± OR  
 0.835 ACRES±

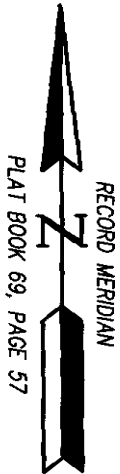

303

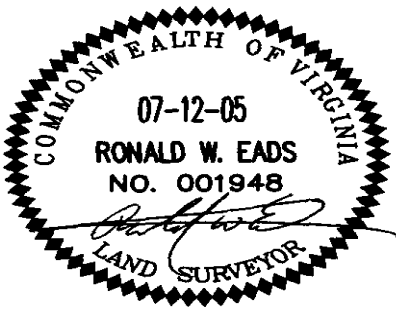

**ES** CONSULTING ENGINEERS  
 WILLIAMSBURG • RICHMOND

5248 Olde Towne Road, Suite 1  
 Williamsburg, Virginia 23188  
 (757) 253-0040 Fax (757) 220-8994

**PLAT OF SURVEY**  
 A PARCEL CONTAINING 0.835 ACRES±  
 FOR CONVEYANCE TO ANON K. WYATT, NORMA L. WYATT AND KAREN D. FULLER  
 FROM PAMAKA, LLC, A VIRGINIA LIMITED LIABILITY COMPANY  
 STONEHOUSE DISTRICT JAMES CITY COUNTY VIRGINIA

Scale: 1" = 100'    Ref: INSTR. #040030294    Date: 07/12/05    Job No: 07/12/05