

# 040032114

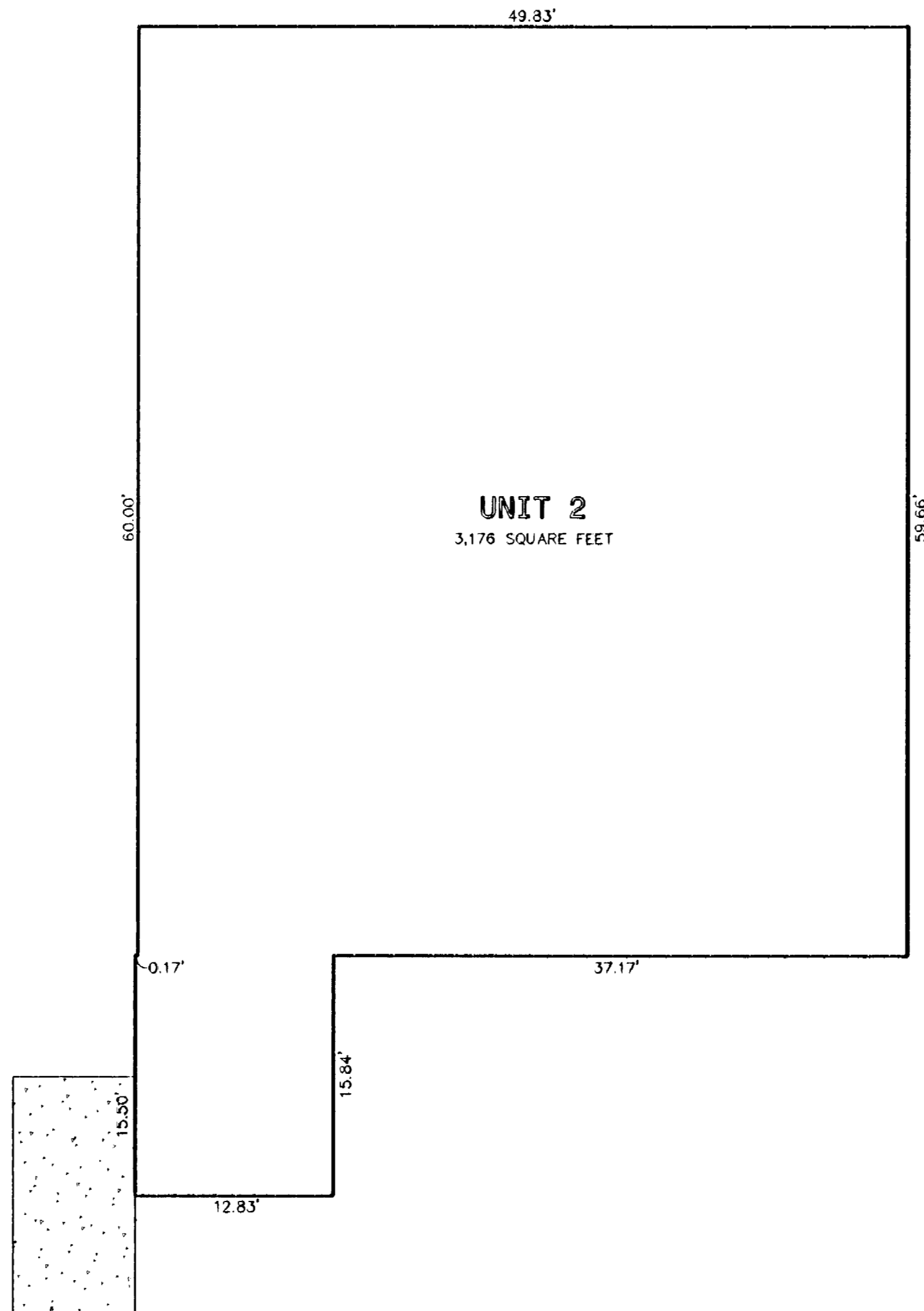

**QUARTERLAND COMMONS X**  
 351 McLAWS CIRCLE , A CONDOMINIUM  
 ROBERTS DISTRICT , JAMES CITY COUNTY , VIRGINIA

**QUARTERLAND COMMONS X**

SCALE : 1" = 8'-0" DECEMBER 20, 2004  
 SHEET NO. 1 OF 1

**LEGEND**

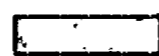
 CONCRETE PORCH L.C.E.  
 L.C.E. DENOTES LIMITED COMMON ELEMENT

**DAVID F. BUGIN, ARCHITECTS**  
 ARCHITECTURE AND PLANNING  
 POST OFFICE BOX 1804  
 NEWPORT NEWS  
 VIRGINIA  
 23601

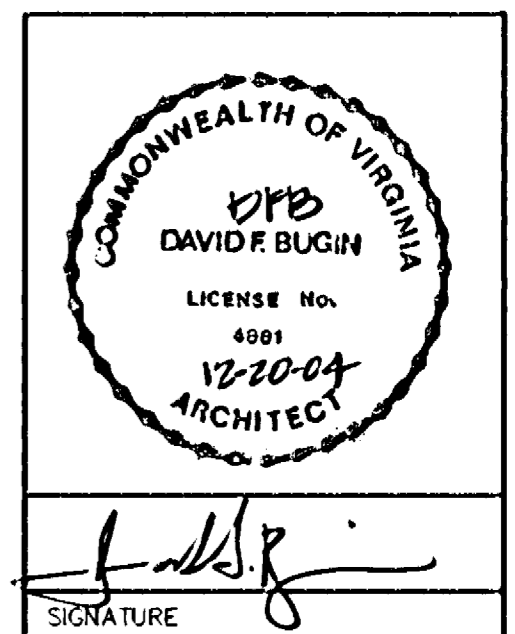

I CERTIFY THAT THIS PLAT IS ACCURATE AND COMPLIES WITH THE PROVISIONS OF SECTION 55-79.58(b) OF THE CODE OF VIRGINIA 1950 AS AMENDED AND THAT UNITS 1 AND 3 AS DEPICTED HEREON HAVE BEEN SUBSTANTIALLY COMPLETED.

City of Williamsburg & County of James City  
 Circuit Court: This PLAT was recorded on  
 at 10:51 AM on 12-27-2004 PG  
 DOCUMENT # 040032114  
 BETSY B. WOOLRIDGE, CLERK  
*Betsy B. Woolridge* Clerk