

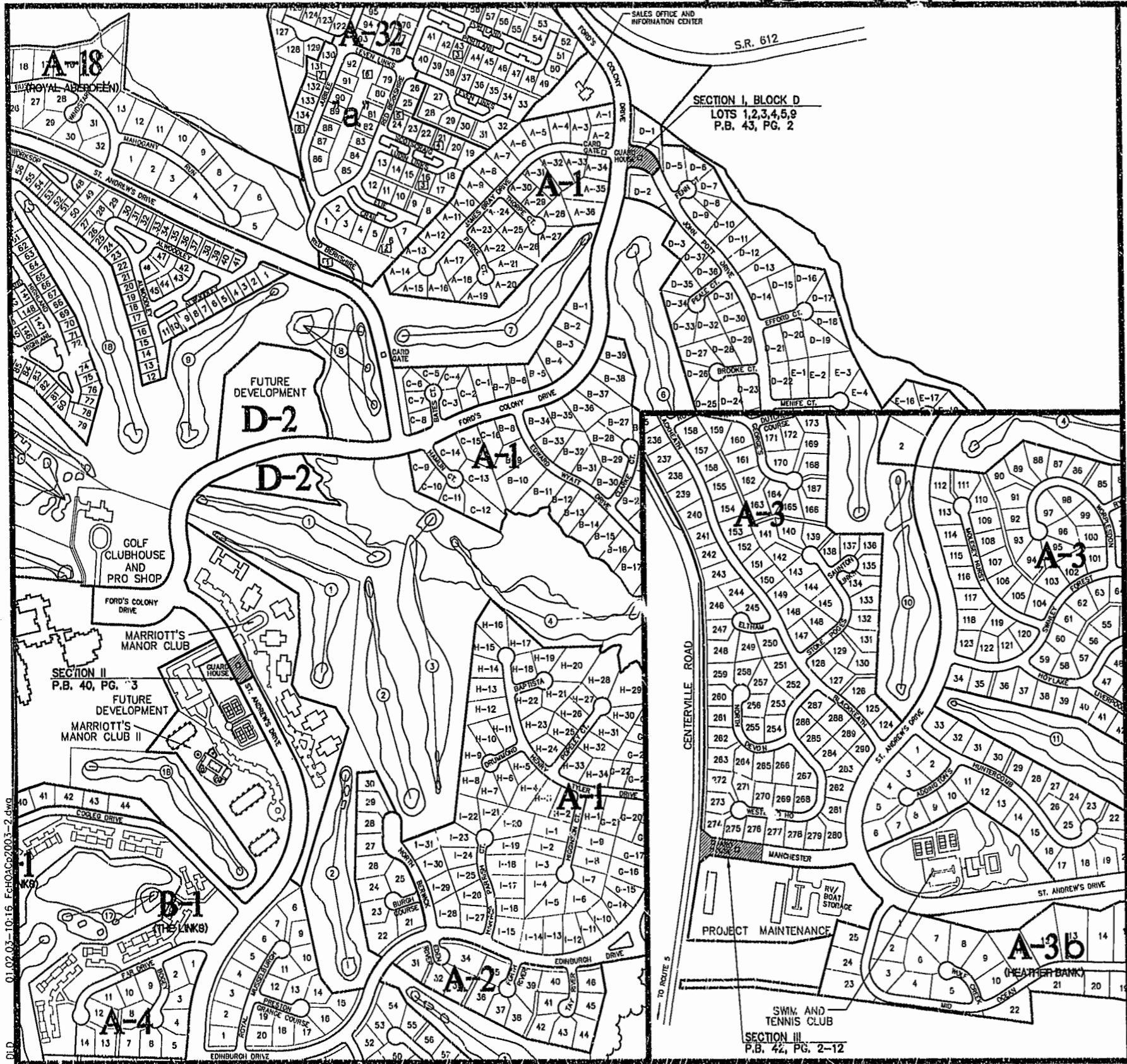

# 030005477

89 PAGE 55



NOTE:  
 REALTEC INCORPORATED AND/OR THEIR ASSIGNS HEREBY RESERVE EASEMENT OVER, UNDER AND THROUGH ALL THE LANDS OF THE FORD'S COLONY AT WILLIAMSBURG HOMEOWNERS ASSOCIATION SHOWN HEREON THAT MAY BE NECESSARY FROM TIME TO TIME TO EFFECT FURTHER DEVELOPMENT OF THE PROPERTY AND THE INSTALLATION OF SIGNAGE AND LANDSCAPING. FURTHERMORE, THE AFORESAID RESERVE THE RIGHT WITHIN SAID HOMEOWNERS' LANDS TO CONSTRUCT AND MAINTAIN ACCESSORY AMENITY BUILDINGS. SUCH PROPERTY IS ALSO SUBJECT TO THE EASEMENTS, RIGHTS AND LIMITATIONS DESCRIBED IN THE DECLARATION OF PROTECTIVE COVENANTS FOR FORD'S COLONY OR IN SUPPLEMENTS

EXISTING PLATTED EASEMENTS FOR UTILITIES AND DRAINAGE OVER THE LANDS OF THE FORD'S COLONY AT WILLIAMSBURG HOMEOWNERS' ASSOCIATION SHOWN HEREON ARE NOT SHOWN FOR PURPOSES OF CLARITY, REFERENCE IS HEREBY MADE TO THE LAND RECORDS OF JAMES CITY COUNTY FOR MORE EXACT INFORMATION RELATING TO EASEMENT LOCATIONS AND USE.

AREA TABULATION OF THE LANDS OF THE FORD'S COLONY AT WILLIAMSBURG HOMEOWNERS ASSOCIATION

SECTION I	WHERE RECORDED	DESCRIPTION	AREA
SECTION I, BLOCK D RESUBDIVISION OF LOTS 1-5, 9	P.B. 43, PG. 2	RIGHT-OF-WAY	0.470 AC.±
SECTION II	WHERE RECORDED	DESCRIPTION	AREA
SECTION II ST. ANDREWS DRIVE	P.B. 40, PG. 63	RIGHT-OF-WAY	0.340 AC.±
SECTION III	WHERE RECORDED	DESCRIPTION	AREA
SECTION III LOT 251 TO LOT 290, MAINTENANCE CENTER	P.B. 42, PG. 2-12	RIGHT-OF-WAY	0.900 AC.±



LEGEND

	GREENWAY AREA
	ROAD RIGHT-OF-WAYS
	INDICATES GREENWAY

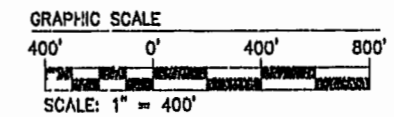

01.02.03-10-16 F:\C:\Cp\2003-2.dwg



5248 Olde Towne Road, Suite 1  
 Williamsburg, Virginia 23188  
 (757) 253-0040  
 Fax (757) 220-8994

MAP OF ADDITIONAL LANDS OF  
**THE FORD'S COLONY**  
 AT WILLIAMSBURG  
 HOMEOWNERS ASSOCIATION

POWhatan DISTRICT    JAMES CITY COUNTY    VIRGINIA



City of Williamsburg & County of James City	
Circuit Court:	This PLAT was recorded on
Feb. 21, 2003	
at 9:49 AM P.M. PB 87 PG 54-55	
DOCUMENT # 030005477	
BETSY B. WOOLRIDGE, CLERK	
<i>Betsy Woolridge</i> Clerk	
No. DATE	REVISION / COMMENT / NOTE
	BY

Designed CBR	Drawn DLD
Scale 1"=400'	Date 1/2/03
Project No. 5652-96	
Drawing No. 2 OF 2	