

NOTE: REALTEC INCORPORATED AND/OR THEIR ASSIGNS HEREBY RESERVE EASEMENT OVER, UNDER AND THROUGH ALL THE LANDS OF THE FORD'S COLONY AT WILLIAMSBURG HOMEOWNERS ASSOCIATION SHOWN HEREON THAT MAY BE NECESSARY FROM TIME TO TIME TO EFFECT FURTHER DEVELOPMENT OF THE PROPERTY AND THE INSTALLATION OF SIGNAGE AND LANDSCAPING. FURTHERMORE, THE AFORESAID RESERVED THE RIGHT WITHIN SAID HOMEOWNERS' LANDS TO CONSTRUCT AND MAINTAIN ACCESSORY AMENITY BUILDINGS. SUCH PROPERTY IS ALSO SUBJECT TO THE EASEMENTS, RIGHTS AND LIMITATIONS DESCRIBED IN THE DECLARATION OF PROTECTIVE COVENANTS FOR FORD'S COLONY OR IN SUPPLEMENTS EXISTING PLATTED EASEMENTS FOR UTILITIES AND DRAINAGE OVER THE LANDS OF THE FORD'S COLONY AT WILLIAMSBURG HOMEOWNERS ASSOCIATION SHOWN HEREON ARE NOT SHOWN FOR PURPOSES OF CLARITY, REFERENCE IS HEREBY MADE TO THE LAND RECORDS OF JAMES CITY COUNTY FOR MORE EXACT INFORMATION RELATING TO EASEMENT LOCATIONS AND USE.

AREA TABULATION OF THE LANDS OF THE FORD'S COLONY AT WILLIAMSBURG HOMEOWNERS ASSOCIATION

SECTION	WHERE RECORDED	DESCRIPTION	AREA
SECTION VII			
SECTION VII			
LOTS 1-172	P.B. 50, PG. 31-40		
NOTE: GREENWAY AND ROAD RIGHT-OF-WAY RECORDED ON P.B. 53, PG 49 - DB. 548 PG. 295. HATCH LEFT OFF OF GREENWAY BETWEEN LOT 43 & 44. HATCH ON THIS PLAT JUST INDICATES GREENWAY LOCATION.			
SECTION IX			
SECTION IX-B			
LOTS 58-111	P.B. 53, PG. 11-13	GREENWAYS	3.469 AC.±
SECTION XIII			
SECTION XIII-A			
LOTS 1-41	P.B. 68, PG. 77-79	ROAD RIGHT-OF-WAY	3.808 AC.±
LOTS 1-41	P.B. 68, PG. 77-79	GREENWAYS	1.303 AC.±
SECTION XIII-B			
LOTS 1-62	P.B. 67, PG. 61-63		
NOTE: GREENWAY AND ROAD RIGHT-OF-WAY RECORDED ON P.B. 76, PG 79 - DOC. #00000. HATCH LEFT OFF OF GREENWAY BETWEEN LOT 31 & 32. HATCH ON THIS PLAT JUST INDICATES GREENWAY LOCATION.			
SECTION XIII-C			
LOTS 1-34	P.B. 56, PG. 81-82	ROAD RIGHT-OF-WAY	0.415 AC.±
SECTION XIV			
SECTION XIV-B			
LOTS 1-56	P.B. 71, PG. 15-16	ROAD RIGHT-OF-WAY	5.039 AC.±
LOTS 1-56	P.B. 71, PG. 15-16	GREENWAYS	1.818 AC.±

SUMMARY OF PREVIOUS PLATS OF THE FORD'S COLONY AT WILLIAMSBURG HOMEOWNERS ASSOCIATION

SECTION	WHERE RECORDED	DESCRIPTION	AREA
SECTION 1, 2, 4, 5	P.B. 46, PG. 79	D.B. 386, PG. 564	
SECTION 3	P.B. 48, PG. 98	D.B. 395, PG. 787	
SECTION 6, LOTS 1-117	P.B. 52, PG. 39	D.R. 477, PG. 35	
SECTION 10	P.B. 52, PG. 38	D.B. 477, PG. 35	
SECTION 6, LOTS 118-265;	P.B. 53, PG. 80	D.B. 504, PG. 124	
SECTION 11A, LOTS 70-156			
SECTION 11A, LOTS 1-69	P.B. 54, PG. 67	D.B. 529, PG. 74	
SECTION 7	P.B. 55, PG. 49	D.B. 548, PG. 299	
SECTION 9A	P.B. 68, PG. 75-76	DOC. #980004672	
SECTION 9B	P.B. 58, PG. 43	D.B. 847, PG. 395	
SECTION 13B	P.B. 76, PG. 79	DOC. #00000	
SECTION 13C, D, E	P.B. 81, PG. 56	D.B. 734, PG. 740	
SECTION 13C	P.B. 68, PG. 75-76	DOC. #980004672	
SECTION 16, LOTS 7-84	P.B. 68, PG. 75-76	DOC. #980004672	
SECTION 11B, LOTS 1-25	P.B. 76, PG. 51-52	DOC. #000002031	
SECTION XVII, LOTS 1-46	P.B. 76, PG. 51-52	DOC. #000002031	
SECTION XVII, LOTS 48-71	P.B. 76, PG. 51-52	DOC. #000002031	
SECTION XVII, LOTS 1-32	P.B. 76, PG. 51-52	DOC. #000002031	

TOTAL AREA OF ROAD RIGHT-OF-WAYS (AS SUMMARIZED AT P.B. 76, PG. 79)	255.40 AC.±
TOTAL AREA OF GREENWAYS (AS SUMMARIZED AT P.B. 76, PG. 79)	74.48 AC.±
AREA OF GREENWAYS CORRECTION DUE TO MISCALCULATION ON 12/31/98 MAP OF ADDITIONAL LANDS (DOC# 980004672)	0.49 AC.±
TOTAL AREA OF THE LANDS OF THE FORD'S COLONY AT WILLIAMSBURG HOMEOWNERS ASSOCIATION	330.43 AC.±
TOTAL AREA TO DATE SUMMARY OF THE LANDS OF THE FORD'S COLONY AT WILLIAMSBURG HOMEOWNERS ASSOCIATION (INCLUDES ALL PREVIOUS PLATS)	
TOTAL AREA OF ROAD RIGHT-OF-WAYS	303.29 AC.±
TOTAL AREA OF GREENWAYS	114.32 AC.±
TOTAL AREA OF THE LANDS OF THE FORD'S COLONY AT WILLIAMSBURG HOMEOWNERS ASSOCIATION	417.61 AC.±

02.19.02-17.11.FCH04Co2001-1.dwg

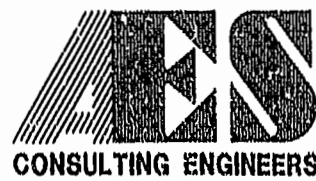

5248 Olde Towne Road, Suite 1  
Williamsburg, Virginia 23188  
(757) 253-0040  
Fax (757) 220-8994

MAP OF ADDITIONAL LANDS OF THE FORD'S COLONY AT WILLIAMSBURG HOMEOWNERS ASSOCIATION

POWhatan DISTRICT JAMES CITY COUNTY VIRGINIA



City of Williamsburg & County of James City	
Circuit Court: This PLAT was recorded on	12 Nov 2002
at 3:56 AM PM:TB 88 PG 40-42	
DOCUMENT #	020026590
BETSY B. WOOLRIDGE, CLERK	
Christina Adams, Dep. Clerk	
No. DATE	REVISION / COMMENT / NOTE
	BY

Designed	CJR/LBA	Drawn	DLD/LBA
Scale	1" = 400'	Date	2/20/02
Project No.	5662-96	Drawing No.	1 OF 3

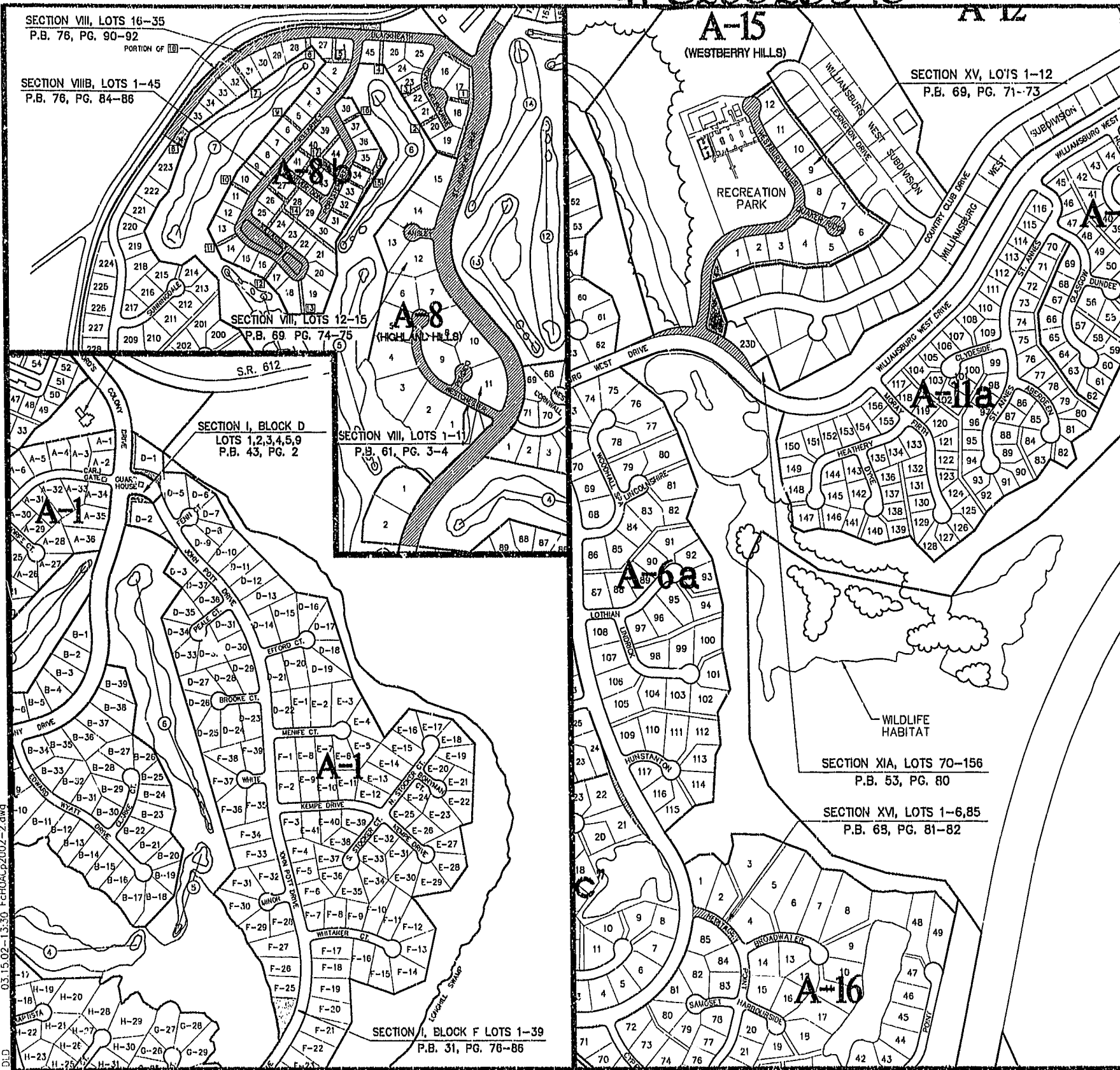

NOTE: REALTEC INCORPORATED AND/OR THEIR ASSIGNS HEREBY RESERVE EASEMENT OVER, UNDER AND THROUGH ALL THE LANDS OF THE FORD'S COLONY AT WILLIAMSBURG HOMEOWNERS ASSOCIATION SHOWN HEREON THAT MAY BE NECESSARY FROM TIME TO TIME TO EFFECT FURTHER DEVELOPMENT OF THE PROPERTY AND THE INSTALLATION OF SIGNAGE AND LANDSCAPING. FURTHERMORE, THE AFOREMENTIONED RESERVE THE RIGHT WITHIN SAID HOMEOWNERS' LANDS TO CONSTRUCT AND MAINTAIN ACCESSORY AMENITY BUILDINGS. SUCH PROPERTY IS ALSO SUBJECT TO THE EASEMENTS, RIGHTS AND LIMITATIONS DESCRIBED IN THE DECLARATION OF PROTECTIVE COVENANTS FOR FORD'S COLONY OR IN SUPPLEMENTS

EXISTING PLATTED EASEMENTS FOR UTILITIES AND DRAINAGE OVER THE LANDS OF THE FORD'S COLONY AT WILLIAMSBURG HOMEOWNERS' ASSOCIATION SHOWN HEREON ARE NOT SHOWN FOR PURPOSES OF CLARITY, REFERENCE IS HEREBY MADE TO THE LAND RECORDS OF JAMES CITY COUNTY FOR MORE EXACT INFORMATION RELATING TO EASEMENT LOCATIONS AND USE.

AREA TABULATION OF THE LANDS OF THE FORD'S COLONY AT WILLIAMSBURG HOMEOWNERS' ASSOCIATION

SECTION	WHERE RECORDED	DESCRIPTION	AREA
<b>SECTION I</b>			
<b>SECTION I, BLOCK D</b>			
LOTS 1,2,3,4,5,9	P.B. 43, PG. 2	GREENWAY	0.426 AC.±
<b>SECTION I, BLOCK F</b>			
LOTS 1-39	P.B. 31, PG. 76-86	GREENWAY	0.350 AC.±
<b>SECTION VIII</b>			
<b>SECTION VIII</b>			
LOTS 1-11	P.B. 61, PG. 3-4	ROAD RIGHT-OF-WAY	1.776 AC.±
LOTS 12-15	P.B. 69, PG. 74-75	ROAD RIGHT-OF-WAY	5.655 AC.±
LOTS 16-35	P.B. 76, PG. 90-92	ROAD RIGHT-OF-WAY	2.814 AC.±
LOTS 16-35	P.B. 76, PG. 90-92	GREENWAYS	*2.079 AC.±
* EXCLUDES A PORTION OF GREENWAY 18 (0.720 AC.), ADJACENT TO GOLF MAINTENANCE AND BLACKHEATH.			
<b>SECTION VIII-B</b>			
LOTS 1-45	P.B. 76, PG. 84-86	ROAD RIGHT-OF-WAY	4.053 AC.±
LOTS 1-45	P.B. 76, PG. 84-86	GREENWAYS	1.669 AC.±
<b>SECTION XI</b>			
<b>SECTION XI-A</b>			
LOTS 70-155	P.B. 53, PG. 80	GREENWAY (18)	
* GREENWAY 18 (4.670 AC.) WAS PREVIOUSLY CONVEYED IN SECTION XI-A "MAP OF ADDITIONAL LANDS". AREA HAS BEEN REDUCED BY (0.27 AC.) & (0.567 AC.) FOR ADDITIONAL R/W FOR SECTION XV AND SUBDIVISION OF NEW LOT 23D AT THE TERMINUS OF COUNTRY CLUB DRIVE, RESPECTFULLY. REDUCTION IN GREENWAY 18 = -0.857 AC.±			
<b>SECTION XV</b>			
<b>SECTION XV</b>			
LOTS 1-12	P.B. 69, PG. 71-73	ROAD RIGHT-OF-WAY	*2.830 AC.±
LOTS 1-12	P.B. 69, PG. 71-73	GREENWAYS	**1.427 AC.±
* R/W AREA FOR SECTION XV INCLUDES (0.27 AC.) PREVIOUSLY CONVEYED AS GREENWAY WITH SECTION XI-A "MAP OF ADDITIONAL LANDS".			
** GREENWAY AREA FOR SECTION XV DECREASED BY (0.091 AC.) FROM REL. RD PLAT WITH DUE TO SUBDIVISION OF NEW LOT 23D, AT THE TERMINUS OF COUNTRY CLUB DRIVE.			
<b>SECTION XVI</b>			
<b>SECTION XVI</b>			
LOTS 1-6,85	P.B. 68, PG. 81-82	ROAD RIGHT-OF-WAY	0.331 AC.±

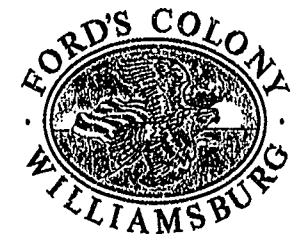

LEGEND

	GREENWAY AREA
	ROAD RIGHT-OF-WAYS
	INDICATES GREENWAY

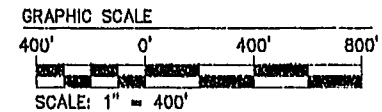

03.15.02-13.30 FcHOAcP2002-2.dwg

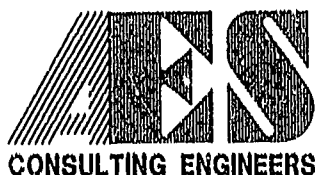

5248 Olde Towne Road, Suite 1  
Williamsburg, Virginia 23188  
(757) 253-0040  
Fax (757) 220-8994

MAP OF ADDITIONAL LANDS OF  
**THE FORD'S COLONY**  
AT WILLIAMSBURG  
HOMEOWNERS ASSOCIATION

POW-HATAN DISTRICT JAMES CITY COUNTY VIRGINIA



No.	DATE	REVISION / COMMENT / NOTE	BY
		City of Williamsburg & County of James City Circuit Court: This PLAT was recorded on 12/21/02 at 8:56 AM/PM: PB 87 PG 82-82 DOCUMENT # 020026590 BETSY B. WOOLRIDGE, CLERK	
		CLAUDE A. WILSON, JR., Dep. Clerk	

Designed CBR/LBA	Drawn DLD/LBA
Scale	Date
1"=400'	2/20/02
Project No.	
5652-96	
Drawing No.	
2 OF 3	

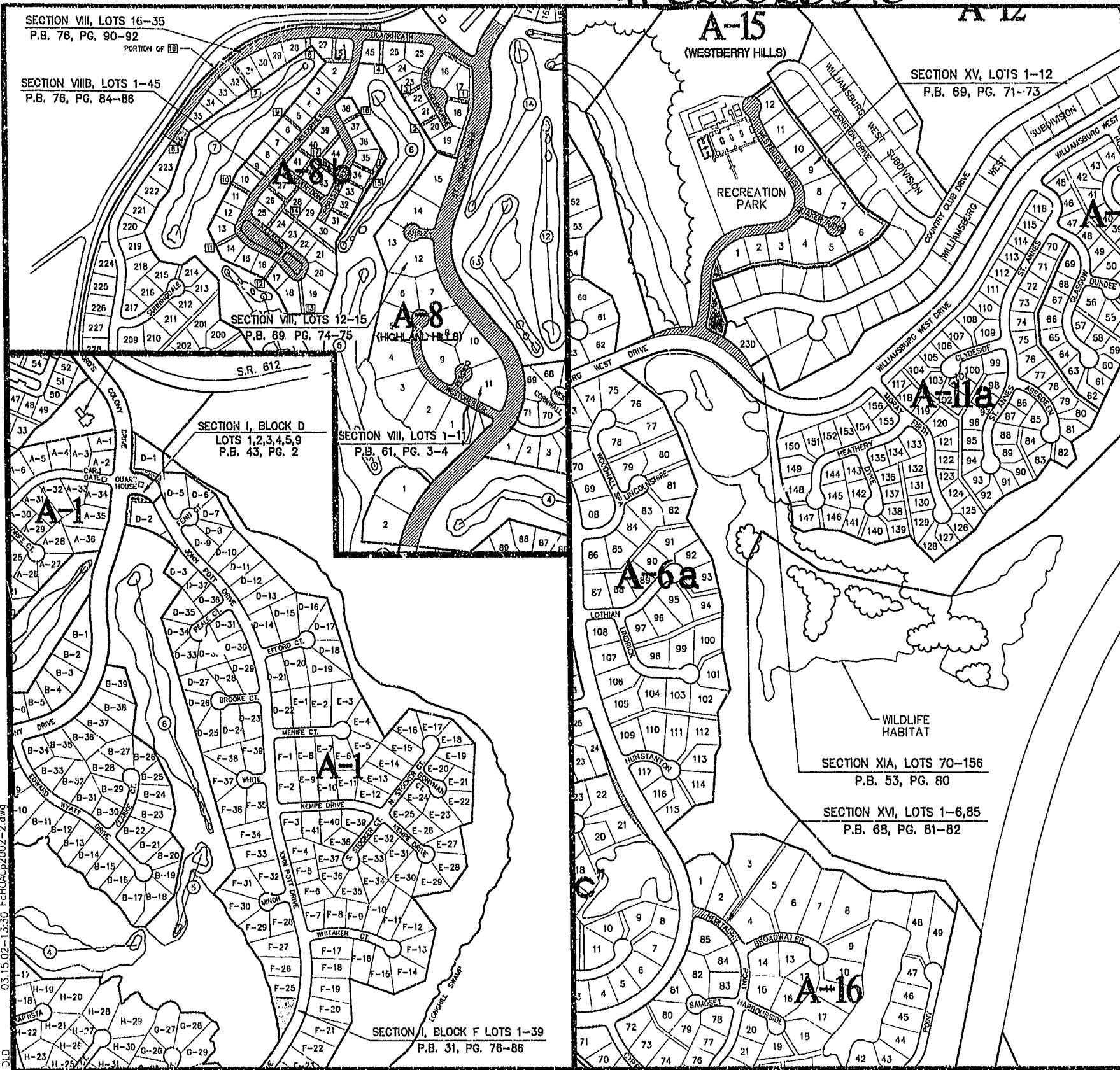

NOTE: REALTEC INCORPORATED AND/OR THEIR ASSIGNS HEREBY RESERVE EASEMENT OVER, UNDER AND THROUGH ALL THE LANDS OF THE FORD'S COLONY AT WILLIAMSBURG HOMEOWNERS ASSOCIATION SHOWN HEREON THAT MAY BE NECESSARY FROM TIME TO TIME TO EFFECT FURTHER DEVELOPMENT OF THE PROPERTY AND THE INSTALLATION OF SIGNAGE AND LANDSCAPING. FURTHERMORE, THE AFOREMENTIONED RESERVE THE RIGHT WITHIN SAID HOMEOWNERS' LANDS TO CONSTRUCT AND MAINTAIN ACCESSORY AMENITY BUILDINGS. SUCH PROPERTY IS ALSO SUBJECT TO THE EASEMENTS, RIGHTS AND LIMITATIONS DESCRIBED IN THE DECLARATION OF PROTECTIVE COVENANTS FOR FORD'S COLONY OR IN SUPPLEMENTS

EXISTING PLATTED EASEMENTS FOR UTILITIES AND DRAINAGE OVER THE LANDS OF THE FORD'S COLONY AT WILLIAMSBURG HOMEOWNERS' ASSOCIATION SHOWN HEREON ARE NOT SHOWN FOR PURPOSES OF CLARITY, REFERENCE IS HEREBY MADE TO THE LAND RECORDS OF JAMES CITY COUNTY FOR MORE EXACT INFORMATION RELATING TO EASEMENT LOCATIONS AND USE.

AREA TABULATION OF THE LANDS OF THE FORD'S COLONY AT WILLIAMSBURG HOMEOWNERS' ASSOCIATION

SECTION	WHERE RECORDED	DESCRIPTION	AREA
<b>SECTION I</b>			
<b>SECTION I, BLOCK D</b>			
LOTS 1,2,3,4,5,9	P.B. 43, PG. 2	GREENWAY	0.426 AC.±
<b>SECTION I, BLOCK F</b>			
LOTS 1-39	P.B. 31, PG. 76-86	GREENWAY	0.350 AC.±
<b>SECTION VIII</b>			
<b>SECTION VIII</b>			
LOTS 1-11	P.B. 61, PG. 3-4	ROAD RIGHT-OF-WAY	1.776 AC.±
LOTS 12-15	P.B. 69, PG. 74-75	ROAD RIGHT-OF-WAY	5.655 AC.±
LOTS 16-35	P.B. 76, PG. 90-92	ROAD RIGHT-OF-WAY	2.814 AC.±
LOTS 16-35	P.B. 76, PG. 90-92	GREENWAYS	*2.079 AC.±
* EXCLUDES A PORTION OF GREENWAY 18 (0.720 AC.), ADJACENT TO GOLF MAINTENANCE AND BLACKHEATH.			
<b>SECTION VIII-B</b>			
LOTS 1-45	P.B. 76, PG. 84-86	ROAD RIGHT-OF-WAY	4.053 AC.±
LOTS 1-45	P.B. 76, PG. 84-86	GREENWAYS	1.669 AC.±
<b>SECTION XI</b>			
<b>SECTION XI-A</b>			
LOTS 70-155	P.B. 53, PG. 80	GREENWAY (18)	
* GREENWAY 18 (4.670 AC.) WAS PREVIOUSLY CONVEYED IN SECTION XI-A "MAP OF ADDITIONAL LANDS". AREA HAS BEEN REDUCED BY (0.27 AC.) & (0.567 AC.) FOR ADDITIONAL R/W FOR SECTION XV AND SUBDIVISION OF NEW LOT 23D AT THE TERMINUS OF COUNTRY CLUB DRIVE, RESPECTFULLY. REDUCTION IN GREENWAY 18 = -0.857 AC.±			
<b>SECTION XV</b>			
<b>SECTION XV</b>			
LOTS 1-12	P.B. 69, PG. 71-73	ROAD RIGHT-OF-WAY	*2.830 AC.±
LOTS 1-12	P.B. 69, PG. 71-73	GREENWAYS	**1.427 AC.±
* R/W AREA FOR SECTION XV INCLUDES (0.27 AC.) PREVIOUSLY CONVEYED AS GREENWAY WITH SECTION XI-A "MAP OF ADDITIONAL LANDS".			
** GREENWAY AREA FOR SECTION XV DECREASED BY (0.091 AC.) FROM REL. RD PLAT WITH DUE TO SUBDIVISION OF NEW LOT 23D, AT THE TERMINUS OF COUNTRY CLUB DRIVE.			
<b>SECTION XVI</b>			
<b>SECTION XVI</b>			
LOTS 1-6,85	P.B. 68, PG. 81-82	ROAD RIGHT-OF-WAY	0.331 AC.±

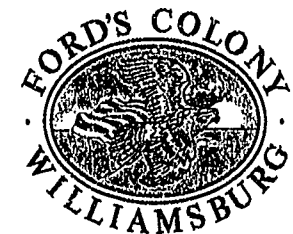

LEGEND

	GREENWAY AREA
	ROAD RIGHT-OF-WAYS
	INDICATES GREENWAY

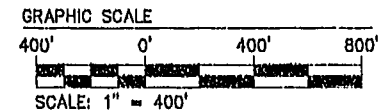

03.15.02-13.30 FcHOAcP2002-2.dwg

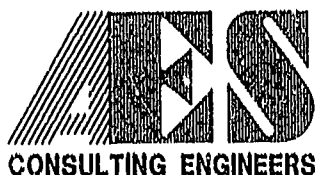

5248 Olde Towne Road, Suite 1  
Williamsburg, Virginia 23188  
(757) 253-0040  
Fax (757) 220-8994

MAP OF ADDITIONAL LANDS OF  
**THE FORD'S COLONY**  
AT WILLIAMSBURG  
HOMEOWNERS ASSOCIATION

POW-HATAN DISTRICT JAMES CITY COUNTY VIRGINIA



City of Williamsburg & County of James City	
Circuit Court:	This PLAT was recorded on
	12/21/02
at	8:56 AM/PM: PB 87 PAGE 42
DOCUMENT #	020026590
BETSY B. WOOLRIDGE, CLERK	
	Dep. Clerk
No. DATE	REVISION / COMMENT / NOTE
	BY

Designed	Drawn
CBR/LBA	DLD/LBA
Scale	Date
1"=400'	2/20/02
Project No.	
5652-96	
Drawing No.	
2 OF 3	